



Western Michigan University
ScholarWorks at WMU

Legacy Scout Tickets from Pure Oil Company

8-20-2021

MGRRE_PureOilScoutTickets_EMERY, SADIE_1_21057166640000

MGRRE

Western Michigan University

Follow this and additional works at: <https://scholarworks.wmich.edu/pure>



Part of the Geology Commons

WMU ScholarWorks Citation

MGRRE, "MGRRE_PureOilScoutTickets_EMERY, SADIE_1_21057166640000" (2021). *Legacy Scout Tickets from Pure Oil Company*. 2673.

<https://scholarworks.wmich.edu/pure/2673>

This Document is brought to you for free and open access via ScholarWorks at WMU. It has been accepted for inclusion in Legacy Scout Tickets from Pure Oil Company by an authorized administrator of ScholarWorks at WMU. See the National Digital Catalogue - Science Base Catalogue for more collections submitted by MGRRE.



MGRRE_PureOilScoutTickets_EMERY, SADIE_1_21057166640000

API 21057166640000

Permit Number 16664

Lease Name EMERY, SADIE

Well Number 1

County Gratiot

Township 12N

Range 1W

Section 32

2021 DEQ or Pure co_name HENRY W W AND SCHILLER IRWIN L

Pure Number 305

Latitude 43.39257

Longitude -84.46053

WELL REPORT - OUTSIDE OPERATIONS

SERIAL NO. 305

STATE Michigan ^{ESLK} CO. Gratiot
 OPERATOR W. W. Henry & Irwin O. Schiller
 FARM Sadie Emery WELL NO. 1
 TWP. Wheeler S. 32 T. 12N R. 1W
 SURVEY
 LOC. NE NE NW

WILDCAT FIELD FIELD NAME _____

MAP NO. _____ CO-ORD. _____ ELEV. _____

STATUS Material on Ground

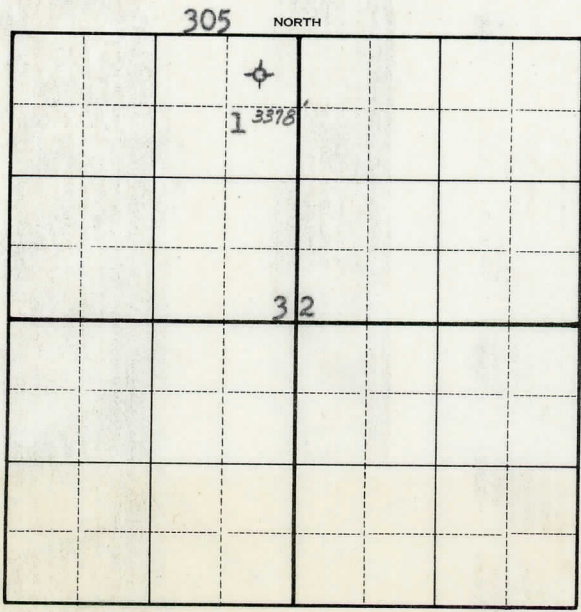

DATE 2-19-51 SCOUT H. J. G.