



Western Michigan University
ScholarWorks at WMU

Legacy Scout Tickets from Pure Oil Company

8-20-2021

MGRRE_PureOilScoutTickets_CARY, ROSCO_1_21057181050000

MGRRE

Western Michigan University

Follow this and additional works at: <https://scholarworks.wmich.edu/pure>



Part of the Geology Commons

WMU ScholarWorks Citation

MGRRE, "MGRRE_PureOilScoutTickets_CARY, ROSCO_1_21057181050000" (2021). *Legacy Scout Tickets from Pure Oil Company*. 2682.

<https://scholarworks.wmich.edu/pure/2682>

This Document is brought to you for free and open access via ScholarWorks at WMU. It has been accepted for inclusion in Legacy Scout Tickets from Pure Oil Company by an authorized administrator of ScholarWorks at WMU. See the National Digital Catalogue - Science Base Catalogue for more collections submitted by MGRRE.



MGRRE_PureOilScoutTickets_CARY, ROSCO_1_21057181050000

API 21057181050000

Permit Number 18105

Lease Name CARY, ROSCO

Well Number 1

County Gratiot

Township 11N

Range 4W

Section 10

2021 DEQ or Pure co_name HARTMAN I W

Pure Number 314

Latitude 43.35098

Longitude -84.76753

WELL REPORT - OUTSIDE OPERATIONS

SERIAL NO. 314

STATE Michigan ~~INDEX~~ Gratiot
CO.

OPERATOR I.W. Hartman

FARM Rosco Cary WELL NO. 1

TWP. ~~INDEX~~ Summer S. 10 T. 11N R. 4 W

LOC. SE SE SE

WILDCAT FIELD FIELD NAME _____

MAP NO. _____ CO-ORD. _____ ELEV. _____

STATUS R.U. Rot.

(Traverse 2900')

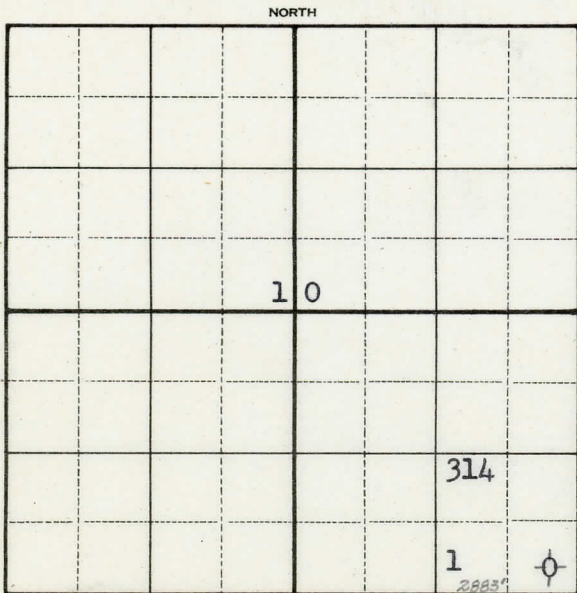

DATE 2-17-53 SCOUT JEC