



Western Michigan University
ScholarWorks at WMU

Legacy Scout Tickets from Pure Oil Company

8-20-2021

MGRRE_PureOilScoutTickets_Citizens Bank_1_21063083240000

MGRRE

Western Michigan University

Follow this and additional works at: <https://scholarworks.wmich.edu/pure>



Part of the Geology Commons

WMU ScholarWorks Citation

MGRRE, "MGRRE_PureOilScoutTickets_Citizens Bank_1_21063083240000" (2021). *Legacy Scout Tickets from Pure Oil Company*. 2753.

<https://scholarworks.wmich.edu/pure/2753>

This Document is brought to you for free and open access via ScholarWorks at WMU. It has been accepted for inclusion in Legacy Scout Tickets from Pure Oil Company by an authorized administrator of ScholarWorks at WMU. See the National Digital Catalogue - Science Base Catalogue for more collections submitted by MGRRE.



MGRRE_PureOilScoutTickets_Citizens Bank_1_21063083240000

API 21063083240000

Permit Number 8324

Lease Name Citizens Bank

Well Number 1

County Huron

Township 15N

Range 14E

Section 14

2021 DEQ or Pure co_name Fortney Oil Company

Pure Number 107

Latitude 43.73516

Longitude 43.73516

DATE December 31, 1940

LOCATION REPORT

No. 107

COMPLETION RECORD OF WELLS BY OTHER OPERATORS

STATE Michigan COUNTY Huron DIST. Paris TWP. Paris SEC. 14 TOWN 15 N RANGE 14 E
WELL No. 1 (SERIAL No. 107) FARM Citizens Bank

NAME OF STREAM OR WATERS QUADRANGLE NE 1/4 SE 3E

OPERATOR Fortney Oil Company Map Paris Township, Huron County

330 330 Feet from North Line of Farm

330 330 " " East " " "

" " South " " "

" " West " " "

330 330 Feet from North Line of Section

330 330 " " East " " "

" " South " " "

" " West " " "

Low

Paris - Huron

LEGEND

- LOCATION
- ⊕ RIG
- ⊕ DRILLING
- ☀ GAS WELL
- OIL WELL
- SMALL OIL WELL
- ⊙ DRY HOLE
- ⊙ DRY SHOWING OIL
- ⊙ DRY SHOWING GAS
- ⊙ ABANDONED LOCATION
- ☀ ABANDONED GAS WELL
- ABANDONED OIL WELL

NOTE: Below make tracing from map. (when no map is obtainable make sketch) showing farm, center of section, this location with measurements and also wells, dry holes, or other locations in the vicinity of this location.

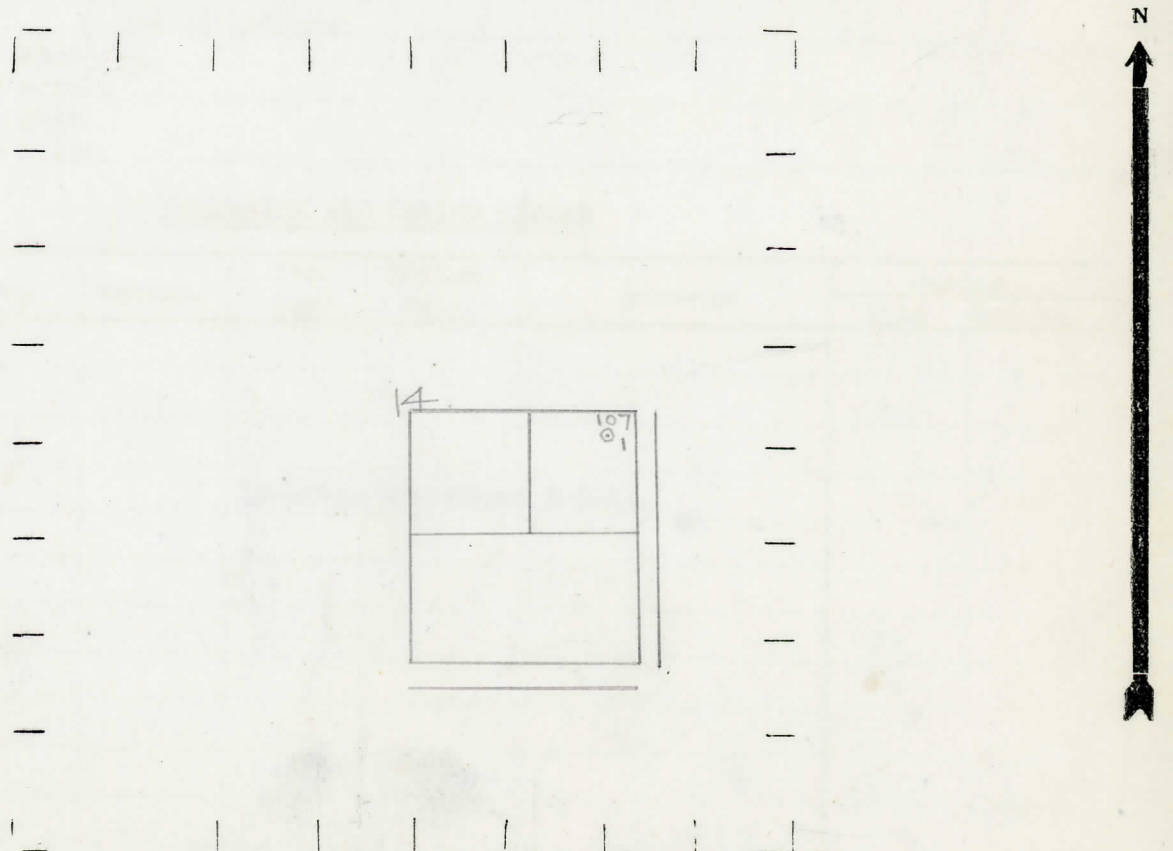

REMARKS:

SIGNED

W

Superintendent or Foreman.

