



Western Michigan University
ScholarWorks at WMU

Legacy Scout Tickets from Pure Oil Company

8-20-2021

MGRRE_PureOilScoutTickets_Rink, Theodore_1_21063105100000

MGRRE

Western Michigan University

Follow this and additional works at: <https://scholarworks.wmich.edu/pure>



Part of the Geology Commons

WMU ScholarWorks Citation

MGRRE, "MGRRE_PureOilScoutTickets_Rink, Theodore_1_21063105100000" (2021). *Legacy Scout Tickets from Pure Oil Company*. 2760.

<https://scholarworks.wmich.edu/pure/2760>

This Document is brought to you for free and open access via ScholarWorks at WMU. It has been accepted for inclusion in Legacy Scout Tickets from Pure Oil Company by an authorized administrator of ScholarWorks at WMU. See the National Digital Catalogue - Science Base Catalogue for more collections submitted by MGRRE.



MGRRE_PureOilScoutTickets_Rink, Theodore_1_21063105100000

API 21063105100000

Permit Number 10510

Lease Name Rink, Theodore

Well Number 1

County Huron

Township 17N

Range 14E

Section 24

2021 DEQ or Pure co_name Sinclair Wyoming Oil Company

Pure Number 114

Latitude 43.89743

Longitude -82.77995

THE PURE OIL COMPANY

LOCATION REPORT

Date November 24, 1943 A.F.E. No. _____

Division Michigan Producing District _____ Lease Theodore Rink

Acres _____ Lease No. _____ Elevation _____ Well No. 1 (Serial No. 114)

Quadrangle NE-SW-NW Sec. 24 Twp. 17 N Rge. 14 E ~~XBKK~~ ~~XDSC~~ Bloomfield

Survey _____ County Huron State Michigan

Operator Sinclair Wyoming Oil Co. Map Bloomfield Township, Huron County

_____ Feet from North Line of Lease

_____ " " East " " "

990 990 " " South " " "

990 990 " " West " " "

_____ Feet from North Line of Section

_____ " " East " " "

990 990 " " South " 1/4 "

990 990 " " West " " "

LEGEND

○ Location

☀ Gas Well

● Oil Well

☀ Gas - Distillate Well

○ or ○ Dry Hole

● Dry Showing Oil

☀ Dry Showing Gas

⊗ Abandoned Location

☀ or ☀ Abandoned Gas Well

● or ● Abandoned Oil Well

⊗ or ⊗ Input Well

Low

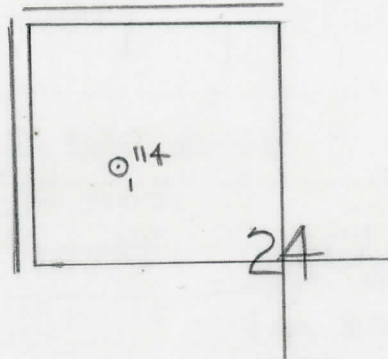

Scale _____

Remarks: _____

Submitted by RN Civil Engineer Approved by _____ Division Manager

Approved by _____ Vice-President - General Manager

COMPLETION RECORD OF WELLS DRILLED BY OTHER OPERATORS

Michigan Producing Division

Date April 19, 1944 No. 114
 State Mich. County Huron District Bloomfield Sec. 24 Twp. 17 N Rge. 14 E
 Well No. 1 (Serial No.) 114 Farm Theodore Rink Acres _____
 Operator Sinclair-Wyoming Oil Co. Information secured from Scouting Department
 Date well started 1-6-44 Date well completed 3-30-44 Elevation 715.2

PRODUCTION BOARD

Dry Hole
 1st 24 hours natural _____
 2nd 24 hours natural _____
 Date of shot _____ No. of quarts _____ From _____ to _____ From _____ to _____
 Date of acid _____ No. of gallons _____
 1st 24 hours after acid shot _____
 2nd 24 hours after acid shot _____

FORMATION AND CASING RECORD

Formation	Top	Bottom	Top Pay	Bottom Pay	Remarks	Casing	
						Size	Set at
Drift	0	75			H.F.W. 58-100.	14"	110
Berea	793	SLM.			1/2 ba. S.W. per hr. at 810.	10"	1020 Out
Antrim	1090	SLM				10"	1041
Base Antrim		1293 ?				8"	2208 Out
Traverse Lime	1346	SLM				8"	2247 "
Dundee	1997	CTM			See remarks below.	8"	2317
Detroit River	2345	"			1500 ft. S.W. from 2414-2429; oil stain 2400-2414; Salt water 2668-2725; Small show oil 2657-2670; Poison gas 2882-2900.	6"	2642
Total Depth		3378					

Remarks H.F.S.W. 2185-2195; 2210; 2252; Very very small show oil and gas from 2323 to 2336. 795' CTM equals 795' SLM; 1040' CTM equals 1041' SLM; 2208' CTM equals 2206' SLM; 2251' CTM equals 2247' SLM; 2643' CTM equals 2642' SLM.

Signed D. C. Shackelford