



Western Michigan University
ScholarWorks at WMU

Legacy Scout Tickets from Pure Oil Company

8-20-2021

**MGRRE_PureOilScoutTickets_Watchowski,
Valentine_1_21063117570000**

MGRRE
Western Michigan University

Follow this and additional works at: <https://scholarworks.wmich.edu/pure>



Part of the Geology Commons

WMU ScholarWorks Citation

MGRRE, "MGRRE_PureOilScoutTickets_Watchowski, Valentine_1_21063117570000" (2021). *Legacy Scout Tickets from Pure Oil Company*. 2771.
<https://scholarworks.wmich.edu/pure/2771>

This Document is brought to you for free and open access via ScholarWorks at WMU. It has been accepted for inclusion in Legacy Scout Tickets from Pure Oil Company by an authorized administrator of ScholarWorks at WMU. See the National Digital Catalogue - Science Base Catalogue for more collections submitted by MGRRE.



MGRRE_PureOilScoutTickets_Watchowski, Valentine_1_21063117570000

API 21063117570000

Permit Number 11757

Lease Name Watchowski, Valentine

Well Number 1

County Huron

Township 18N

Range 13E

Section 21

2021 DEQ or Pure co_name Teater, C, W.

Pure Number 162

Latitude 43.97405

Longitude -82.94887

THE PURE OIL COMPANY

LOCATION REPORT

Date August 20, 1945

A.F.E. No. _____

Division Mich. Producing

District _____

Lease Valentine Watchowski

Acres _____

Lease No. _____

Well No. 1 (Serial No. 162)

Quadrangle S 1/2 NE SE

Sec. 21 Twp. 18 N Rge. 13 E

Well No. 1 (Serial No. 162) DWIGHT

Survey _____

County Huron

State Michigan

Operator Charles W. Teater

Map Dwight Township, Huron County

990	990	Feet from North Line of Lease			
660	660	" " East " " "			
		" " South " " "			
		" " West " " "	1/4		
990	990	Feet from North Line of Section			
660	660	" " East " " "			
		" " South " " "			
		" " West " " "			

LEGEND

- Location
- ☀ Gas Well
- Oil Well
- ☀ Gas - Distillate Well
- or ○ Dry Hole
- Dry Showing Oil
- ☀ Dry Showing Gas
- ⊗ Abandoned Location
- ☀ or ☀ Abandoned Gas Well
- or ● Abandoned Oil Well
- or ○ Input Well

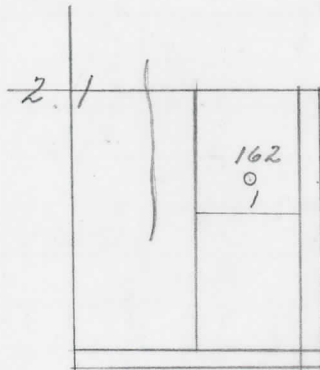

Scale _____

Remarks: _____

Submitted by _____ Civil Engineer

Approved by _____ Division Manager

Approved by _____ Vice-President - General Manager

COMPLETION RECORD OF WELLS DRILLED BY OTHER OPERATORS

Michigan Producing Division

Date October 3, 1945 No. 162
 State Michigan Co. Huron Dist. Dwight Sec. 21 Twp. 18 N Rge. 13 E
 Well No. 1 Serial No. 162 Farm Valentine Watchowski Acres _____
 Operator Charles W. Teater
 Date started 8-15-45 Date completed 9-26-45 Elevation 696.0

PRODUCTION RECORD

1st 24 hours natural
 Date of shot _____ No. of quarts _____ From _____ To _____ From _____ to _____
 Date of acid _____ shot _____ No. of gallons _____
 1st 24 hours after acid _____
 Completed as: Oil Well _____ Gas Well _____ Dry Hole X

FORMATION AND CASING RECORD

Formation	Top	Bottom	Top Pay	Bottom Pay	Remarks	Casing	
						Size	Set at
Marshall	80	127	(+616)		H.F.W. 460-500.	10"	68
Sunbury	950	(-254)			(+236)	8-1/4"	184
Berea	1078	(-382)			H.F.S.W. 1085.	6-5/8"	1201
Antrim	1370	CTM.	(-674)		(-389)	5-3/16"	2850
Traverse Lime	1636	(-940)					
Dundee	2310	SOM.	(-614)		H.F.S.W. 2485;	(-1789)	
Detroit River	?				Show S.W. 2895-2901.	(-2199)	
					2 ba. S.W./Hr. 2923-2927.	(-2227)	
Total Depth		2940	(-2244)				

Remarks 1434' equals 1442' SOM; 2308' equals 2310' SOM.

Signed D. C. Shackelford