



Western Michigan University
ScholarWorks at WMU

Legacy Scout Tickets from Pure Oil Company

8-20-2021

MGRRE_PureOilScoutTickets_Schmidt, L._1_unk

MGRRE

Western Michigan University

Follow this and additional works at: <https://scholarworks.wmich.edu/pure>



Part of the Geology Commons

WMU ScholarWorks Citation

MGRRE, "MGRRE_PureOilScoutTickets_Schmidt, L._1_unk" (2021). *Legacy Scout Tickets from Pure Oil Company*. 2781.

<https://scholarworks.wmich.edu/pure/2781>

This Document is brought to you for free and open access via ScholarWorks at WMU. It has been accepted for inclusion in Legacy Scout Tickets from Pure Oil Company by an authorized administrator of ScholarWorks at WMU. See the National Digital Catalogue - Science Base Catalogue for more collections submitted by MGRRE.



MGRRE_PureOilScoutTickets_Schmidt, L._1_unk

API unk

Permit Number unk

Lease Name Schmidt, L.

Well Number 1

County Ingham

Township 03N

Range 02E

Section 12

2021 DEQ or Pure co_name Frank Chapman

Pure Number 6

Latitude 42.6651672

Longitude -84.1590155

THE PURE OIL COMPANY

DATE February 5, 1934 COMPLETION & LOCATION REPORT No. 6

STATE Michigan COUNTY Ingham DIST. TWP. LeRoy SEC. 12 TOWN 3 N RANGE 2 E

WELL No. 1 (SERIAL No. 6) FARM L. Schmidt (Water Well) ACRES

NAME OF STREAM OR WATERS QUADRANGLE C-N $\frac{1}{2}$ of S $\frac{1}{2}$ of NW $\frac{1}{4}$

OPERATOR Drilled by F. Chapman MAP LeRoy Township, Ingham County

----- Feet from North Line of Farm

----- " " East " " "

----- " " South " " "

----- " " West " " "

1750 Feet from North Line of Section

----- " " East " " "

----- " " South " " "

1320 " " West " " "

LEGEND

- LOCATION
- ⊙ RIG
- ⊕ DRILLING
- ⊛ GAS WELL
- OIL WELL
- ⊖ SMALL OIL WELL
- ⊛ DRY HOLE
- ⊕ DRY SHOWING OIL
- ⊛ DRY SHOWING GAS
- ⊖ ABANDONED LOCATION
- ⊛ ABANDONED GAS WELL
- ⊖ ABANDONED OIL WELL

NOTE: Below make tracing from map, (when no map is obtainable make sketch) showing farm, center of section, this location with measurements and also wells, dry holes, or other locations in the vicinity of this location. Make copy to keep for reference and send original to Columbus office.

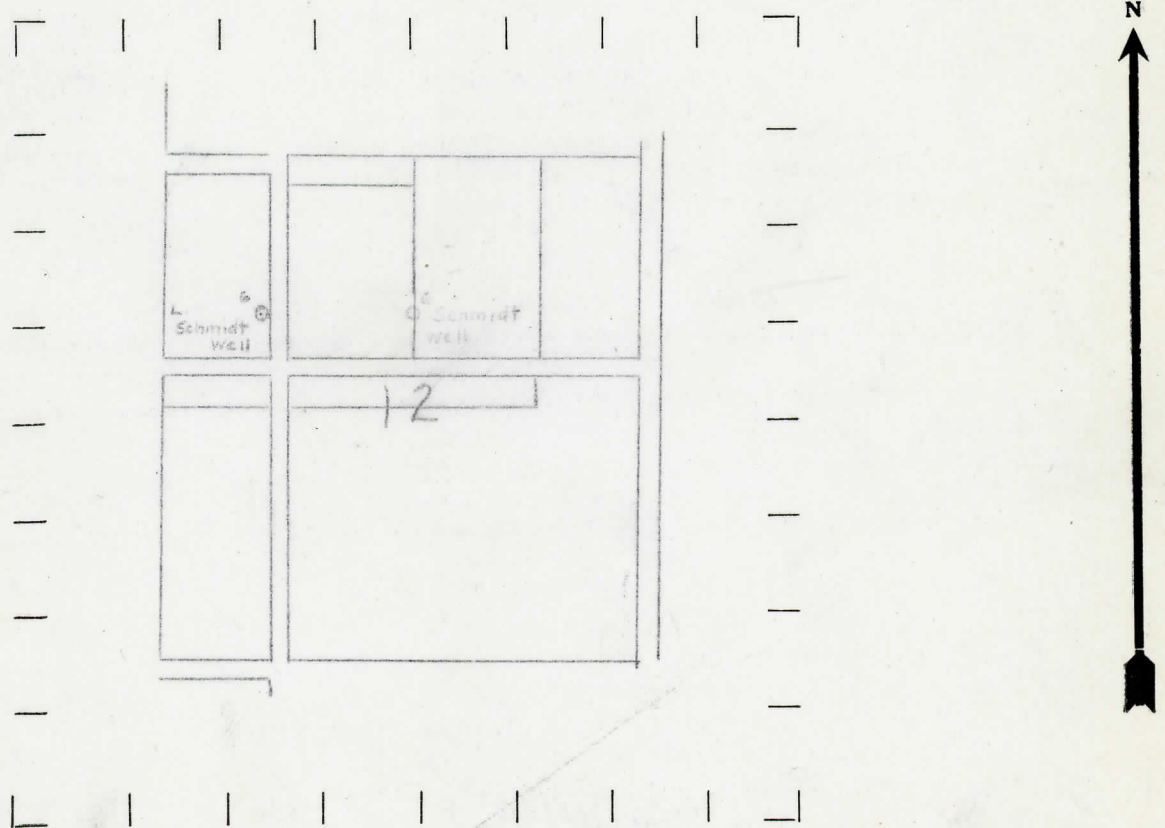

REMARKS: Of Geological Importance Drift - 55'
Marshall - 90'

SIGNED

 Superintendent or Foreman.