



Western Michigan University
ScholarWorks at WMU

Legacy Scout Tickets from Pure Oil Company

8-20-2021

MGRRE_PureOilScoutTickets_Creyton Estate_1_21067107570000

MGRRE

Western Michigan University

Follow this and additional works at: <https://scholarworks.wmich.edu/pure>



Part of the Geology Commons

WMU ScholarWorks Citation

MGRRE, "MGRRE_PureOilScoutTickets_Creyton Estate_1_21067107570000" (2021). *Legacy Scout Tickets from Pure Oil Company*. 2808.

<https://scholarworks.wmich.edu/pure/2808>

This Document is brought to you for free and open access via ScholarWorks at WMU. It has been accepted for inclusion in Legacy Scout Tickets from Pure Oil Company by an authorized administrator of ScholarWorks at WMU. See the National Digital Catalogue - Science Base Catalogue for more collections submitted by MGRRE.



MGRRE_PureOilScoutTickets_Creyton Estate_1_21067107570000

API 21067107570000

Permit Number 10757

Lease Name Creyton Estate

Well Number 1

County Ionia

Township 05N

Range 06W

Section 4

2021 DEQ or Pure co_name Schrauben, Herman J.

Pure Number 20

Latitude 42.85108

Longitude -85.03309

THE PURE OIL COMPANY

LOCATION REPORT

Date May 10, 1944

A.F.E. No. _____

Division Mich. Producing

District _____ Lease _____

Creyton Est.
Creyton Estate

Acres _____ Lease No. _____ Elevation _____ Well No. 1 (Serial No. 20)

Quadrangle SW-SW-NW Sec. 4 Twp. 5 N Rge. 6 W Twp. Sebewa
SW SW NW 4 5 N 6 W Sebewa

Survey _____ County Ionia State Michigan

Operator Herman J. Schrauben Map Sebewa Township, Ionia County

Feet from North Line of Lease

330	330	"	"	East	"	"	"
330	330	"	"	South	"	"	"
		"	"	West	"	"	"

Feet from North Line of Section

330	330	"	"	East	"	"	"
330	330	"	"	South	"	<u>1/4</u>	"
		"	"	West	"	"	"

LEGEND

- Location
- ☀ Gas Well
- Oil Well
- ☀ Gas-Distillate Well
- or ○ Dry Hole
- Dry Showing Oil
- ☀ Dry Showing Gas
- ⊗ Abandoned Location
- ☀ or ☀ Abandoned Gas Well
- or ● Abandoned Oil Well
- ⊗ or ⊗ Input Well

Handwritten notes:
 30°
 429-44
 10" 200 269 w 300

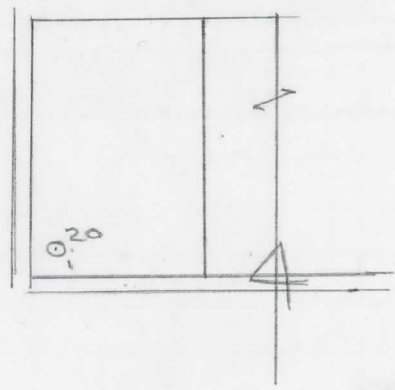

Scale _____

Remarks: _____

Submitted by RN _____
Civil Engineer

Approved by _____
Division Manager

Approved by _____
Vice-President - General Manager

Date June 7, 1944

LOCATION SEBEWA

WELL NO. 20

COMPLETION RECORD OF WELLS DRILLED BY OTHER OPERATORS

Michigan Producing Division

Date June 7, 1944 No. 20
 State Mich. County Ionia ~~River~~ Twp. Sebewa Sec. 4 Twp. 5 N Rge. 6 W
 Well No. 1 (~~XXXXXX~~) 20 Farm Creyton Est. Acres _____
 Operator Herman J. Schrauben Information secured ~~from~~ Scouting Department By _____
 Date well started 4-29-44 Date well completed 5-30-44 Elevation 816.6

PRODUCTION BOARD

1st 24 hours natural Dry Hole
 2nd 24 hours natural _____
 Date of shot _____ No. of quarts _____ From _____ to _____ From _____ to _____
 Date of acid _____ No. of gallons _____
 1st 24 hours after acid shot _____
 2nd 24 hours after acid shot _____

FORMATION AND CASING RECORD

Formation	Top	Bottom	Top Pay	Bottom Pay	Remarks	Casing	
						Size	Set at
Marshall	587	862				10"	269
Coldw. Red Rock	1869	1890				6-5/8"	931
Antrim (light)	1896						
Antrim (dark)	2140						
Traverse Form.	2245						
Traverse Lime	2307				Small show oil and gas 2307-2312. Water (40 ft.) at 2368.		
Total Depth		2374					

Remarks Flowing water in Drift - flowing fresh water at 300'.

Signed D. C. Shackelford