



Legacy Scout Tickets from Pure Oil Company

8-20-2021

MGRRE_PureOilScoutTickets_Roose, Emeric & Martha_1_21067113300000

MGRRE

Western Michigan University

Follow this and additional works at: <https://scholarworks.wmich.edu/pure>



Part of the Geology Commons

WMU ScholarWorks Citation

MGRRE, "MGRRE_PureOilScoutTickets_Roose, Emeric & Martha_1_21067113300000" (2021). *Legacy Scout Tickets from Pure Oil Company*. 2818.
<https://scholarworks.wmich.edu/pure/2818>

This Document is brought to you for free and open access via ScholarWorks at WMU. It has been accepted for inclusion in Legacy Scout Tickets from Pure Oil Company by an authorized administrator of ScholarWorks at WMU. See the National Digital Catalogue - Science Base Catalogue for more collections submitted by MGRRE.



MGRRE_PureOilScoutTickets_Roose, Emeric & Martha_1_21067113300000

API 21067113300000

Permit Number 11330

Lease Name Roose, Emeric & Martha

Well Number 1

County Ionia

Township 07N

Range 05W

Section 33

2021 DEQ or Pure co_name Fox Hole Oil Company

Pure Number 30

Latitude 42.95658

Longitude -84.9015

THE PURE OIL COMPANY

LOCATION REPORT

Date January 17, 1945 A.F.E. No. Emeric & Martha Roose
 Division Mich. Producing District _____ Lease Emeric & Martha Roose
 Acres _____ Lease No. _____ Elevation _____ Well No. 1 (Serial No. 30)
 Quadrangle N $\frac{1}{2}$ -N $\frac{1}{2}$ -NE Sec. 33 Twp. 7 N Rge. 5 W Twp. Lyons
 Survey _____ County Ionia State Michigan
 Operator Fox Hole Oil Co Map Lyons Twp - Ionia Co

800	800	Feet from North Line of Lease
330	330	“ “ East “ “ “
		“ “ South “ “ “
		“ “ West <u>1/4</u> “
610	610	Feet from North Line of Section
1320	1320	“ “ East “ “ “
		“ “ South “ “ “
1320	1320	“ “ West “ “ “

LEGEND

- Location
- ☀ Gas Well
- Oil Well
- ☀ Gas - Distillate Well
- ∅ or ○ Dry Hole
- Dry Showing Oil
- ☀ Dry Showing Gas
- ⊗ Abandoned Location
- ☀ or ☀ Abandoned Gas Well
- or ● Abandoned Oil Well
- or ○ Input Well

Low

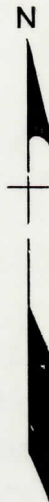
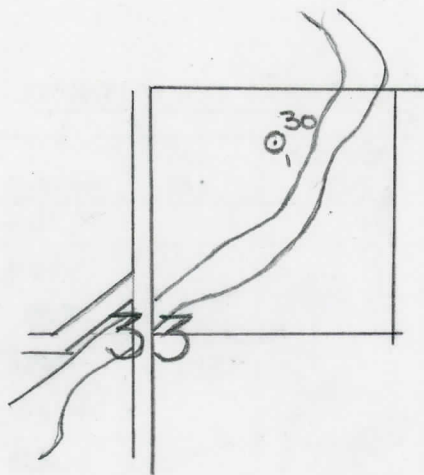

Scale _____

Remarks: _____

Submitted by RN Civil Engineer Approved by _____ Division Manager
 Approved by _____ Vice-President - General Manager

COMPLETION RECORD OF WELLS DRILLED BY OTHER OPERATORS

Michigan Producing Division

Date May 2, 1945 No. 30
 State Mich. County Ionia ~~XXXX~~ Twp. Lyons Sec. 33 Twp. 7 N Rge. 5 W
 Well No. 1 (Serial No.) ~~(County No.)~~ 30 Farm E. & M. Roose Acres _____
 Operator Fox Hole Oil Company Information secured ~~XXXX~~ By Scouting Department
 Date well started 1-30-45 Date well completed 4-25-45 Elevation 676.2

PRODUCTION BOARD

1st 24 hours natural Dry Hole
 2nd 24 hours natural _____
 Date of shot _____ No. of quarts _____ From _____ To _____ From _____ to _____
 Date of acid _____ No. of gallons _____
 1st 24 hours after acid shot _____
 2nd 24 hours after acid shot _____

FORMATION AND CASING RECORD

Formation	Top	Bottom	Top Pay	Bottom Pay	Remarks	Casing	
						Size	Set at
Brown Dolomite	635	(+4)				10"	252
Mich. Stray	655	(+2)				8-1/4" RH	270
Marshall	710	863	(-34)			6-5/8"	910
Coldw. Red Rock	1954	1966	(-1278)			5-3/16"	2396 Out
Sunbury	1980	(-1304)					
Traverse Form.	2353	SLM.	(-1677)				
Trav. Lime (S)	2396	"	(-1720)		Show oil 2398-2403; HFSW 2440-2445.		
Dundee	2750	(-2074)			No water in Dundee.		
Total Depth		2828	(-2152)				

Remarks At 2405' attempted to acidize Traverse oil showing but formation would not take acid.
2372' equals 2376' SLM; 2826' equals 2826' SLM.

Signed D. C. Shackelford