



Western Michigan University
ScholarWorks at WMU

Legacy Scout Tickets from Pure Oil Company

8-20-2021

MGRRE_PureOilScoutTickets_Dalton_2_21067115390000

MGRRE

Western Michigan University

Follow this and additional works at: <https://scholarworks.wmich.edu/pure>



Part of the Geology Commons

WMU ScholarWorks Citation

MGRRE, "MGRRE_PureOilScoutTickets_Dalton_2_21067115390000" (2021). *Legacy Scout Tickets from Pure Oil Company*. 2820.

<https://scholarworks.wmich.edu/pure/2820>

This Document is brought to you for free and open access via ScholarWorks at WMU. It has been accepted for inclusion in Legacy Scout Tickets from Pure Oil Company by an authorized administrator of ScholarWorks at WMU. See the National Digital Catalogue - Science Base Catalogue for more collections submitted by MGRRE.



MGRRE_PureOilScoutTickets_Dalton_2_21067115390000

API 21067115390000

Permit Number 11539

Lease Name Dalton

Well Number 2

County Ionia

Township 08N

Range 05W

Section 6

2021 DEQ or Pure co_name Roosevelt Oil and Refining Corporation

Pure Number 32

Latitude 43.11737

Longitude -84.94205

THE PURE OIL COMPANY LOCATION REPORT

Date May 16, 1945

A.F.E. No. _____

Division Mich. Producing

District _____

Dalton
Dalton

Acres _____ Lease No. _____ Elevation _____ Well No. 2 (Serial No. 32)

Quadrangle SE-NW-NE Sec. 6 Twp. 8 N Rge. 5 W Twp. North Plains
SE NW NE 6 8 N 5 W North Plains

Survey _____ County Ionia State Michigan

Operator C. L. Maguire, Inc. 12-12-49 North Plains Twp - Ionia Co.
C. L. Maguire, Inc. Roosevelt Oil & Refy. Corp. Map North Plains Township, Ionia County

Feet from North Line of Lease

_____	_____	East	_____	_____
<u>330</u>	<u>330</u>	South	_____	_____
<u>990</u>	<u>990</u>	West	<u>1/4</u>	_____
<u>786</u>	<u>786</u>	Feet from North Line of Section		
_____	_____	East	_____	_____
_____	_____	South	_____	_____
<u>990</u>	<u>990</u>	West	_____	_____

LEGEND

- Location
- ☀ Gas Well
- Oil Well
- ☀ Gas - Distillate Well
- ⊘ or ○ Dry Hole
- Dry Showing Oil
- ☀ Dry Showing Gas
- ⊘ Abandoned Location
- ☀ or ☀ Abandoned Gas Well
- or ● Abandoned Oil Well
- or ○ Input Well

Ree

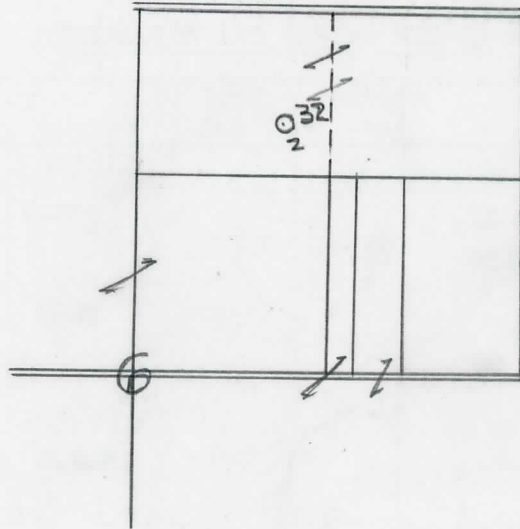

Scale _____

Remarks: _____

Submitted by EW Civil Engineer

Approved by _____ Division Manager

Approved by _____ Vice-President - General Manager

The Pure Oil Company
 COMPLETION RECORD OF WELLS DRILLED BY OTHER OPERATORS

Michigan Producing Division

Date July 5, 1945 No. 32
 State Mich. County Ionia ~~Dist.~~ Twp. North Plains Sec. 6 Twp. 8 N Rge. 5 W
 Well No. 2 (~~County~~) 32 Farm Dalton Acres
 Operator C. L. Maguire, Inc. Information secured ~~xxxx~~ By Scouting Department
 Date well started 5-17-45 Date well completed 6-30-45 Elevation 803.0

PRODUCTION BOARD

1st 24 hours natural Dry Hole
 2nd 24 hours natural
 Date of shot No. of quarts From To From to
 Date of acid No. of gallons
 1st 24 hours after acid shot
 2nd 24 hours after acid shot

FORMATION AND CASING RECORD

Formation	Top	Bottom	Top Pay	Bottom Pay	Remarks	Casing	
						Size	Set at
Brown Dolomite	858	(-53)				10"	374
Mich. Stray	878	(-75)			10 ba. S.W./Hr. 901-905. (-98)	8-1/4"	680
						6-5/8"	1133
Marshall	940	1125	(-137)			5-3/16"	2620 Out
Coldw. Red Rock	2185	(-1382)				5-3/16"	3017
Sunbury	2212	(-1409)					
Traverse Form.	2600	S.L.M.	(-1797)				
Trav.-Squaw Bay	2638	(-1835)					
Trav.-Alpena	2651	(-1848)			800 ft. S.W. in 2 hrs. 2686-2692. (-1883)		
Dundee	3016	(-2213)			Show salt water 3050. (-2240)		
					200 ft. S.W.-1/2 hrs. at 3068. (-2265)		
Total Depth		3068	(-2265)				

Remarks 927' equals 922' SOM; 2056' equals 2058' SLM; 2644' equals 2640' SLM.

Signed D. C. Shackelford