



Western Michigan University  
ScholarWorks at WMU

---

Legacy Scout Tickets from Pure Oil Company

---

8-20-2021

## MGRRE\_PureOilScoutTickets\_McKay\_1\_unk

MGRRE

*Western Michigan University*

Follow this and additional works at: <https://scholarworks.wmich.edu/pure>



Part of the Geology Commons

---

### WMU ScholarWorks Citation

MGRRE, "MGRRE\_PureOilScoutTickets\_McKay\_1\_unk" (2021). *Legacy Scout Tickets from Pure Oil Company*. 2828.

<https://scholarworks.wmich.edu/pure/2828>

This Document is brought to you for free and open access via ScholarWorks at WMU. It has been accepted for inclusion in Legacy Scout Tickets from Pure Oil Company by an authorized administrator of ScholarWorks at WMU. See the National Digital Catalogue - Science Base Catalogue for more collections submitted by MGRRE.



---

## MGRRE\_PureOilScoutTickets\_McKay\_1\_unk

API unk

Permit Number unk

Lease Name McKay

Well Number 1

County Iosco

Township 22N

Range 08E

Section 20

2021 DEQ or Pure co\_name Robt. Gage Coal

Pure Number 4

Latitude 44.2874351

Longitude -83.4921153

THE PURE OIL COMPANY  
LOCATION REPORT

No. 4

DATE June 18 1927

STATE Mich COUNTY Iosco DIST. Baldwins TWP. 20 SEC. 20 TOWN 22N RANGE 8E  
PREC.

WELL No. 1 (SERIAL No. 4) FARM 113 McKay Farm Lot. ACRES

NAME OF STREAM OR WATERS QUADRANGLE

OPERATOR Robert Gage Coal Co. MAP Center part Baldwins Twp

Feet from North Line of Farm

15 " " East " " Oak St

225 " " South " " Lakeshore Drive

" " West " " "

Feet from North Line of Section

" " East " " "

" " South " " "

" " West " " "

LEGEND

O LOCATION

① RIG

⊕ DRILLING

☼ GAS WELL

● OIL WELL

◆ SMALL OIL WELL

⊕ DRY HOLE

◆ DRY SHOWING OIL

☼ DRY SHOWING GAS

⊕ ABANDONED LOCATION

☼ ABANDONED GAS WELL

◆ ABANDONED OIL WELL

NOTE: Below make tracing from map, (when no map is obtainable make sketch) showing farm, center of section, this location with measurements and also wells, dry holes, or other locations in the vicinity of this location. Make copy to keep for reference and send original to Chicago office.

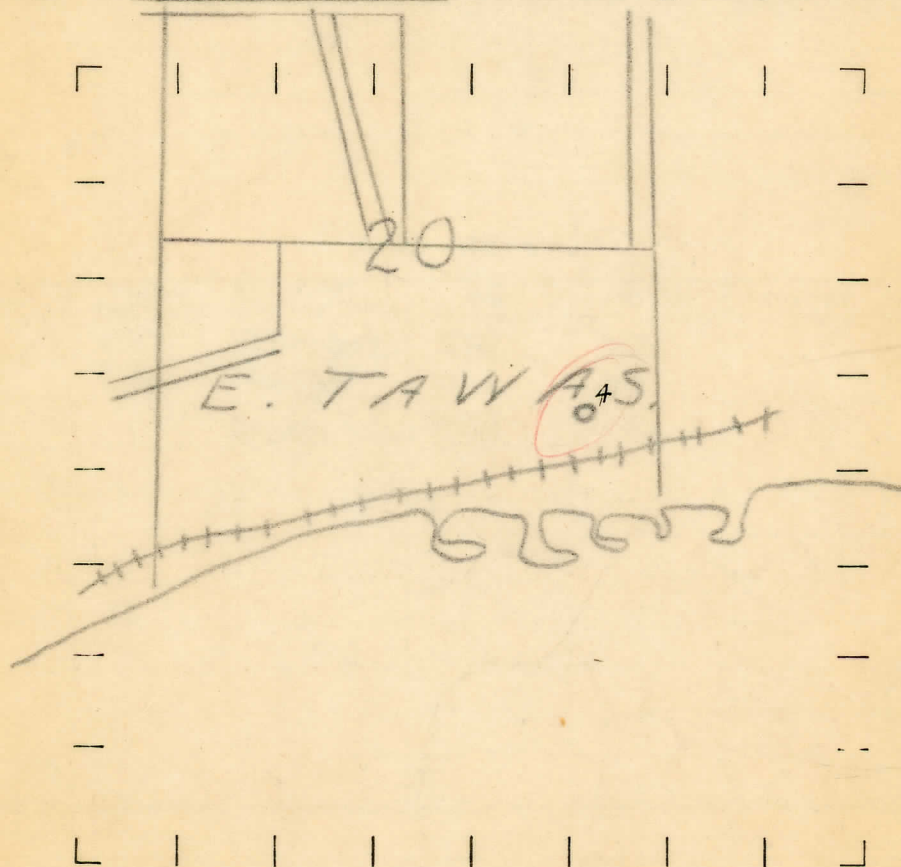

REMARKS:

SIGNED

Superintendent or Foreman.



No

No. 4

SEC. 20 TOWN 22 N RANGE SE

## ABANDONED WELL

5th " " " " " "

## REMARKS

SIGNED \_\_\_\_\_ SUPT. OR FOREMAN

CHARGEABLE TO WELL No.

East Texas

westover

EMERY ST	9		8		66' Oak St.
	10		7		
	11		6		
	12		5		
	1		4		
	2	3	5	72	0

Lake Side Drive

200' to "

15' from Oak St.

225' ft from Lake Side drive

Sect 20