



Western Michigan University
ScholarWorks at WMU

Legacy Scout Tickets from Pure Oil Company

8-20-2021

MGRRE_PureOilScoutTickets_Spencer, Lillian_1_21069085570000

MGRRE

Western Michigan University

Follow this and additional works at: <https://scholarworks.wmich.edu/pure>



Part of the Geology Commons

WMU ScholarWorks Citation

MGRRE, "MGRRE_PureOilScoutTickets_Spencer, Lillian_1_21069085570000" (2021). *Legacy Scout Tickets from Pure Oil Company*. 2841.

<https://scholarworks.wmich.edu/pure/2841>

This Document is brought to you for free and open access via ScholarWorks at WMU. It has been accepted for inclusion in Legacy Scout Tickets from Pure Oil Company by an authorized administrator of ScholarWorks at WMU. See the National Digital Catalogue - Science Base Catalogue for more collections submitted by MGRRE.



MGRRE_PureOilScoutTickets_Spencer, Lillian_1_21069085570000

API 21069085570000

Permit Number 8557

Lease Name Spencer, Lillian

Well Number 1

County Iosco

Township 23N

Range 05E

Section 15

2021 DEQ or Pure co_name Roberts, Edmund A.

Pure Number 18

Latitude 44.3843

Longitude -83.80875

DATE May 28, 1941

Corrected

THE PURE OIL COMPANY

LOCATION REPORT

No. 18

STATE MichiganCOUNTY IoscoDIST. PlainfieldTWP. PlainfieldSEC. 15TOWN 23 NRANGE 5 EWELL No. 1 (SERIAL No. 18) FARM Lillian Spencer

ACRES

NAME OF STREAM OR WATERS

QUADRANGLE NW NE SEOPERATOR Edmund A. Robert

Map

Plainfield Township, Iosco County330 330 Feet from North Line of Farm

" " East " " "

" " South " " "

330 330 " " West " " "330 330 Feet from North Line of Section 1/4990 990 " " East " " "

" " South " " "

" " West " " "

LEGEND

○ LOCATION

⊕ RIG

⊕ DRILLING

☀ GAS WELL

● OIL WELL

● SMALL OIL WELL

⊖ DRY HOLE

⊖ DRY SHOWING OIL

⊖ DRY SHOWING GAS

⊖ ABANDONED LOCATION

☀ ABANDONED GAS WELL

● ABANDONED OIL WELL

NOTE: Below make tracing from map. (when no map is obtainable make sketch) showing farm, center of section, this location with measurements and also wells, dry holes, or other locations in the vicinity of this location.

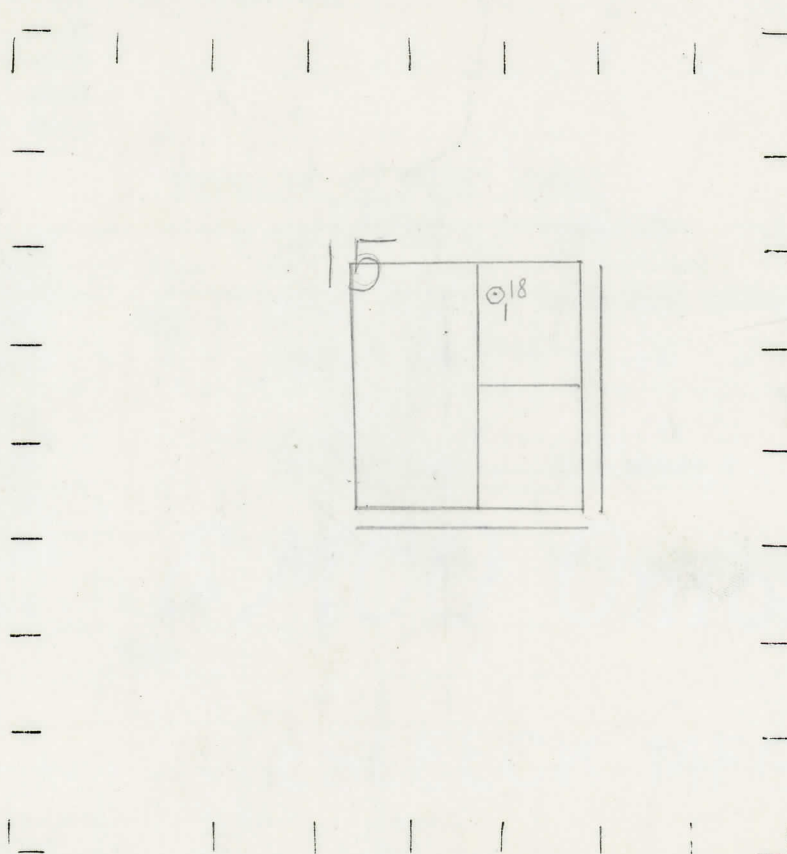

REMARKS: Location correction.

SIGNED

Superintendent or Foreman.

330 Feet from North Line of Farm
OBSERVER Edmund A. Roberts
NAME OF STREAM OR WATERS
WELL No. 1 (SERIAL No. 18) FARM Lillian Spencer
NAME OF STREAM OR WATERS
QUADRANGLE NE NE SE

OPERATOR Edmund A. Roberts Map Plainfield Township, Iosco County
330 Edmund A. Roberts
330 330 Feet from North Line of Farm

330 330 " " East " " "
" " South " " "
" " West " " "
330 330 Feet from North Line of Section
330 330 " " East " " "
" " South " " "
" " West " " "

○ LOCATION
① RIG
⊕ DRILLING
☀ GAS WELL
● OIL WELL
◆ SMALL OIL WELL

LEGEND
○ DRY HOLE
◆ DRY SHOWING OIL
☀ DRY SHOWING GAS
○ ABANDONED LOCATION
☀ ABANDONED GAS WELL
● ABANDONED OIL WELL

NOTE: Below make tracing from map. (when no map is obtainable make sketch) showing farm, center of section, this location with measurements and also wells, dry holes, or other locations in the vicinity of this location.

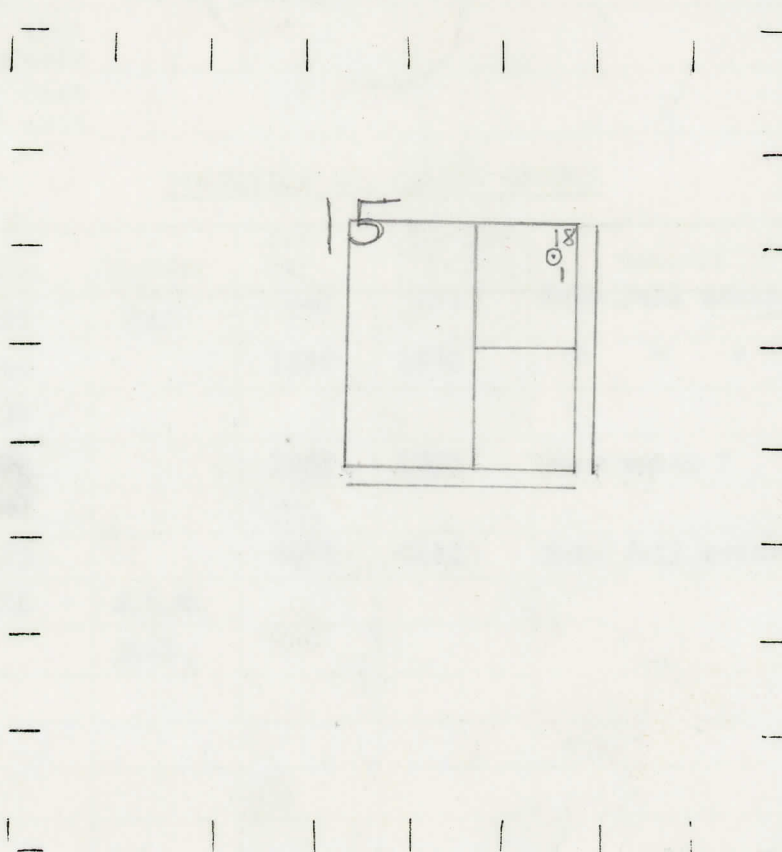

REMARKS:

SIGNED

Superintendent or Foreman.

Signed D. C. Shackelford