



Western Michigan University  
ScholarWorks at WMU

---

Legacy Scout Tickets from Pure Oil Company

---

8-20-2021

## MGRRE\_PureOilScoutTickets\_National Gypsum Company\_1\_21069104200000

MGRRE

*Western Michigan University*

Follow this and additional works at: <https://scholarworks.wmich.edu/pure>



Part of the Geology Commons

---

### WMU ScholarWorks Citation

MGRRE, "MGRRE\_PureOilScoutTickets\_National Gypsum Company\_1\_21069104200000" (2021). *Legacy Scout Tickets from Pure Oil Company*. 2842.  
<https://scholarworks.wmich.edu/pure/2842>

This Document is brought to you for free and open access via ScholarWorks at WMU. It has been accepted for inclusion in Legacy Scout Tickets from Pure Oil Company by an authorized administrator of ScholarWorks at WMU. See the National Digital Catalogue - Science Base Catalogue for more collections submitted by MGRRE.



---

**MGRRE\_PureOilScoutTickets\_National Gypsum Company\_1\_21069104200000**

API 21069104200000

Permit Number 10420

Lease Name National Gypsum Company

Well Number 1

County losco

Township 21N

Range 06E

Section 16

2021 DEQ or Pure co\_name Stork Oil Company

Pure Number 19

Latitude 44.21909

Longitude -83.71524

# THE PURE OIL COMPANY LOCATION REPORT

Date October 13, 1943 A.F.E. No. \_\_\_\_\_

Division Michigan Producing District \_\_\_\_\_ Lease National Gypsum Co.  
National Gypsum Co.

Acres \_\_\_\_\_ Lease No. \_\_\_\_\_ Elevation \_\_\_\_\_ Well No. \_\_\_\_\_ (Serial No. 19)

Quadrangle C N $\frac{1}{2}$ -NE-NW Sec. 16 Twp. 21 N Rge. 6 E Blk. Dist. Sherman  
C N $\frac{1}{2}$ -NE-NW Sherman

Survey \_\_\_\_\_ County Iosco State Michigan

Operator Stork Oil Co. Map Sherman Twp - Iosco Co  
Stork Oil Co. Sherman Twp., Iosco Co.

<u>330</u>	<u>330</u>	Feet from North Line of Lease
<u>600</u>	<u>600</u>	" " East " " "
_____	_____	" " South " " "
_____	_____	" " West " " "
<u>330</u>	<u>330</u>	Feet from North Line of Section
<u>600</u>	<u>600</u>	" " East " " "
_____	_____	" " South " " "
_____	_____	" " West " " "

**LEGEND**

- Location
- ☀ Gas Well
- Oil Well
- ☀ Gas - Distillate Well
- or ○ Dry Hole
- or ● Dry Showing Oil
- ☀ Dry Showing Gas
- ⊗ Abandoned Location
- ☀ or ☀ Abandoned Gas Well
- or ● Abandoned Oil Well
- or ○ Input Well

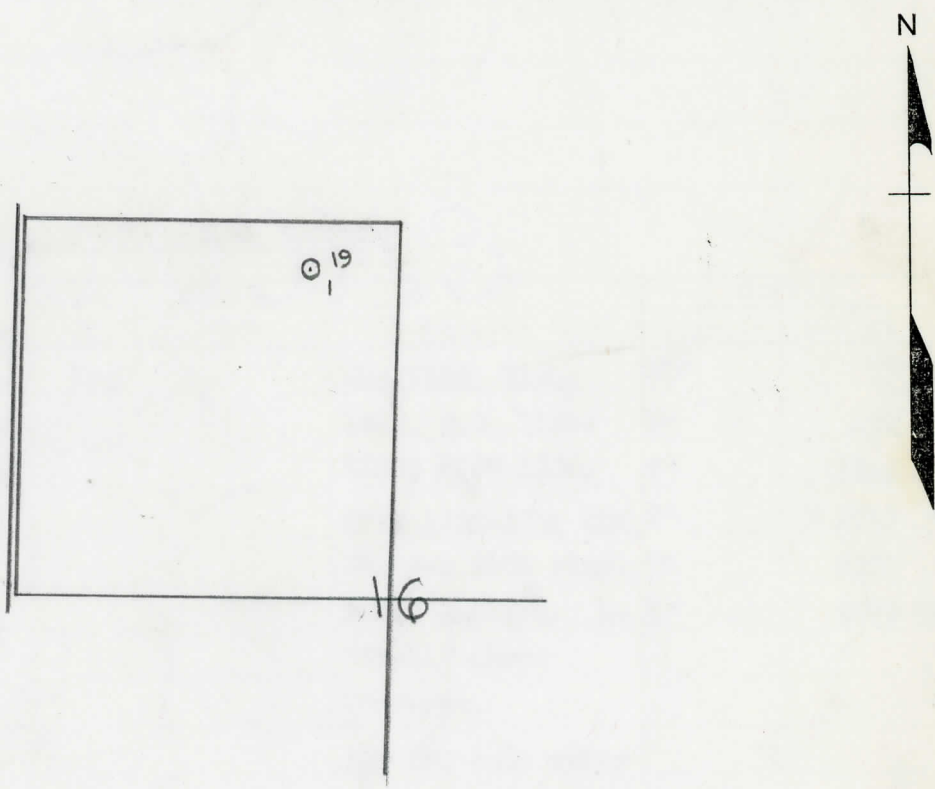

Scale \_\_\_\_\_

Remarks: \_\_\_\_\_  
\_\_\_\_\_  
\_\_\_\_\_

Submitted by RN Civil Engineer Approved by \_\_\_\_\_ Division Manager

Approved by \_\_\_\_\_ Vice-President - General Manager

THE PURE OIL COMPANY

The Pure Oil Company

COMPLETION RECORD OF WELLS DRILLED BY OTHER OPERATORS

Michigan Producing Division

Date February 16, 1944 No. 19  
 State Mich. County Iosco Dist. Sherman Twp. 21 N Rge. 6 E  
 (Serial No.)  
 Well No. 1 (County No.) 19 Farm National Gypsum Co. Acres \_\_\_\_\_  
 Operator Stork Oil Company Information secured from Scouting Department  
 Date well started 10-18-43 Date well completed 2-13-44 Elevation 654.0

PRODUCTION BOARD

1st 24 hours natural Dry Hole  
 2nd 24 hours natural \_\_\_\_\_  
 Date of shot \_\_\_\_\_ No. of quarts \_\_\_\_\_ From \_\_\_\_\_ to \_\_\_\_\_ From \_\_\_\_\_ to \_\_\_\_\_  
 Date of acid \_\_\_\_\_ No. of gallons \_\_\_\_\_  
 shot  
 1st 24 hours after acid \_\_\_\_\_  
 shot  
 2nd 24 hours after acid \_\_\_\_\_

FORMATION AND CASING RECORD

Formation	Top	Bottom	Top Pay	Bottom Pay	Remarks	Casing	
						Size	Set at
Marshall	223	385	Log		Gas 1110; 1190;	10"	75
Coldw. Red Rock	1655	SLM.			1290. S.W. 1160;	8"	492
Sunbury	1666	SLM.			1210; HPSW 1326.	7"	1640 Out
Berea	1710	"			HPSW 1720-1734 SLM.	7"	1913 "
Antrim	1974	Log			Sho gas 2100 plus.	7"	2000
Traverse Lime	2302	SOM.			2 ba. water/hr. in "Shell" above Traverse.	5"	3079 RH
Dundee	3079	SOM.			500 ft. salt water while drilling 3000 to 3306.		
Total Depth		3306					

Remarks 1657' CTM eq. 1640' (Pipe Tally); 1754' CTM eq. 1734' SLM; 3100' CTM eq. 3077' SOM.

Signed D. C. Shackelford