



Western Michigan University
ScholarWorks at WMU

Legacy Scout Tickets from Pure Oil Company

8-20-2021

MGRRE_PureOilScoutTickets_Pember, Ira M. et
al_1_21069107320000

MGRRE
Western Michigan University

Follow this and additional works at: <https://scholarworks.wmich.edu/pure>



Part of the Geology Commons

WMU ScholarWorks Citation

MGRRE, "MGRRE_PureOilScoutTickets_Pember, Ira M. et al_1_21069107320000" (2021). *Legacy Scout Tickets from Pure Oil Company*. 2844.
<https://scholarworks.wmich.edu/pure/2844>

This Document is brought to you for free and open access via ScholarWorks at WMU. It has been accepted for inclusion in Legacy Scout Tickets from Pure Oil Company by an authorized administrator of ScholarWorks at WMU. See the National Digital Catalogue - Science Base Catalogue for more collections submitted by MGRRE.



MGRRE_PureOilScoutTickets_Pember, Ira M. et al_1_21069107320000

API 21069107320000

Permit Number 10732

Lease Name Pember, Ira M. et al

Well Number 1

County Iosco

Township 23N

Range 05E

Section 29

2021 DEQ or Pure co_name Bennight, E. L. and Bartlett, B. A.

Pure Number 21

Latitude 44.35866

Longitude -83.86248

Correction

THE PURE OIL COMPANY

LOCATION REPORT

Date July 12, 1944 Corrected A.F.E. No. _____

Division Mich. Producing District _____ Lease Ira M. Pember, et al

Acres _____ Lease No. _____ Elevation _____ Well No. 1 (Serial No. 21)

Quadrangle C N₂ SW NW Sec. 29 Twp. 23 N Rge. 5 E Plainfield

Survey _____ County Iosco State Michigan

Operator E. L. Bennight & B. A. Bartlett Map Plainfield Twp - Iosco Co

330 330 Feet from North Line of Lease

660 660 " " East " " "

660 660 " " South " " "

660 660 " " West " " "

Feet from North Line of Section

990 990 " " East " " "

660 660 " " South " 1/4 "

660 660 " " West " " "

LEGEND

○ Location

☀ Gas Well

● Oil Well

☀ Gas - Distillate Well

○ or ○ Dry Hole

● Dry Showing Oil

☀ Dry Showing Gas

○ Abandoned Location

☀ or ☀ Abandoned Gas Well

● or ● Abandoned Oil Well

● or ○ Input Well

See plat - Iosco #21.



Change of Company name

Remarks: Change of Company name.

Scale _____

Submitted by _____

Civil Engineer

Approved by _____

Division Manager

Approved by _____

Vice-President - General Manager

Division Mich. Producing District _____ Date April 26, 1944 LOCATION REPORT A.F.E. No. _____
Ira M. Pember et al
Ira M. Pember, et al
Acres _____ Lease No. _____ Elevation _____ Well No. 1 (Serial No. 21)
Quadrangle C N¹/₂ SW NW Sec. 29 Twp. 23 N Rge. 5 E Twp. Plainfield
Survey _____ County Iosco State Michigan
Operator E. L. Bennight Map Plainfield Twp. Iosco Co
Plainfield Township, Iosco County

330 330 Feet from North Line of Lease
660 660 " " East " " "
" " South " " "
660 660 " " West " " "
Feet from North Line of Section
" " East " " "
" " South " 1/4 "
660 660 " " West " " "

LEGEND

○ Location

- ☀ Gas Well
● Oil Well
☀ Gas - Distillate Well
○ or ○ Dry Hole
● Dry Showing Oil
☀ Dry Showing Gas
⊙ Abandoned Location
☀ or ☀ Abandoned Gas Well
● or ● Abandoned Oil Well
● or ○ Input Well

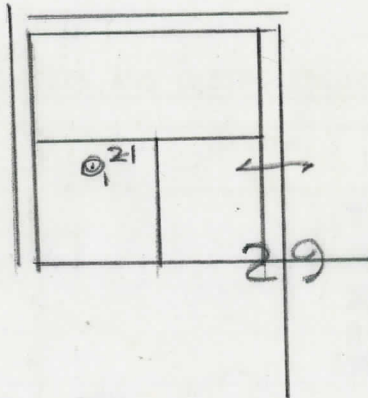

Scale _____

Remarks: _____

Submitted by RN Civil Engineer Approved by _____ Division Manager
Approved by _____ Vice-President - General Manager

COMPLETION RECORD OF WELLS DRILLED BY OTHER OPERATORS

Michigan Producing Division

Date June 15, 1944 No. 21
 State Mich. County Iosco Twp. Plainfield Sec. 29 Twp. 23 N Rge. 5 E
 Well No. 1 (Serial No.) 21 Farm Ira M. Pember, et al Acres
 Operator E. L. Bennight Information secured By Scouting Department
 Date well started 4-20-44 Date well completed 6-12-44 Elevation 893.5

PRODUCTION BOARD

1st 24 hours natural Dry Hole
 2nd 24 hours natural
 Date of shot No. of quarts From to From to
 Date of acid No. of gallons
 1st 24 hours after acid shot
 2nd 24 hours after acid shot

FORMATION AND CASING RECORD

Formation	Top	Bottom	Top Pay	Bottom Pay	Remarks	Casing	
						Size	Set at
Marshall	390 (4524)	530			7 ba. water/hr. at	10"	281
Coldw. Red Rock	1800 (496)	1805			1010' (416)	8-1/4"	580
Sunbury	1825 (4931)				500 ft. wtr. 1600' (476)	6-5/8"	1625
Berea	1856 (4962)	SOM			2 ba. water/8 hrs. 1990-2000. (4096)	5-3/16"	2617
Antrim	2000 (41104)	2390s	CTM				
Traverse Lime	2416s (4522)	CTM			200 ft. salt water at 2432. (4538)		
Dundee	3175 (4281)	SOM.			Water (8 ba. in 2 hrs.) 3310-3325. (46)		
Total Depth		3344 (42450)					

Remarks 3176' CTM equals 3175' SOM.

Signed D. C. Shackelford