



Western Michigan University  
ScholarWorks at WMU

---

Legacy Scout Tickets from Pure Oil Company

---

8-20-2021

**MGRRE\_PureOilScoutTickets\_Wezensky\_1\_21073015660000**

MGRRE

*Western Michigan University*

Follow this and additional works at: <https://scholarworks.wmich.edu/pure>



Part of the Geology Commons

---

#### **WMU ScholarWorks Citation**

MGRRE, "MGRRE\_PureOilScoutTickets\_Wezensky\_1\_21073015660000" (2021). *Legacy Scout Tickets from Pure Oil Company*. 3102.

<https://scholarworks.wmich.edu/pure/3102>

This Document is brought to you for free and open access via ScholarWorks at WMU. It has been accepted for inclusion in Legacy Scout Tickets from Pure Oil Company by an authorized administrator of ScholarWorks at WMU. See the National Digital Catalogue - Science Base Catalogue for more collections submitted by MGRRE.



---

**MGRRE\_PureOilScoutTickets\_Wezensky\_1\_21073015660000**

API 21073015660000

Permit Number 1566

Lease Name Wezensky

Well Number 1

County Isabella

Township 15N

Range 03W

Section 30

2021 DEQ or Pure co\_name Wellman Oil Company

Pure Number 339

Latitude 43.66342

Longitude -84.71686

DATE 7-7-33

LOCATION REPORT

No. 339

STATE Michigan COUNTY Isabella DIST. Denver SEC. 30 TOWN 15N RANGE 3W

WELL No. 1 (SERIAL No. 339) FARM Anton Wezensky 40 ACRES

NAME OF STREAM OR WATERS \_\_\_\_\_ QUADRANGLE SW $\frac{1}{4}$ -NE $\frac{1}{4}$

OPERATOR Wellman Oil Co. MAP \_\_\_\_\_

\_\_\_\_\_ Feet from North Line of Farm

\_\_\_\_\_ " " East " " "

330 " " South " " "

330 " " West " " "

2310 \_\_\_\_\_ Feet from North Line of Section

2310 " " East " " "

\_\_\_\_\_ " " South " " "

\_\_\_\_\_ " " West " " "

**LEGEND**

- LOCATION
- ⊙ RIG
- ⊕ DRILLING
- ☼ GAS WELL
- OIL WELL
- ⬮ SMALL OIL WELL
- ⬮ DRY HOLE
- ⬮ DRY SHOWING OIL
- ⬮ DRY SHOWING GAS
- ⬮ ABANDONED LOCATION
- ⬮ ABANDONED GAS WELL
- ⬮ ABANDONED OIL WELL

NOTE: Below make tracing from map, (when no map is obtainable make sketch) showing farm, center of section, this location with measurements and also wells, dry holes, or other locations in the vicinity of this location. Make copy to keep for reference and send original to Columbus office.

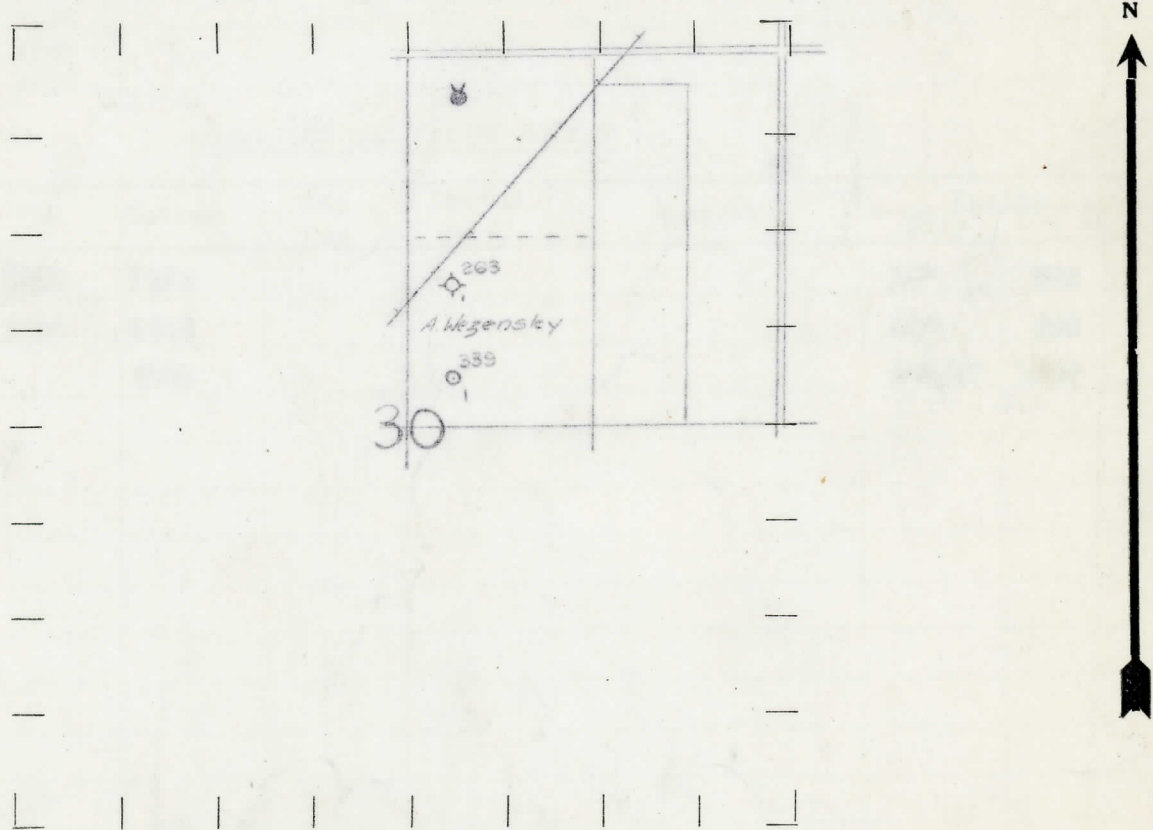

REMARKS:

\_\_\_\_\_  
 \_\_\_\_\_  
 \_\_\_\_\_

SIGNED

*W. E. Shapton*  
 Superintendent or Foreman.

