



Western Michigan University
ScholarWorks at WMU

Legacy Scout Tickets from Pure Oil Company

8-20-2021

MGRRE_PureOilScoutTickets_Sheanhan_2_na

MGRRE

Western Michigan University

Follow this and additional works at: <https://scholarworks.wmich.edu/pure>



Part of the Geology Commons

WMU ScholarWorks Citation

MGRRE, "MGRRE_PureOilScoutTickets_Sheanhan_2_na" (2021). *Legacy Scout Tickets from Pure Oil Company*. 3138.

<https://scholarworks.wmich.edu/pure/3138>

This Document is brought to you for free and open access via ScholarWorks at WMU. It has been accepted for inclusion in Legacy Scout Tickets from Pure Oil Company by an authorized administrator of ScholarWorks at WMU. See the National Digital Catalogue - Science Base Catalogue for more collections submitted by MGRRE.



MGRRE_PureOilScoutTickets_Sheanhan_2_na

API na

Permit Number na

Lease Name Sheanhan

Well Number 2

County Isabella

Township 16N

Range 04W

Section 26

2021 DEQ or Pure co_name Brozard

Pure Number 376

Latitude 43.7496572

Longitude -84.757703

DATE 8-21-33

LOCATION REPORT

No. 376

STATE Michigan COUNTY Isabella DIST. Vernon TWP. Vernon SEC. 26 TOWN 16N RANGE 4W

WELL No. 2 (SERIAL No. 376) FARM James Sheehan ACRES

NAME OF STREAM OR WATERS QUADRANGLE SE-SW-NE

OPERATOR T. K. Buzard MAP Vernon Twp., Isabella Co.

330 Feet from North Line of Farm

330 " " East " " "

" " South " " "

" " West " " "

Feet from North Line of Section

" " East " " "

330 " " South " " $\frac{1}{4}$ "

990 " " West " " $\frac{1}{4}$ "

LEGEND

- LOCATION
- ⊕ RIG
- ⊕ DRILLING
- ⊕ GAS WELL
- OIL WELL
- ⊕ SMALL OIL WELL
- ⊕ DRY HOLE
- ⊕ DRY SHOWING OIL
- ⊕ DRY SHOWING GAS
- ⊕ ABANDONED LOCATION
- ⊕ ABANDONED GAS WELL
- ⊕ ABANDONED OIL WELL

NOTE: Below make tracing from map, (when no map is obtainable make sketch) showing farm, center of section, this location with measurements and also wells, dry holes, or other locations in the vicinity of this location. Make copy to keep for reference and send original to Columbus office.

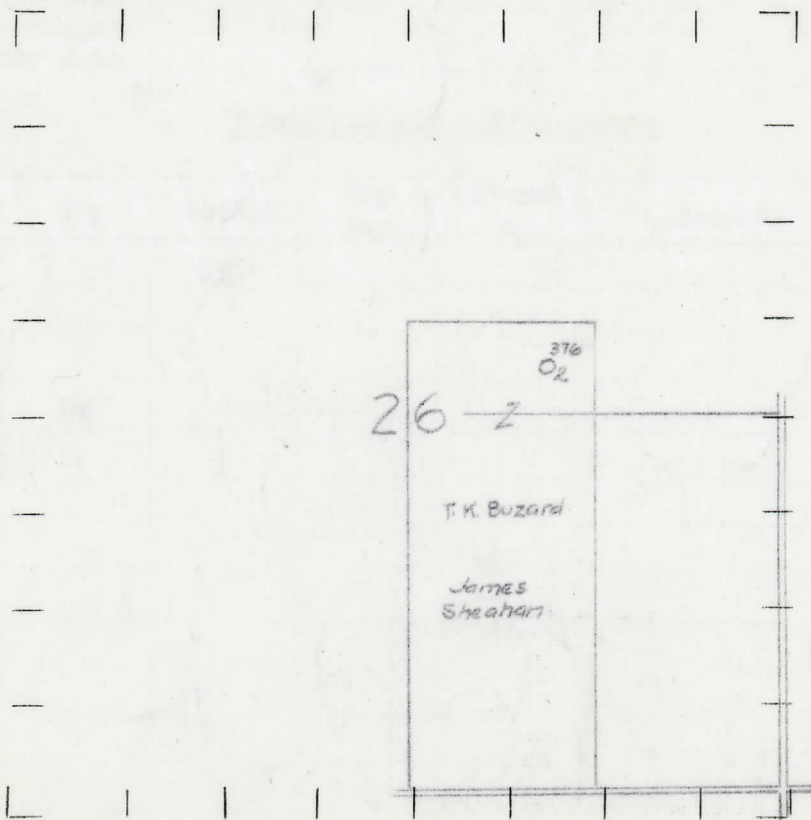

REMARKS:

SIGNED

R. L. Yeager
Superintendent or Foreman.

Michigan Producing Division

Date 2/28/35 No. 376
 State Michigan County Isabella Dist.
 (Serial No.) Twp. Vernon Sec. 26 Twp. 16N Rge. 4W
 Well No. 2 (County No.) 376 Farm James Sheehan Acres
 Operator T. K. Buzard Information secured by Scouting Department
 Date well started 8/25/33 Date well completed Not completed Elevation 815.8'

PRODUCTION RECORD

1st 24 hours natural
 2nd 24 hours natural
 Date of shot No. of quarts From to From to
 Date of acid No. of gallons
 1st 24 hours after acid shot
 2nd 24 hours after acid shot

FORMATION AND CASING RECORD

Formation	Top	Bottom	Top Pay	Bottom Pay	Remarks	Casing	
						Size	Set at
Total Depth		635'					

Remarks Abandoned at a total depth of 635' - Not plugged.

Signed G.A.T. Bell