



Western Michigan University
ScholarWorks at WMU

Legacy Scout Tickets from Pure Oil Company

8-20-2021

MGRRE_PureOilScoutTickets_Simpson_1_21073021240000

MGRRE

Western Michigan University

Follow this and additional works at: <https://scholarworks.wmich.edu/pure>



Part of the Geology Commons

WMU ScholarWorks Citation

MGRRE, "MGRRE_PureOilScoutTickets_Simpson_1_21073021240000" (2021). *Legacy Scout Tickets from Pure Oil Company*. 3236.

<https://scholarworks.wmich.edu/pure/3236>

This Document is brought to you for free and open access via ScholarWorks at WMU. It has been accepted for inclusion in Legacy Scout Tickets from Pure Oil Company by an authorized administrator of ScholarWorks at WMU. See the National Digital Catalogue - Science Base Catalogue for more collections submitted by MGRRE.



MGRRE_PureOilScoutTickets_Simpson_1_21073021240000

API 21073021240000

Permit Number 2124

Lease Name Simpson

Well Number 1

County Isabella

Township 16N

Range 04W

Section 16

2021 DEQ or Pure co_name Cartiers Oil Company

Pure Number 475

Latitude 43.77219

Longitude -84.7892

DATE 8-2-34
8/2/34

LOCATION REPORT

No. 475

STATE Michigan COUNTY Isabella DIST. Vernon TWP. Vernon SEC. 16 TOWN 16N RANGE 4W

WELL No. 1 (SERIAL No. 475) FARM Jesse A. Simpson ACRES

NAME OF STREAM OR WATERS QUADRANGLE SE-SE-SE
SE-SE-SE

OPERATOR The Chartiers Oil Company MAP Vernon Township, Isabella County
Chartiers Oil Co. Vernon Twp. - Isabella Co.

Feet from North Line of Farm

297 297 " " East " " "

425 425 " " South " " "

297 297 " " West " " "

Feet from North Line of Section

297 297 " " East " " $\frac{1}{4}$ "

425 425 " " South " " $\frac{1}{4}$ "

" " West " " "

LEGEND

- LOCATION
- ① RIG
- ⊕ DRILLING
- ⊛ GAS WELL
- OIL WELL
- ⬮ SMALL OIL WELL
- ⊛ DRY HOLE
- ⬮ DRY SHOWING OIL
- ⊛ DRY SHOWING GAS
- ⊛ ABANDONED LOCATION
- ⊛ ABANDONED GAS WELL
- ⬮ ABANDONED OIL WELL

NOTE: Below make tracing from map, (when no map is obtainable make sketch) showing farm, center of section, this location with measurements and also wells, dry holes, or other locations in the vicinity of this location. Make copy to keep for reference and send original to Columbus office.

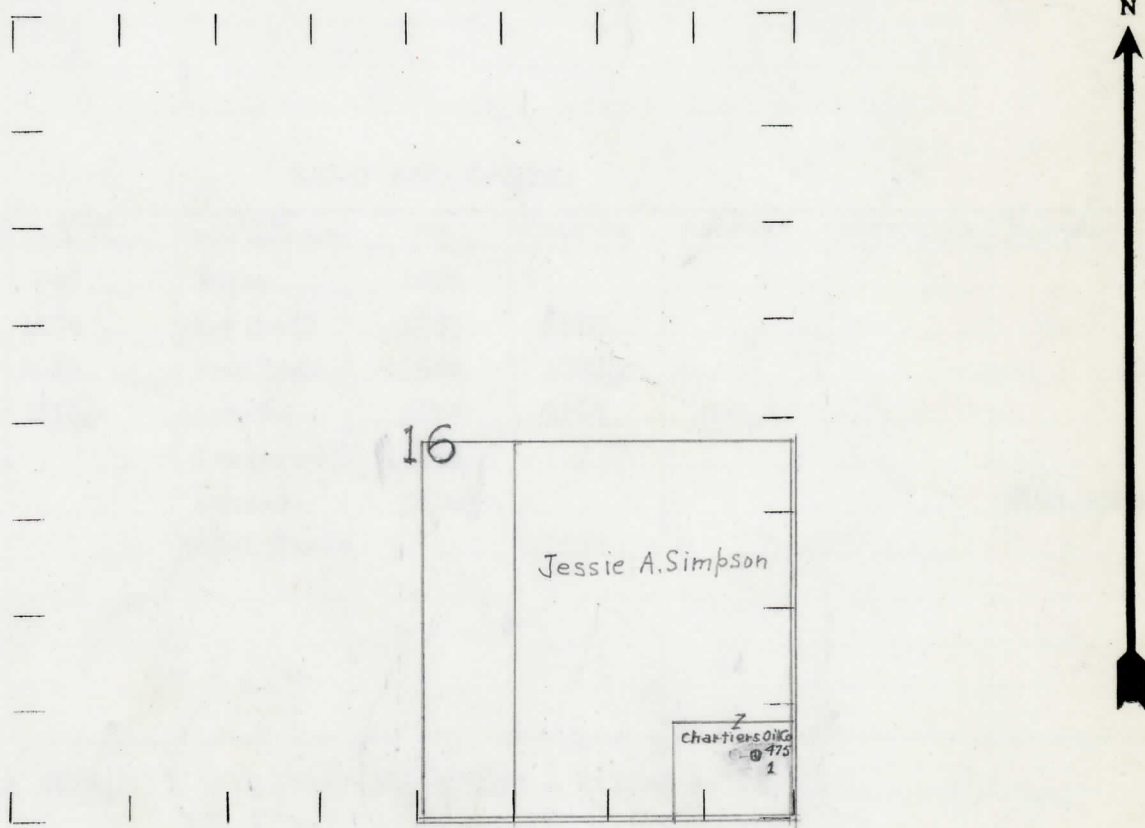

REMARKS:

SIGNED R. A. Yager
Superintendent or Foreman.

Michigan Producing DIVISION
COMPLETION RECORD

No. 475

DATE 9/20/34

STATE Michigan COUNTY Isabella DIST. TWP. Vernon SEC. 16 TOWN 16N RANGE 4W
PREC.

WELL No. 1 (SERIAL No. 475) FARM Jesse A. Simpson ACRES

NAME OF STREAM OR WATERS QUADRANGLE SE-SE-SE

OPERATOR The Chartiers Oil Company MAP Vernon Township, Isabella County

LOCATION REPORT SENT IN (DATE) 8/2/34

WELL STARTED (DATE) 7/31/34 WELL COMPLETED (DATE) 9/16/34

OIL WELL

GAS WELL

DRY HOLE

ABANDONED WELL

Elevation 877.5'

CROSS OUT THREE OF THE ABOVE
WELL RECORD

DATE OF SHOT NUMBER OF QUARTS

1st 24 HOURS PRODUCTION	DRY HOLE	BARRELS OR FEET
2nd " " "		" " "
3rd " " "		" " "
4th " " "		" " "
5th " " "		" " "

SAND AND CASING

CASING SIZE	WEIGHT	CASING Feet Inches	SAND Name and Nature	TOP	BOTTOM	TOP PAY	BOTTOM PAY	SALT WATER
10"		447	Stray	1425				
8 1/4"		1074	Marshall	1503	1586			
6-5/8"		1682	Red Rock	1586	1678 1/2			
5-3/16"		3816 1/2	Antrim	2624	3164			
			Traverse	3164				
			Dundee	3816 1/2				3856-3860
			Total Depth		3860			

REMARKS Show Gas 3816 1/2' Salt Water 3856-3860' - Filled up 2000'.