



Western Michigan University  
ScholarWorks at WMU

---

Legacy Scout Tickets from Pure Oil Company

---

8-20-2021

**MGRRE\_PureOilScoutTickets\_Ackerman\_1\_21073022580000**

MGRRE

*Western Michigan University*

Follow this and additional works at: <https://scholarworks.wmich.edu/pure>



Part of the Geology Commons

---

#### **WMU ScholarWorks Citation**

MGRRE, "MGRRE\_PureOilScoutTickets\_Ackerman\_1\_21073022580000" (2021). *Legacy Scout Tickets from Pure Oil Company*. 3271.

<https://scholarworks.wmich.edu/pure/3271>

This Document is brought to you for free and open access via ScholarWorks at WMU. It has been accepted for inclusion in Legacy Scout Tickets from Pure Oil Company by an authorized administrator of ScholarWorks at WMU. See the National Digital Catalogue - Science Base Catalogue for more collections submitted by MGRRE.



---

**MGRRE\_PureOilScoutTickets\_Ackerman\_1\_21073022580000**

API 21073022580000

Permit Number 2258

Lease Name Ackerman

Well Number 1

County Isabella

Township 16N

Range 04W

Section 12

2021 DEQ or Pure co\_name Penn Yan Investment Corporation

Pure Number 511

Latitude 43.79727

Longitude -84.74696

COMPLETION RECORD THE PURE OIL COMPANY OPERATORS

The Pure Oil Company

DATE 12/6/34

LOCATION REPORT

No. 511

STATE Michigan COUNTY Isabella DIST. Vernon TWP. Vernon SEC. 12 TOWN 16N RANGE 4W

WELL No. 1 (SERIAL No. 511) FARM A. E. Ackerman

NAME OF STREAM OR WATERS QUADRANGLE SW-NW-NW

OPERATOR Pen-Yan Investment Corporation Map Vernon Township, Isabella County

Feet from North Line of Farm

210 200 East

330 330 South

1120 1120 West

Feet from North Line of Section

East

South

330 330 West

LEGEND

- LOCATION, RIG, DRILLING, GAS WELL, OIL WELL, SMALL OIL WELL, DRY HOLE, DRY SHOWING OIL, DRY SHOWING GAS, ABANDONED LOCATION, ABANDONED GAS WELL, ABANDONED OIL WELL

NOTE: Below make tracing from map, (when no map is obtainable make sketch) showing farm, center of section, this location with measurements and also wells, dry holes, or other locations in the vicinity of this location.

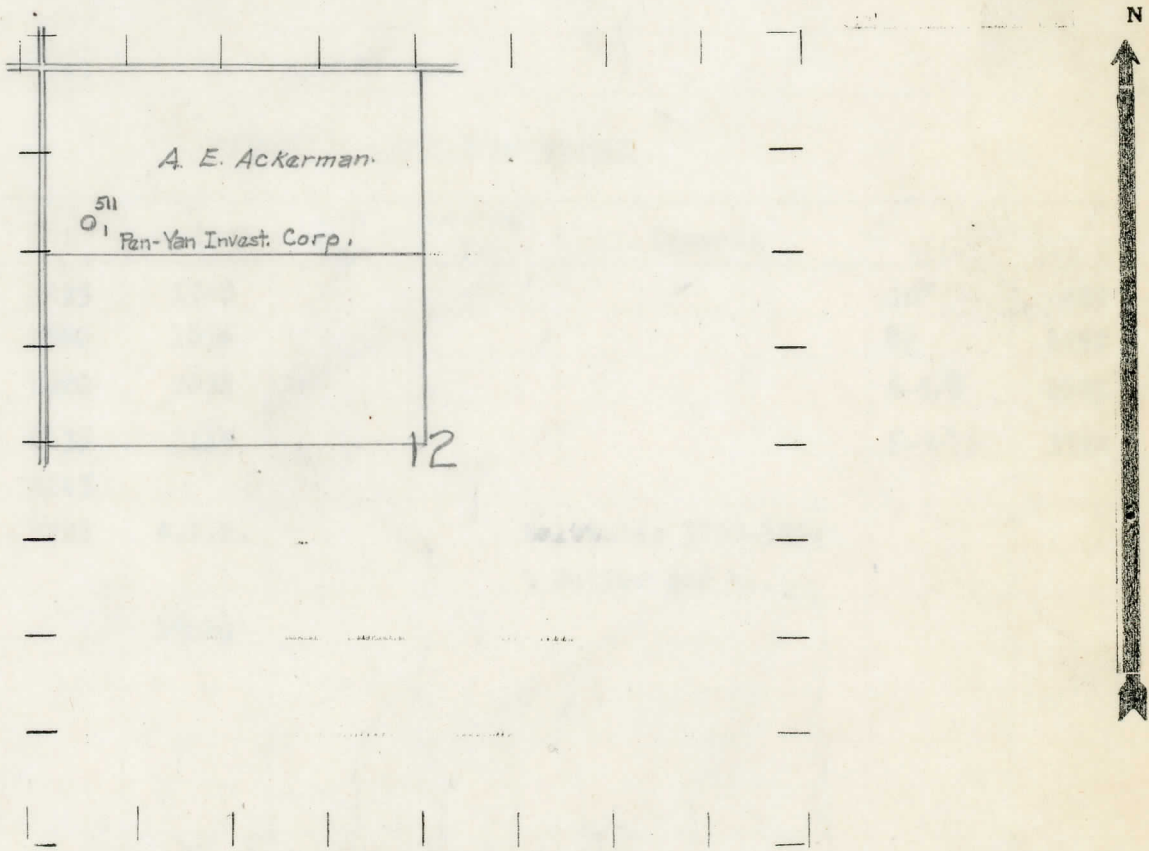

REMARKS:

SIGNED

R. L. Yeager

Superintendent or Foreman.

COMPLETION RECORD OF WELLS DRILLED BY OTHER OPERATORS

Michigan Producing Division

Date 2/28/35 No. 511  
 State Michigan County Isabella Dist. Vernon  
 (Serial No.) Twp. 12 Sec. 16N Rge. 4W  
 Well No. 1 (County No.) 511 Farm A. E. Ackerman Acres  
 Operator Pen-Yan Invest. Corp. Information secured <sup>by</sup> Scouting Department  
 Date well started 12/11/34 Date well completed 2/21/35 Elevation 846.6'

PRODUCTION RECORD

1st 24 hours natural Dry Hole  
 2nd 24 hours natural  
 Date of shot No. of quarts From to From to  
 Date of acid No. of gallons  
 shot  
 1st 24 hours after acid  
 shot  
 2nd 24 hours after acid

FORMATION AND CASING RECORD

Formation	Top	Bottom	Top Pay	Bottom Pay	Remarks	Casing	
						Size	Set at
Marshall	1435	1540				10"	429'
Red Rock	1540	1634				8 1/4"	1052
Berea	2620	2628				6-5/8"	1645
Antrim	2635	3115				5-3/16"	3794
Traverse	3115						
Dundee	3793	S.L.M.			Salt Water 3890-3894' 1 Bailer per hr.		
Total Depth		3894 1/2'					

Remarks

Signed G. H. Bell