



Western Michigan University
ScholarWorks at WMU

Legacy Scout Tickets from Pure Oil Company

8-20-2021

**MGRRE_PureOilScoutTickets_Pollard, John,
Estate_2_21073023260000**

MGRRE
Western Michigan University

Follow this and additional works at: <https://scholarworks.wmich.edu/pure>



Part of the Geology Commons

WMU ScholarWorks Citation

MGRRE, "MGRRE_PureOilScoutTickets_Pollard, John, Estate_2_21073023260000" (2021). *Legacy Scout Tickets from Pure Oil Company*. 3280.
<https://scholarworks.wmich.edu/pure/3280>

This Document is brought to you for free and open access via ScholarWorks at WMU. It has been accepted for inclusion in Legacy Scout Tickets from Pure Oil Company by an authorized administrator of ScholarWorks at WMU. See the National Digital Catalogue - Science Base Catalogue for more collections submitted by MGRRE.



MGRRE_PureOilScoutTickets_Pollard, John, Estate_2_21073023260000

API 21073023260000

Permit Number 2326

Lease Name Pollard, John, Estate

Well Number 2

County Isabella

Township 15N

Range 04W

Section 1

2021 DEQ or Pure co_name Summit Petroleum Corporation

Pure Number 520

Latitude 43.7138537

Longitude -84.7454394

THE PURE OIL COMPANY

DATE January 17, 1935

LOCATION REPORT

No. 520

STATE Michigan COUNTY Isabella

DIST. Isabella TWP. Isabella SEC. 1 TOWN. 15N RANGE 4W

WELL No. 2 (SERIAL No. 520) FARM John Pollard Estate

ACRES

NAME OF STREAM OR WATERS _____ QUADRANGLE C-5¹-5W-SW
C-8¹-SW SW

OPERATOR The Wittmer Company, Incorporated Map Isabella Township, Isabella County
The Wittmer Co. Isa - Isa.

_____ Feet from North Line of Farm

_____ " " East " " "

330 330 " " South " " "

660 660 " " West " " "

_____ Feet from North Line of Section

_____ " " East " " "

330 330 " " South " " "

660 660 " " West " " "

LEGEND

- LOCATION
- ⊕ RIG
- ⊕ DRILLING
- ☀ GAS WELL
- OIL WELL
- SMALL OIL WELL
- ⊖ DRY HOLE
- ⊖ DRY SHOWING OIL
- ⊖ DRY SHOWING GAS
- ⊖ ABANDONED LOCATION
- ⊖ ABANDONED GAS WELL
- ⊖ ABANDONED OIL WELL

NOTE: Below make tracing from map, (when no map is obtainable make sketch) showing farm, center of section, this location with measurements and also wells, dry holes, or other locations in the vicinity of this location.

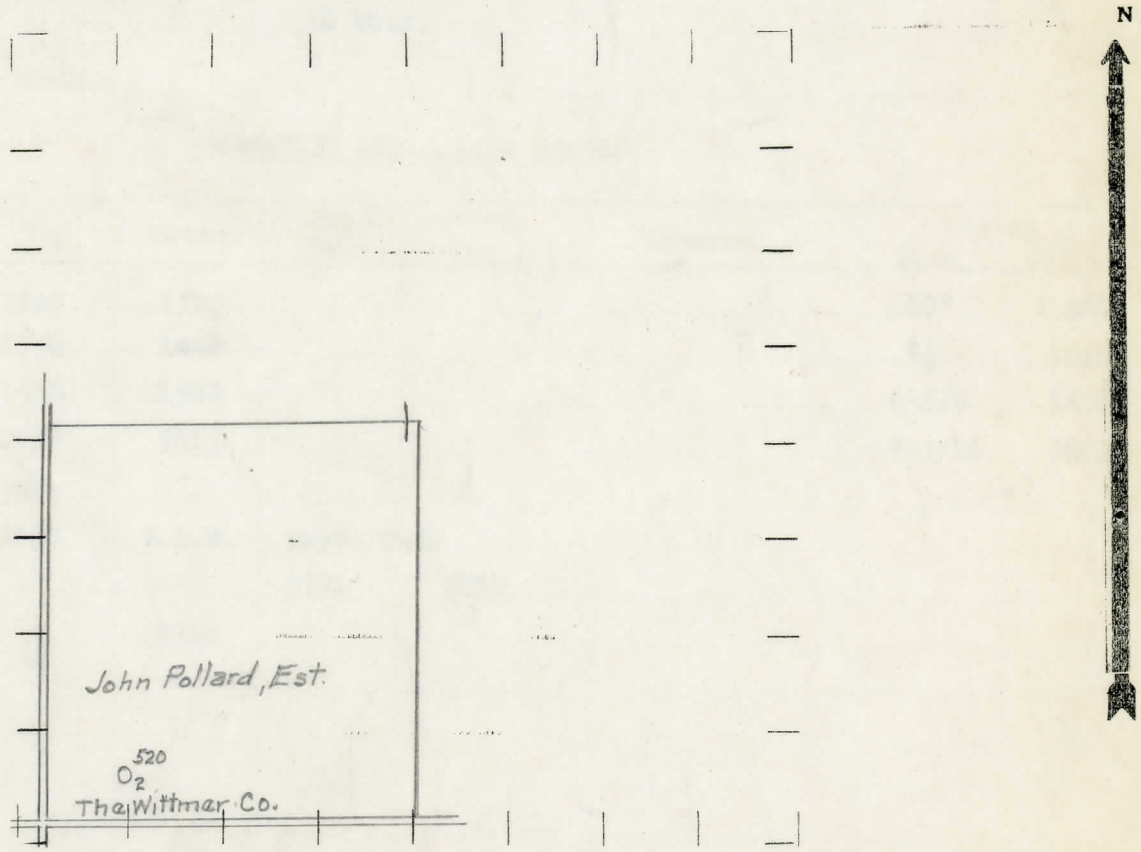

REMARKS:

SIGNED

R. L. Yeager

Superintendent or Foreman.

COMPLETION RECORD OF WELLS DRILLED BY OTHER OPERATORS

Michigan Producing Division

Date April 18, 1935 No. 520
 State Michigan County Isabella Dist. Isabella
 (Serial No.) Twp. Isabella Sec. 1 Twp. 15N Rge. 5 4W
 Well No. 1 (County No.) 520 Farm John Pollard Estate Acres
 Operator The Wittmer Company, Inc. Information secured ~~from~~ Scouting Department by
 Date well started 2/11/35 Date well completed 3/26/35 Elevation 734.7'

PRODUCTION RECORD

1st 24 hours natural Est. 10 bbls.
 2nd 24 hours natural
 Date of shot No. of quarts From to From to
 Date of acid 4/11/35 No. of gallons 1000
 shot
 1st 24 hours after acid 56 bbls.
 shot
 2nd 24 hours after acid

FORMATION AND CASING RECORD

Formation	Top	Bottom	Top Pay	Bottom Pay	Remarks	Casing	
						Size	Set at
Stray	1297	1320				10"	467'
Marshall	1359	1456				8 1/4"	1010
Red Rock	1456	1563				6-5/8"	1578
Antrim	2539	3013				5-3/16"	3669
Traverse	3013						
Dundee	3660	S.L.M.	3697	Show			
			3703	3710			
Total Depth		3711					

Remarks

Signed S. N. Bell