



Western Michigan University
ScholarWorks at WMU

Legacy Scout Tickets from Pure Oil Company

8-20-2021

**MGRRE_PureOilScoutTickets_Ervin, John &
Nellie_1_21073023740000**

MGRRE

Western Michigan University

Follow this and additional works at: <https://scholarworks.wmich.edu/pure>



Part of the Geology Commons

WMU ScholarWorks Citation

MGRRE, "MGRRE_PureOilScoutTickets_Ervin, John & Nellie_1_21073023740000" (2021). *Legacy Scout Tickets from Pure Oil Company*. 3291.

<https://scholarworks.wmich.edu/pure/3291>

This Document is brought to you for free and open access via ScholarWorks at WMU. It has been accepted for inclusion in Legacy Scout Tickets from Pure Oil Company by an authorized administrator of ScholarWorks at WMU. See the National Digital Catalogue - Science Base Catalogue for more collections submitted by MGRRE.



MGRRE_PureOilScoutTickets_Ervin, John & Nellie_1_21073023740000

API 21073023740000

Permit Number 2374

Lease Name Ervin, John & Nellie

Well Number 1

County Isabella

Township 15N

Range 04W

Section 13

2021 DEQ or Pure co_name Wittmer Oil and Gas Corporation

Pure Number 531

Latitude 43.68957

Longitude -84.73928

THE PURE OIL COMPANY

DATE March 7, 1935

LOCATION REPORT

No. 531

STATE Michigan COUNTY Isabella

DIST. Isabella
TWP. Isabella
PREC. John Ervin

13

15N.

4W.

SEC. 13

TOWN 15N

RANGE 4W

WELL No. 1 (SERIAL No. 531) FARM

John Ervin

ACRES

NAME OF STREAM OR WATERS

QUADRANGLE

C-E-NE-SW.
C-E-SW-SW

OPERATOR The Wittmer Company, Inc.

Map

Isabella Township, Isabella County

660 660 Feet from North Line of Farm

330 330 " " East " " "

" " South " " "

" " West " " "

660 660 Feet from North Line of Section

330 330 " " East " " "

" " South " " "

" " West " " "

LEGEND

○ LOCATION

⊙ RIG

⊕ DRILLING

☀ GAS WELL

● OIL WELL

⊙ SMALL OIL WELL

⊙ DRY HOLE

⊙ DRY SHOWING OIL

☀ DRY SHOWING GAS

⊙ ABANDONED LOCATION

☀ ABANDONED GAS WELL

⊙ ABANDONED OIL WELL

NOTE: Below make tracing from map. (when no map is obtainable make sketch) showing farm, center of section, this location with measurements and also wells, dry holes, or other locations in the vicinity of this location.

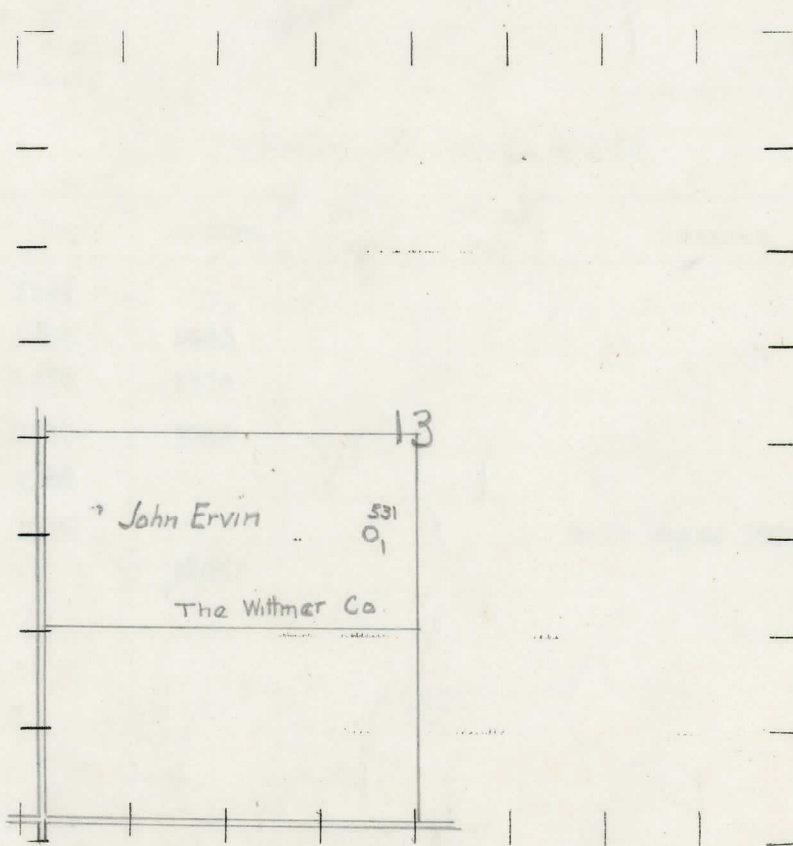

REMARKS:

SIGNED

R.L. Yeager

Superintendent or Foreman.

THE LURE OIL COMPANY
COMPLETION RECORD OF WELLS DRILLED BY OTHER OPERATORS

Michigan Producing Division

Date May 9, 1935 No. 531
 State Michigan County Isabella Twp. Isabella Dist. Isabella
 (Serial No.) Sec. 13 Twp. 15N Rge. 4W
 Well No. 1 (County No.) 531 Farm John Ervin Acres _____
 Operator The Wittmer Co., Inc. Information secured ~~from~~ Scouting Dept. by _____
 Date well started 3/12/35 Date well completed 5/4/35 Elevation 758'

PRODUCTION RECORD

1st 24 hours natural Dry Hole
 2nd 24 hours natural _____
 Date of shot _____ No. of quarts _____ From _____ to _____ From _____ to _____
 Date of acid _____ No. of gallons _____
 1st 24 hours after acid shot _____
 2nd 24 hours after acid shot _____

FORMATION AND CASING RECORD

Formation	Top	Bottom	Top Pay	Bottom Pay	Remarks	Casing	
						Size	Set at
Stray	1295					10"	606'
Marshall	1364	1480				5-3/16	3691'
Red Rock	1480	1574					
Antrim	2540	3046					
Traverse	3046						
Dundee	3685				Salt Water 3792-3805'		
Total Depth		3805'					

Remarks _____

Signed G.A. Bell