



Western Michigan University
ScholarWorks at WMU

Legacy Scout Tickets from Pure Oil Company

8-20-2021

MGRRE_PureOilScoutTickets_DeStoop_2_21073023960000

MGRRE

Western Michigan University

Follow this and additional works at: <https://scholarworks.wmich.edu/pure>



Part of the Geology Commons

WMU ScholarWorks Citation

MGRRE, "MGRRE_PureOilScoutTickets_DeStoop_2_21073023960000" (2021). *Legacy Scout Tickets from Pure Oil Company*. 3300.

<https://scholarworks.wmich.edu/pure/3300>

This Document is brought to you for free and open access via ScholarWorks at WMU. It has been accepted for inclusion in Legacy Scout Tickets from Pure Oil Company by an authorized administrator of ScholarWorks at WMU. See the National Digital Catalogue - Science Base Catalogue for more collections submitted by MGRRE.



MGRRE_PureOilScoutTickets_DeStoop_2_21073023960000

API 21073023960000

Permit Number 2396

Lease Name DeStoop

Well Number 2

County Isabella

Township 14N

Range 03W

Section 2

2021 DEQ or Pure co_name Melvin, John F.

Pure Number 540

Latitude 43.63627

Longitude -84.63193

COMPLETION REPORT THE PURE OIL COMPANY AND OTHER OPERATORS

DATE 4-4-35

LOCATION REPORT

No. 540

STATE Michigan

COUNTY Isabella

DIST. Chippewa

14N.

3W

WELL No. 2 (SERIAL No. 540) FARM

TWP. Chippewa

SEC. 2

TOWN 14-N RANGE 3-W

PREC. Fred De Stoop

ACRES

NAME OF STREAM OR WATERS

QUADRANGLE

NW-SE-NE
NW-SE-NE

OPERATOR J. F. Melvin

Map

Chippewa Twp., Isabella Co.

330 330 Feet from North Line of Farm

" " East " " "

330 330 " " South " " "

330 330 " " West " " "

Feet from North Line of Section

990 990 " " East " " "

990 990 " " South " 1/4 "

" " West " " "

LEGEND

○ LOCATION

⊕ RIG

⊕ DRILLING

☀ GAS WELL

● OIL WELL

⊕ SMALL OIL WELL

⊕ DRY HOLE

⊕ DRY SHOWING OIL

⊕ DRY SHOWING GAS

⊕ ABANDONED LOCATION

☀ ABANDONED GAS WELL

⊕ ABANDONED OIL WELL

NOTE: Below make tracing from map, (when no map is obtainable make sketch) showing farm, center of section, this location with measurements and also wells, dry holes, or other locations in the vicinity of this location.

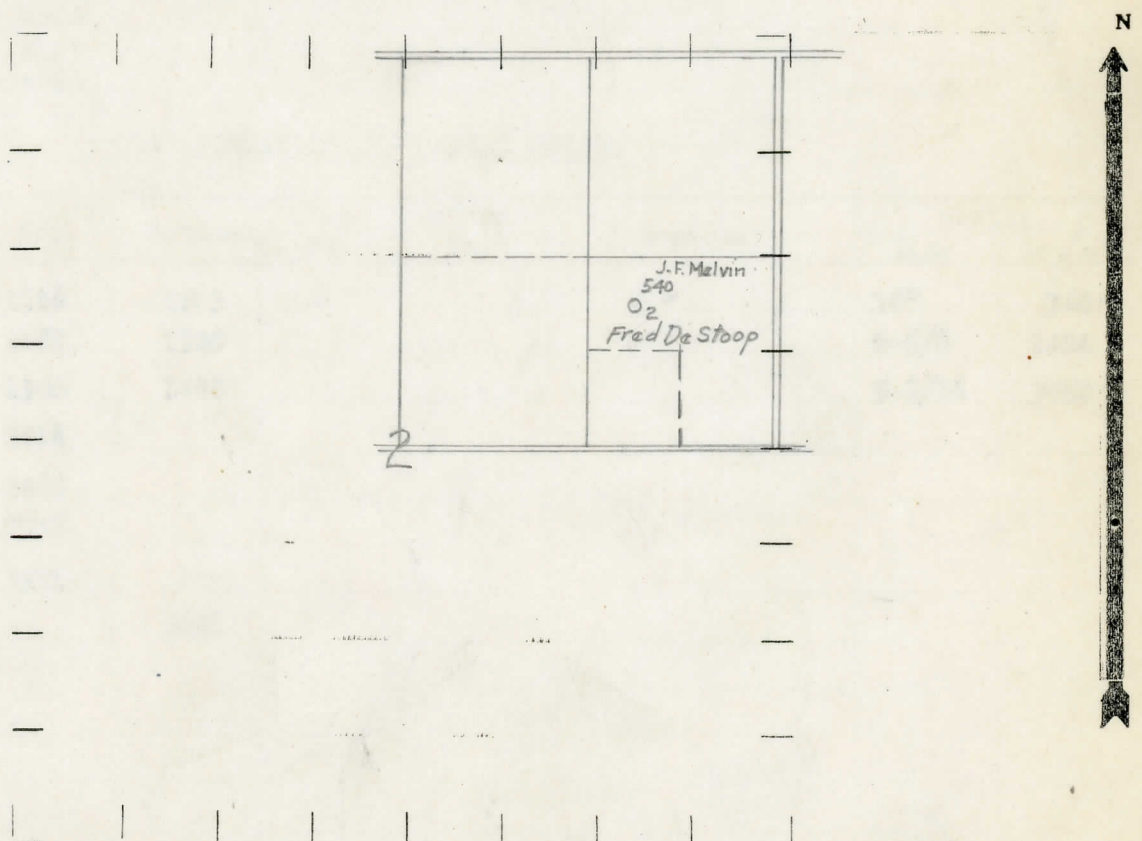

REMARKS:

SIGNED

R. A. Yeager

Superintendent or Foreman.

Michigan Producing Division

Date 8/1/35 No. 540
 State Michigan County Isabella Dist. Chippewa
 (Serial No.) Twp. 14N Rge. 3W
 Well No. 2 (County No.) 540 Farm Fred DeStoop Acres
 Operator John F. Melvin Information secured ~~from~~ by Scouting Department
 Date well started 4/5/35 Date well completed 7/30/35 Elevation 724.9'

PRODUCTION RECORD

1st 24 hours natural Dry Hole
 2nd 24 hours natural
 Date of shot No. of quarts From to From to
 Date of acid No. of gallons
 shot
 1st 24 hours after acid
 shot
 2nd 24 hours after acid

FORMATION AND CASING RECORD

Formation	Top	Bottom	Top Pay	Bottom Pay	Remarks	Casing	
						Size	Set at
Stray	1136	1143				10"	340'
Marshall	1157	1320				6-5/8	1424
Red Rock	1320	1400				5-3/16	3552
Sunbury	2418						
Antrim	2467						
Traverse	2945						
Dundee	3571						
Total Depth		3621					

Remarks Show Oil & Gas 3230-3240' - Show Oil & Gas 3584' - Salt Water 3620' filled up 400' in 12 hours.

Signed E. H. Bell