



Western Michigan University
ScholarWorks at WMU

Legacy Scout Tickets from Pure Oil Company

8-20-2021

MGRRE_PureOilScoutTickets_Graham_1_21073024680000

MGRRE

Western Michigan University

Follow this and additional works at: <https://scholarworks.wmich.edu/pure>



Part of the Geology Commons

WMU ScholarWorks Citation

MGRRE, "MGRRE_PureOilScoutTickets_Graham_1_21073024680000" (2021). *Legacy Scout Tickets from Pure Oil Company*. 3311.

<https://scholarworks.wmich.edu/pure/3311>

This Document is brought to you for free and open access via ScholarWorks at WMU. It has been accepted for inclusion in Legacy Scout Tickets from Pure Oil Company by an authorized administrator of ScholarWorks at WMU. See the National Digital Catalogue - Science Base Catalogue for more collections submitted by MGRRE.



MGRRE_PureOilScoutTickets_Graham_1_21073024680000

API 21073024680000

Permit Number 2468

Lease Name Graham

Well Number 1

County Isabella

Township 15N

Range 03W

Section 28

2021 DEQ or Pure co_name Gordon Oil Company

Pure Number 551

Latitude 43.65986

Longitude -84.68173

The Pure Oil Company
COMPLETION RECORD BY OTHER OPERATORS

DATE May 2, 1935

LOCATION REPORT

No. 551

Isabella Division 28

15N 3W

STATE Michigan COUNTY Isabella DIST. Denver TWP. Denver SEC. 28 TOWN 15N RANGE 3W

WELL No. 1 (SERIAL No. 551) FARM Edgar O. Graham ACRES

NAME OF STREAM OR WATERS QUADRANGLE SW-NE-SW
SW-NE-SW

OPERATOR Gordon Oil Company Map Denver Township, Isabella County
Gordon Oil Co Denver - Isa.

Feet from North Line of Farm

990 990 " " East " " "

330 330 " " South " " "

" " West " " "

990 990 Feet from North Line of Section

990 990 " " East " " 1/4

" " South " " "

" " West " " "

LEGEND

- LOCATION
- ⊕ DRILLING
- ⊗ GAS WELL
- OIL WELL
- ⊙ SMALL OIL WELL
- ⊖ DRY HOLE
- ⊙ DRY SHOWING OIL
- ⊗ DRY SHOWING GAS
- ⊖ ABANDONED LOCATION
- ⊗ ABANDONED GAS WELL
- ⊙ ABANDONED OIL WELL

NOTE: Below make tracing from map, (when no map is obtainable make sketch) showing farm, center of section, this location with measurements and also wells, dry holes, or other locations in the vicinity of this location.

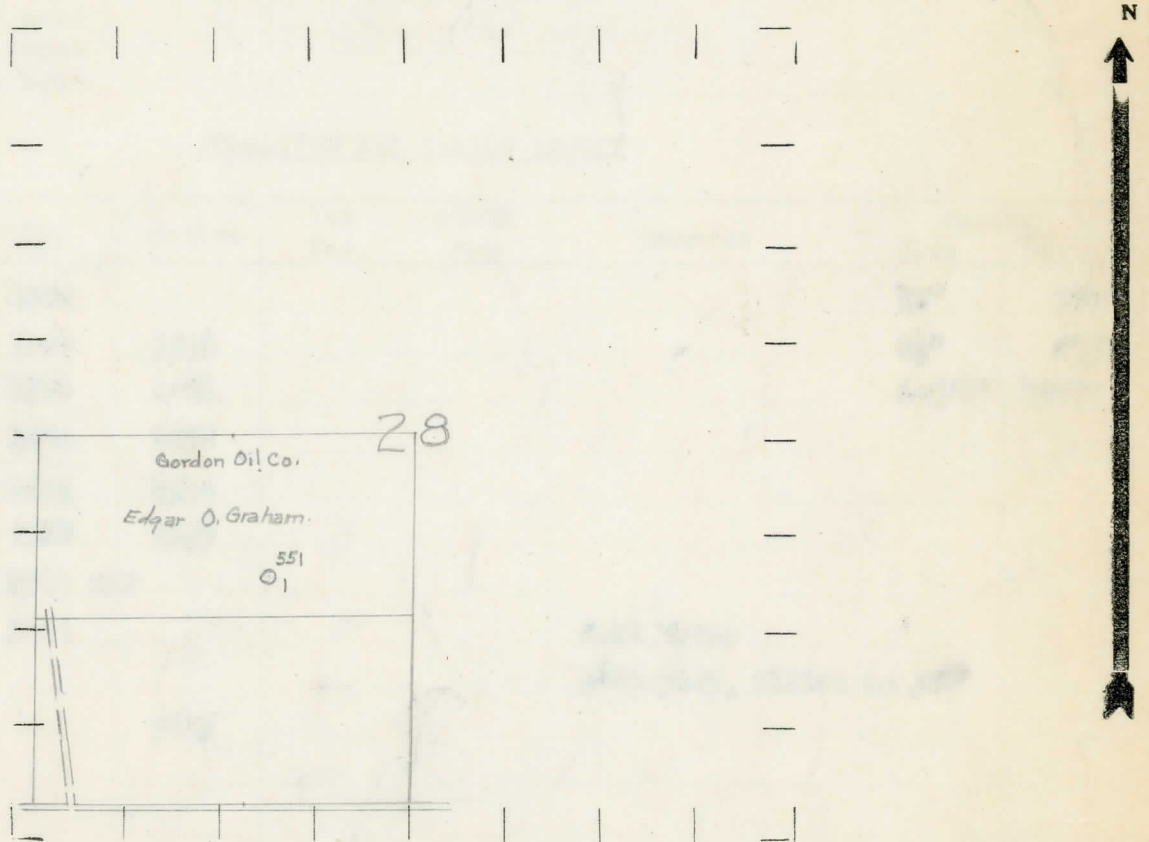

REMARKS:

SIGNED

R. d. Yeager

Superintendent or Foreman.

COMPLETION RECORD OF WELLS DRILLED BY OTHER OPERATORS

Me

Michigan Producing Division

Date 6/27/35 No. 551
 State Michigan County Isabella Dist. _____
 (Serial No.) Twp. Denver Sec. 28 Twp. 15-N Rge. 3-W
 Well No. 1 (County No.) 551 Farm E. O. Graham Acres _____
 Operator Gordon Oil Company Information secured from Scouting Dept. by _____
 Date well started 5-9-35 Date well completed 6-22-35 Elevation 723.5

PRODUCTION RECORD

1st 24 hours natural Dry Hole
 2nd 24 hours natural _____
 Date of shot _____ No. of quarts _____ From _____ to _____ From _____ to _____
 Date of acid _____ No. of gallons _____
 1st 24 hours after acid shot _____
 2nd 24 hours after acid shot _____

FORMATION AND CASING RECORD

Formation	Top	Bottom	Top Pay	Bottom Pay	Remarks	Casing	
						Size	Set at
Stray	1224					10"	320'
Marshall	1290	1376				8 1/4"	935'
Red Rock	1376	1482				6-5/8"	1507'
Sumbury	2446	2475					
Berea	2475	2510					
Antrim	2510	2989					
Traverse	2989	SLM					
Dundee	3602				Salt Water		
					3643-3645, filled up 300'		
Total Depth		3645					

Remarks _____

Signed S. H. Bell