



Western Michigan University
ScholarWorks at WMU

Legacy Scout Tickets from Pure Oil Company

8-20-2021

MGRRE_PureOilScoutTickets_Taylor_1_21073026350000

MGRRE

Western Michigan University

Follow this and additional works at: <https://scholarworks.wmich.edu/pure>



Part of the Geology Commons

WMU ScholarWorks Citation

MGRRE, "MGRRE_PureOilScoutTickets_Taylor_1_21073026350000" (2021). *Legacy Scout Tickets from Pure Oil Company*. 3329.

<https://scholarworks.wmich.edu/pure/3329>

This Document is brought to you for free and open access via ScholarWorks at WMU. It has been accepted for inclusion in Legacy Scout Tickets from Pure Oil Company by an authorized administrator of ScholarWorks at WMU. See the National Digital Catalogue - Science Base Catalogue for more collections submitted by MGRRE.



MGRRE_PureOilScoutTickets_Taylor_1_21073026350000

API 21073026350000

Permit Number 2635

Lease Name Taylor

Well Number 1

County Isabella

Township 15N

Range 03W

Section 18

2021 DEQ or Pure co_name Null, D. W. and Funk, T. H.

Pure Number 569

Latitude 43.69437

Longitude -84.7268

DATE July 26, 1935

LOCATION REPORT

No. 569 569

STATE Mich COUNTY Isabella DIST. Denver TWP. Denver SEC. 18 TOWN 15N RANGE 3W

WELL No. 1 (SERIAL No. 569) FARM J.H. Taylor, H. Tayloy ACRES

NAME OF STREAM OR WATERS QUADRANGLE NW-SW-NW

OPERATOR D. W. Null & T. H. Funk Map Denver Twp. - Isabella Co.

330 330 Feet from North Line of Farm

“ “ East “ “ “

“ “ South “ “ “

330 330 “ “ West “ “ “

Feet from North Line of Section

“ “ East “ “ “

330 330 “ “ South “ “ 1/4 “

330 330 “ “ West “ “ 1/4 “

LEGEND

- LOCATION
- ⊕ RIG
- ⊕ DRILLING
- ☀ GAS WELL
- OIL WELL
- SMALL OIL WELL
- ⊖ DRY HOLE
- ⊖ DRY SHOWING OIL
- ⊖ DRY SHOWING GAS
- ⊖ ABANDONED LOCATION
- ☀ ABANDONED GAS WELL
- ABANDONED OIL WELL

NOTE: Below make tracing from map, (when no map is obtainable make sketch) showing farm, center of section, this location with measurements and also wells, dry holes, or other locations in the vicinity of this location.

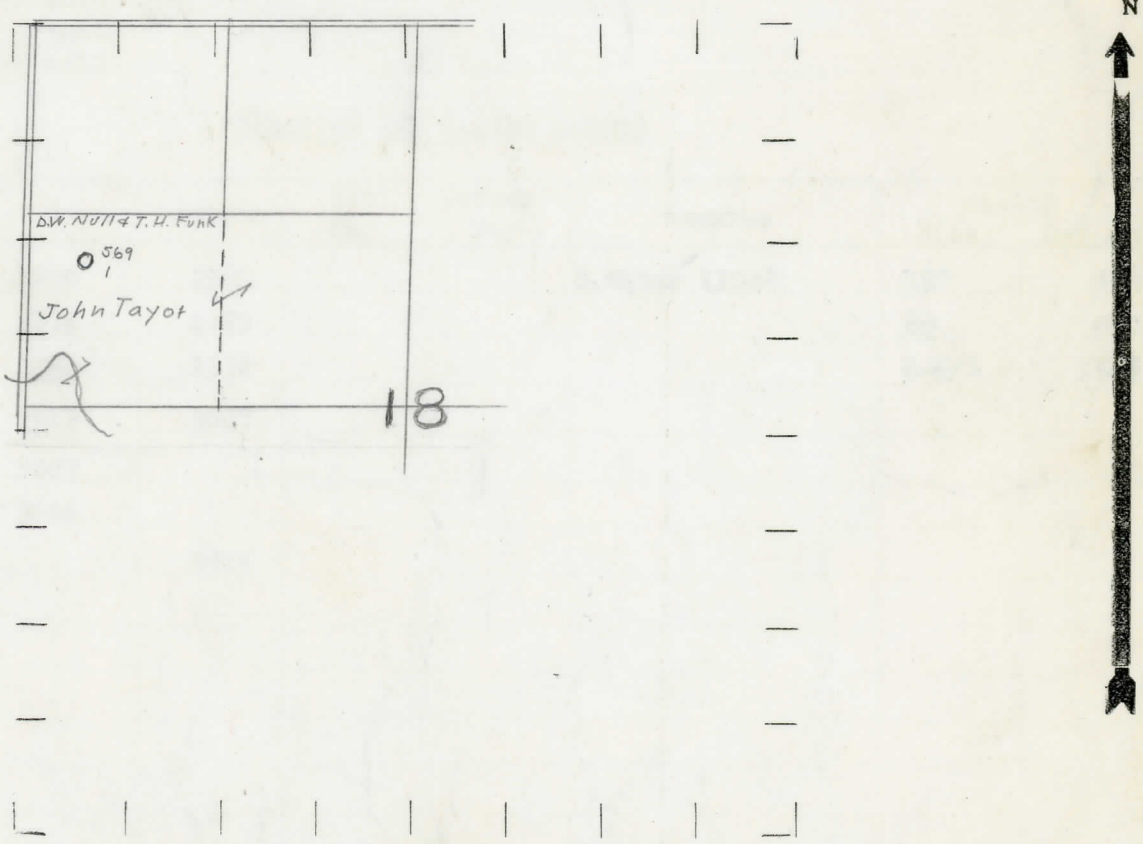

REMARKS:

SIGNED R.A. Yeager
Superintendent or Foreman.

Per # 2635

THE LUBE OIL COMPANY
COMPLETION RECORD OF WELLS DRILLED BY OTHER OPERATORS

Michigan Producing Division

Date October 3, 1935 No. 569
 State Michigan County Isabella Dist. _____
 (Serial No.) Twp. Denver Sec. 18 Twp. 15N Rge. 3W
 Well No. 1 (County No.) 569 Farm J. H. Taylor Acres _____
 Operator Null & Funk Information secured ~~from~~ by Scouting Dept.
 Date well started 8/14/35 Date well completed 9/28/35 Elevation 755.4'

PRODUCTION RECORD

1st 24 hours natural Dry Hole
 2nd 24 hours natural _____
 Date of shot _____ No. of quarts _____ From _____ to _____ From _____ to _____
 Date of acid _____ No. of gallons _____
 shot _____
 1st 24 hours after acid _____
 shot _____
 2nd 24 hours after acid _____

FORMATION AND CASING RECORD

Formation	Top	Bottom	Top Pay	Bottom Pay	Remarks	Casing	
						Size	Set at
Stray	1290	1320			S. Water 1300'	10"	488'
Marshall	1335	1452				8 1/4"	960
Red Rock	1452	1532				6-5/8"	1548
Antrim	2513	3007					
Traverse	3007						
Dundee	3664						
Total Depth		3715					

Remarks Show Oil & S. Water 3710' - 1 1/2 Barrels ~~oil~~ Oil, 10 bbls. S. Water

Signed G. H. Bell