



Legacy Scout Tickets from Pure Oil Company

---

8-20-2021

**MGRRE\_PureOilScoutTickets\_Regan,  
Timothy\_2\_21073026750000**

MGRRE  
*Western Michigan University*

Follow this and additional works at: <https://scholarworks.wmich.edu/pure>



Part of the Geology Commons

---

#### **WMU ScholarWorks Citation**

MGRRE, "MGRRE\_PureOilScoutTickets\_Regan, Timothy\_2\_21073026750000" (2021). *Legacy Scout Tickets from Pure Oil Company*. 3330.  
<https://scholarworks.wmich.edu/pure/3330>

This Document is brought to you for free and open access via ScholarWorks at WMU. It has been accepted for inclusion in Legacy Scout Tickets from Pure Oil Company by an authorized administrator of ScholarWorks at WMU. See the National Digital Catalogue - Science Base Catalogue for more collections submitted by MGRRE.



---

**MGRRE\_PureOilScoutTickets\_Regan, Timothy\_2\_21073026750000**

API 21073026750000

Permit Number 2675

Lease Name Regan, Timothy

Well Number 2

County Isabella

Township 16N

Range 04W

Section 25

2021 DEQ or Pure co\_name Atha, Hunter

Pure Number 570

Latitude 43.74791

Longitude -84.74051

The Pure Oil Company  
COMPLETION RECORD OF WELLS DRILLED BY OTHER OPERATORS  
THE PURE OIL COMPANY

DATE August 15, 1935  
8-15-35

LOCATION REPORT

No. 570

STATE Mich COUNTY Isabella DIST. Vernon TWP. Vernon SEC. 25 TOWN 16-N RANGE 4-W

WELL No. 2 (SERIAL No. 570) FARM Timothy Regan ACRES

NAME OF STREAM OR WATERS QUADRANGLE C-NE-SW

OPERATOR W. Hunter Atha Map Vernon Twp., Isabella Co.

6660 Feet from North Line of Farm

6660 " " East " " "

" " South " " "

" " West " " "

6660 Feet from North Line of Section

6660 " " East " " "

" " South " " "

" " West " " "

LEGEND

- LOCATION
- ⊕ RIG
- ⊕ DRILLING
- ☀ GAS WELL
- OIL WELL
- SMALL OIL WELL
- ⊙ DRY HOLE
- DRY SHOWING OIL
- ☀ DRY SHOWING GAS
- ⊙ ABANDONED LOCATION
- ☀ ABANDONED GAS WELL
- ABANDONED OIL WELL

NOTE: Below make tracing from map, (when no map is obtainable make sketch) showing farm, center of section, this location with measurements and also wells, dry holes, or other locations in the vicinity of this location.

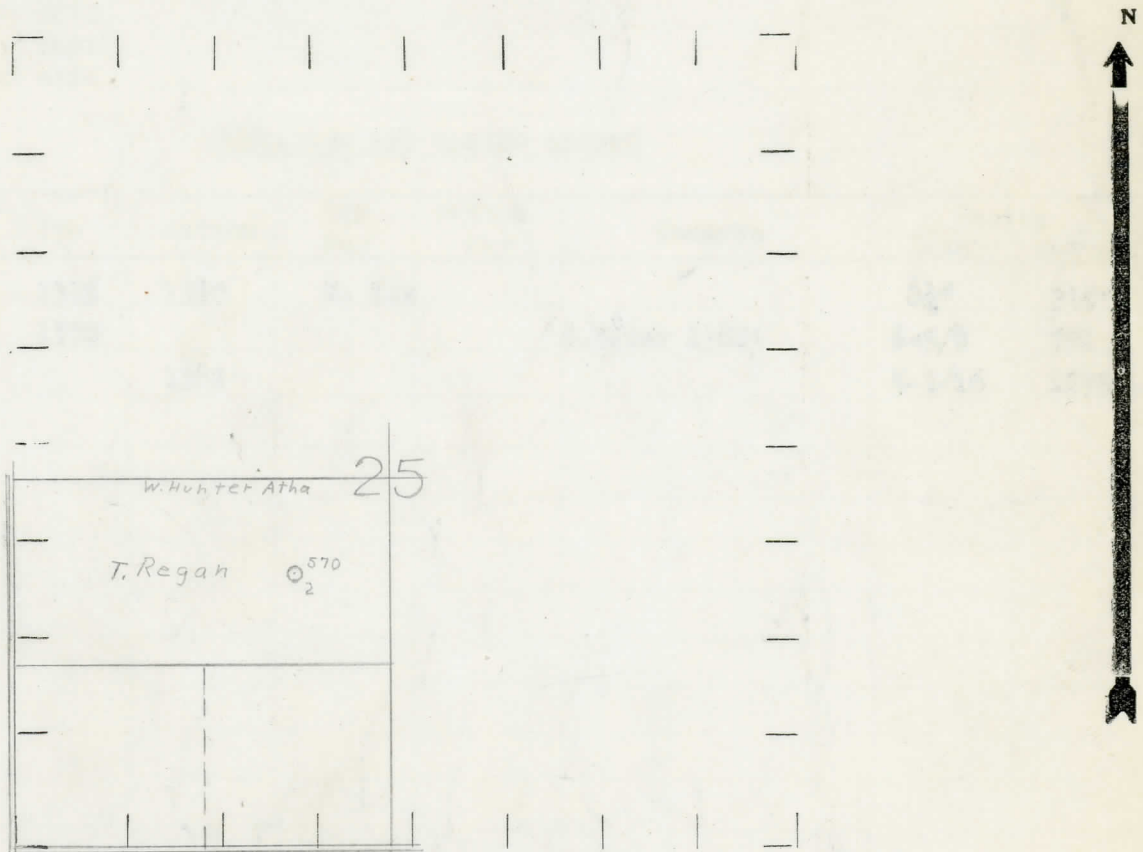

REMARKS:

SIGNED

*R. L. Yeager*  
Superintendent or Foreman.

Per # 2675

