



Western Michigan University
ScholarWorks at WMU

Legacy Scout Tickets from Pure Oil Company

8-20-2021

MGRRE_PureOilScoutTickets_Bishop, Oliver_1_21073036970000

MGRRE

Western Michigan University

Follow this and additional works at: <https://scholarworks.wmich.edu/pure>



Part of the Geology Commons

WMU ScholarWorks Citation

MGRRE, "MGRRE_PureOilScoutTickets_Bishop, Oliver_1_21073036970000" (2021). *Legacy Scout Tickets from Pure Oil Company*. 3393.

<https://scholarworks.wmich.edu/pure/3393>

This Document is brought to you for free and open access via ScholarWorks at WMU. It has been accepted for inclusion in Legacy Scout Tickets from Pure Oil Company by an authorized administrator of ScholarWorks at WMU. See the National Digital Catalogue - Science Base Catalogue for more collections submitted by MGRRE.



MGRRE_PureOilScoutTickets_Bishop, Oliver_1_21073036970000

API 21073036970000

Permit Number 3697

Lease Name Bishop, Oliver

Well Number 1

County Isabella

Township 15N

Range 06W

Section 28

2021 DEQ or Pure co_name Rowmor Corporation

Pure Number 640

Latitude 43.66213

Longitude -85.04332

THE PURE OIL COMPANY

DATE November 27, 1936

LOCATION REPORT

No. 640

STATE Michigan COUNTY Isabella

DIST. Sherman TWP. Sherman

SEC. 28

TOWN 15 N RANGE 6 W

WELL No. 1 (SERIAL No. 640) FARM

PREC. Oliver Bishop

ACRES

NAME OF STREAM OR WATERS

QUADRANGLE SE-SW-NW
SE SW NW

OPERATOR Rowmar Corporation

Map Sherman Township, Isabella County

Rowmar Corp.

Sherman-Isa Co.

Feet from North Line of Farm

217217 " " East " " "

330330 " " South " " "

" " West " " "

Feet from North Line of Section

" " East " " "

330330 " " South " " "

11031103 " " West " " "

LEGEND

- LOCATION
- ⊕ RIG
- ⊕ DRILLING
- ☀ GAS WELL
- OIL WELL
- ⬮ SMALL OIL WELL
- ⊙ DRY HOLE
- ⬮ DRY SHOWING OIL
- ⊙ DRY SHOWING GAS
- ⊙ ABANDONED LOCATION
- ☀ ABANDONED GAS WELL
- ⬮ ABANDONED OIL WELL

NOTE: Below make tracing from map, (when no map is obtainable make sketch) showing farm, center of section, this location with measurements and also wells, dry holes, or other locations in the vicinity of this location.

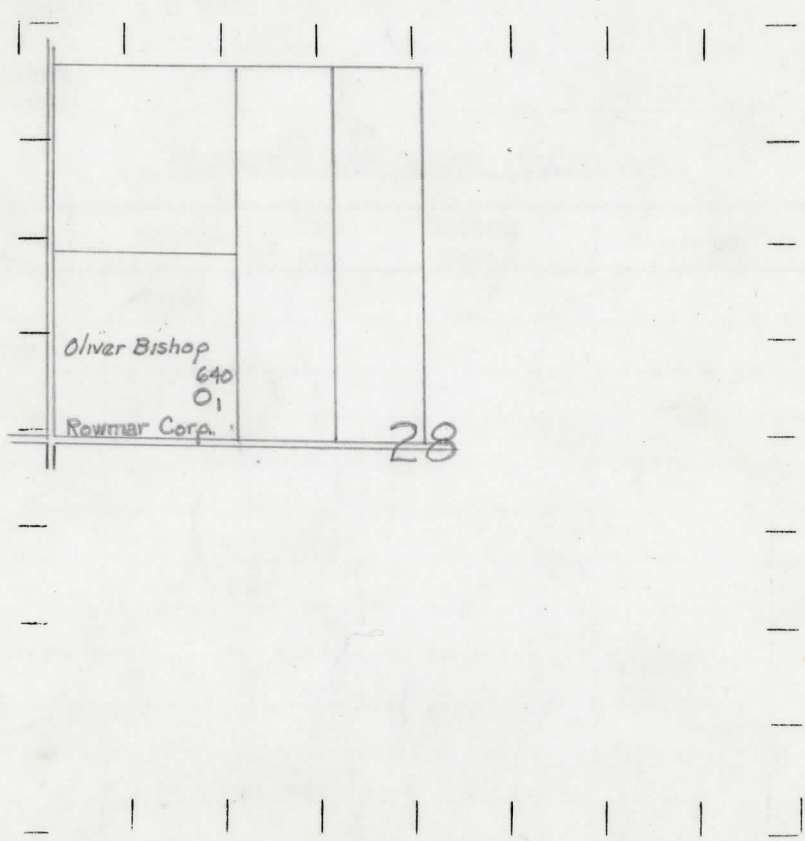

REMARKS:

SIGNED

R. L. Yeager
Superintendent or Foreman

COMPLETION RECORD OF WELLS DRILLED BY OTHER OPERATORS

Michigan Producing Division

Date March 11, 1937 No. 640
 State Michigan County Isabella Dist. Twp. Sherman Sec. 28 Twp. 15 N Rge. 6 W
 Well No. 1 (Serial No.) (County No.) 640 Farm Oliver Bishop Acres _____
 Operator Rovnor Corporation Information secured ~~from~~ ^{by} Scouting Department
 Date well started 12-19-36 Date well completed 1-7-37 Elevation 1021.8

PRODUCTION RECORD

1st 24 hours natural Dry Hole
 2nd 24 hours natural _____
 Date of shot _____ No. of quarts _____ From _____ to _____ From _____ to _____
 Date of acid _____ No. of gallons _____
 1st 24 hours after acid _____ shot
 2nd 24 hours after acid _____ shot

FORMATION AND CASING RECORD

Formation	Top	Bottom	Top Pay	Bottom Pay	Remarks	Casing	
						Size	Set At
Total Depth		1050				8-1/4"	1050

Remarks Considered low and abandoned above Marshall.

Signed _____ Geo. H. Bell