



Western Michigan University
ScholarWorks at WMU

Legacy Scout Tickets from Pure Oil Company

8-20-2021

MGRRE_PureOilScoutTickets_Hicks, John C Estate_1_21073037060000

MGRRE

Western Michigan University

Follow this and additional works at: <https://scholarworks.wmich.edu/pure>



Part of the Geology Commons

WMU ScholarWorks Citation

MGRRE, "MGRRE_PureOilScoutTickets_Hicks, John C Estate_1_21073037060000" (2021). *Legacy Scout Tickets from Pure Oil Company*. 3394.

<https://scholarworks.wmich.edu/pure/3394>

This Document is brought to you for free and open access via ScholarWorks at WMU. It has been accepted for inclusion in Legacy Scout Tickets from Pure Oil Company by an authorized administrator of ScholarWorks at WMU. See the National Digital Catalogue - Science Base Catalogue for more collections submitted by MGRRE.



MGRRE_PureOilScoutTickets_Hicks, John C Estate_1_21073037060000

API 21073037060000

Permit Number 3706

Lease Name Hicks, John C Estate

Well Number 1

County Isabella

Township 15N

Range 06W

Section 35

2021 DEQ or Pure co_name Smith, Maynard L.

Pure Number 641

Latitude 43.64777

Longitude -85.00639

THE PURE OIL COMPANY

DATE November 27, 1936 LOCATION REPORT No. 641
 STATE Michigan COUNTY Isabella DIST. Sherman TWP. Sherman SEC. 35 TOWN. 15 N. RANGE 6 W.
 WELL No. 1 (SERIAL No. 641) FARM John C. Hicks, Estate ACRES
 NAME OF STREAM OR WATERS _____ QUADRANGLE SW-SW-NW. SW SW NW

OPERATOR Maynard L. Smith, Trustee Map Sherman Township, Isabella County
990 990 Maynard L. Smith, Trustee Sherman - Isa. Co.

_____ Feet from North Line of Farm
 " " East " " "
 " " South " " "
330330 " " West " " "
 _____ Feet from North Line of Section
 " " East " " "
330330 " " South " 1/4 "
330330 " " West " " "

- LEGEND**
- LOCATION
 - ⊕ RIG
 - ⊕ DRILLING
 - ☀ GAS WELL
 - OIL WELL
 - ⊕ SMALL OIL WELL
 - ⊕ DRY HOLE
 - ⊕ DRY SHOWING OIL
 - ☀ DRY SHOWING GAS
 - ⊕ ABANDONED LOCATION
 - ☀ ABANDONED GAS WELL
 - ⊕ ABANDONED OIL WELL

NOTE: Below make tracing from map, (when no map is obtainable make sketch) showing farm, center of section, this location with measurements and also wells, dry holes, or other locations in the vicinity of this location.

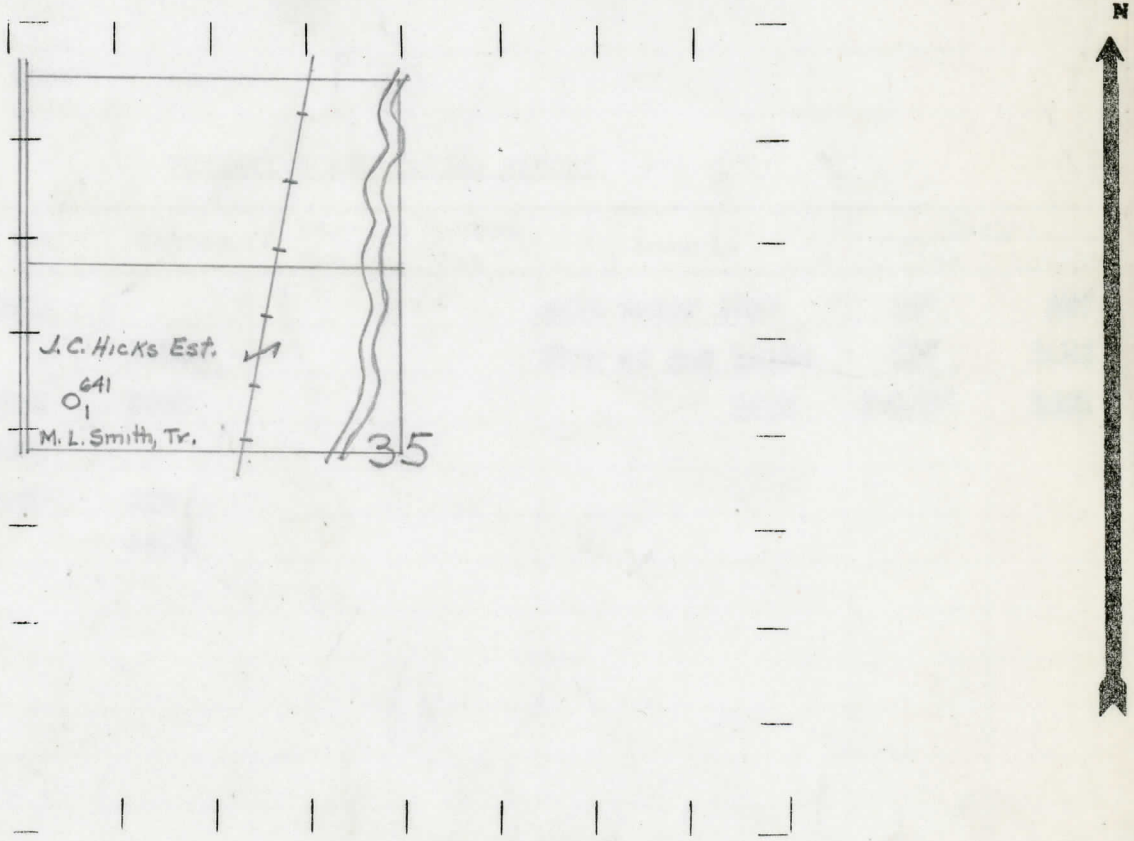

REMARKS:

SIGNED R. L. Yeager
 Superintendent or Foreman. §

THE ROCK OIL COMPANY

COMPLETION RECORD OF WELLS DRILLED BY OTHER OPERATORS

Michigan Producing Division

Date February 11, 1937 No. 641
 State Michigan County Isabella Dist. _____
 (Serial No.) Twp. Sherman Sec. 35 Twp. 15 N Rge. 6 W
 Well No. 1 (County No.) 641 Farm John C. Hicks Estate Acres _____
 Operator Maynard L. Smith, Tr. Information secured ~~from~~ Scouting Department by _____
 Date well started 12-5-36 Date well completed 2-5-37 Elevation 915.4

PRODUCTION RECORD

1st 24 hours natural Dry Hole
 2nd 24 hours natural _____
 Date of shot _____ No. of quarts _____ From _____ to _____ From _____ to _____
 Date of acid _____ No. of gallons _____
 shot _____
 1st 24 hours after acid _____
 shot _____
 2nd 24 hours after acid _____

FORMATION AND CASING RECORD

Formation	Top	Bottom	Top Pay	Bottom Pay	Remarks	Casing	
						Size	Set At
Marshall	1361				salt water 1390	14"	527
Red Rock		1655			Show of gas 1615-	8 1/4"	1025
Antrim	2535	3080			1618	6-5/8"	1661
Traverse	3080						
Monroe	3640	CTM					
Total Depth		3656					

Remarks Rainbow of oil and show salt water 3648-3652-salt water 3654-3656-filled up 75' in 1-1/2 hours.

Signed Geo. H. Bell