



Western Michigan University
ScholarWorks at WMU

Legacy Scout Tickets from Pure Oil Company

8-20-2021

MGRRE_PureOilScoutTickets_Cotter, F._1_21073042550000

MGRRE

Western Michigan University

Follow this and additional works at: <https://scholarworks.wmich.edu/pure>



Part of the Geology Commons

WMU ScholarWorks Citation

MGRRE, "MGRRE_PureOilScoutTickets_Cotter, F._1_21073042550000" (2021). *Legacy Scout Tickets from Pure Oil Company*. 3423.

<https://scholarworks.wmich.edu/pure/3423>

This Document is brought to you for free and open access via ScholarWorks at WMU. It has been accepted for inclusion in Legacy Scout Tickets from Pure Oil Company by an authorized administrator of ScholarWorks at WMU. See the National Digital Catalogue - Science Base Catalogue for more collections submitted by MGRRE.



MGRRE_PureOilScoutTickets_Cotter, F._1_21073042550000

API 21073042550000

Permit Number 4255

Lease Name Cotter, F.

Well Number 1

County Isabella

Township 15N

Range 05W

Section 11

2021 DEQ or Pure co_name Weller C. E.

Pure Number 699

Latitude 43.71168

Longitude -84.86976

THE PURE OIL COMPANY
LOCATION REPORT

DATE June 17, 1937

No. 699

STATE Michigan COUNTY Isabella DIST. Nottawa TWP. Nottawa SEC. 11 TOWN 15 N RANGE 5 W

WELL No. 1 (SERIAL No. 699) FARM F. Cotter ACRES

NAME OF STREAM OR WATERS QUADRANGLE NE-NE-NE

OPERATOR C. E. Weller Map Nottawa Township, Isabella County

330 330 Feet from North Line of Farm

330 330 " " East " " "

" " South " " "

" " West " " "

330 330 Feet from North Line of Section

330 330 " " East " " "

" " South " " "

" " West " " "

- LEGEND**
- LOCATION
 - ⊕ RIG
 - ⊕ DRILLING
 - ☀ GAS WELL
 - OIL WELL
 - ⊕ SMALL OIL WELL
 - ⊕ DRY HOLE
 - ⊕ DRY SHOWING OIL
 - ☀ DRY SHOWING GAS
 - ⊕ ABANDONED LOCATION
 - ☀ ABANDONED GAS WELL
 - ABANDONED OIL WELL

NOTE: Below make tracing from map, (when no map is obtainable make sketch) showing farm, center of section, this location with measurements and also wells, dry holes, or other locations in the vicinity of this location.

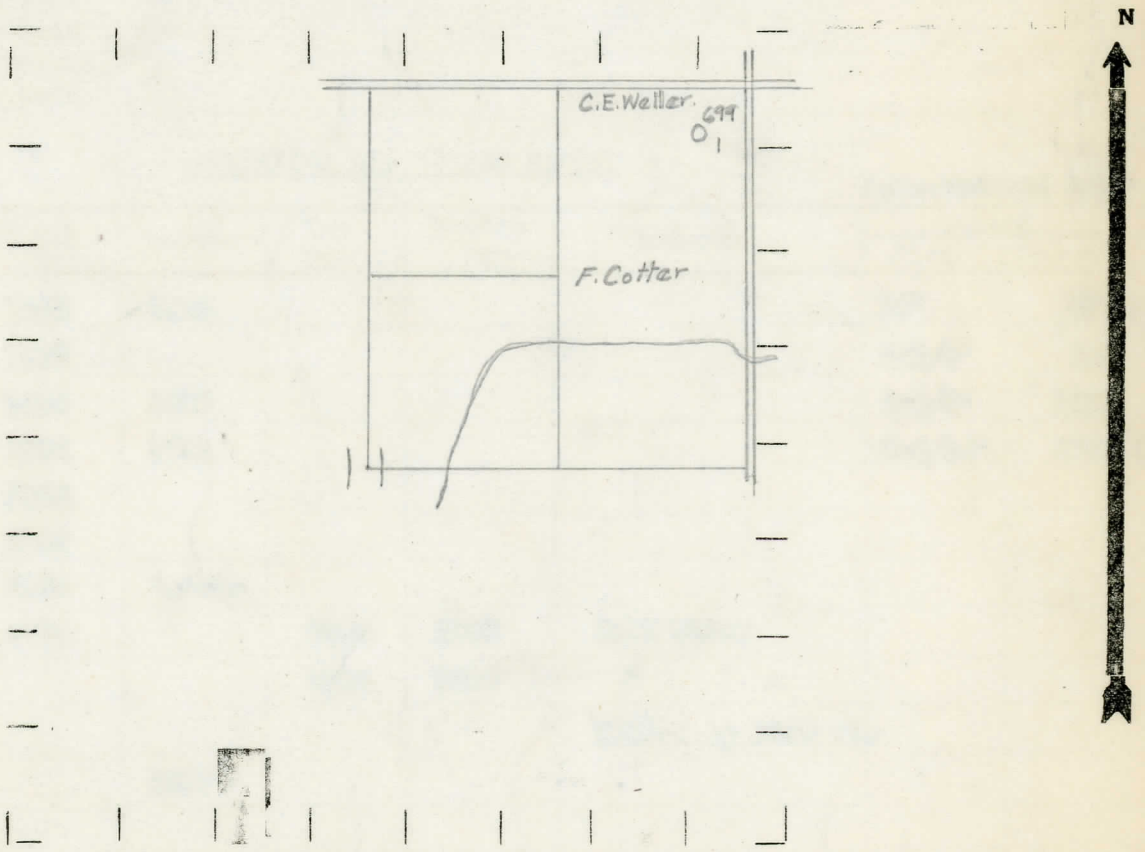

REMARKS:

SIGNED R. L. Yeager
Superintendent or Foreman.

COMPLETION RECORD OF WELLS DRILLED BY OTHER OPERATORS

Michigan Producing Division

Date October 14, 1937 No. 699
 State Michigan County Isabella Dist. _____
 (Serial No.) _____ Twp. Nottawa Sec. 11 Twp. 15 N Rge. 5 W
 Well No. 1 (County No.) 699 Farm F. Cotter Acres _____
 Operator C. E. Weller Information secured ~~from~~ Scouting Department by _____
 Date well started 7-27-37 Date well completed 10-10-37 Elevation 837.8

PRODUCTION RECORD

1st 24 hours natural Dry Hole
 2nd 24 hours natural _____
 Date of shot _____ No. of quarts _____ From _____ to _____ From _____ to _____
 Date of acid _____ No. of gallons _____
 shot _____
 1st 24 hours after acid _____
 shot _____
 2nd 24 hours after acid _____

FORMATION AND CASING RECORD

Formation	Top	Bottom	Top Pay	Bottom Pay	Remarks	R.H.-reduced hole	
						Casing Size	Set At
Stray	1465	1476				10"	497
Marshall	1483					8-1/4"	885
Red Rock	1635	1693				6-5/8"	1721
Red Rock	1706	1711				5-3/16"	3791 (RH)
Antrim	2660						
Traverse Form.	3164						
Traverse Lime	3195	S.L.M.					
Monroe	3798		3804	3806	Salt water		
			3815	3817	" " "		
					filled up 1200 ft.		
Total Depth		3817					

Remarks _____

Signed D. C. Shackelford