



Western Michigan University
ScholarWorks at WMU

Legacy Scout Tickets from Pure Oil Company

8-20-2021

MGRRE_PureOilScoutTickets_Beutler, John_4_21073043190000

MGRRE

Western Michigan University

Follow this and additional works at: <https://scholarworks.wmich.edu/pure>



Part of the Geology Commons

WMU ScholarWorks Citation

MGRRE, "MGRRE_PureOilScoutTickets_Beutler, John_4_21073043190000" (2021). *Legacy Scout Tickets from Pure Oil Company*. 3426.

<https://scholarworks.wmich.edu/pure/3426>

This Document is brought to you for free and open access via ScholarWorks at WMU. It has been accepted for inclusion in Legacy Scout Tickets from Pure Oil Company by an authorized administrator of ScholarWorks at WMU. See the National Digital Catalogue - Science Base Catalogue for more collections submitted by MGRRE.



MGRRE_PureOilScoutTickets_Beutler, John_4_21073043190000

API 21073043190000

Permit Number 4319

Lease Name Beutler, John

Well Number 4

County Isabella

Township 15N

Range 06W

Section 34

2021 DEQ or Pure co_name McClanahan Oil Company

Pure Number 703

Latitude 43.64413

Longitude -85.01879

THE PURE OIL COMPANY

DATE July 15, 1937

LOCATION REPORT

No. 703

STATE Michigan COUNTY Isabella DIST. Sherman TWP. Sherman SEC. 34 TOWN 15 N RANGE 6 W

WELL No. 47 (SERIAL No. 703) FARM John Beutler ACRES

NAME OF STREAM OR WATERS QUADRANGLE SE-NE-SW

OPERATOR McClanahan Oil Company Map Sherman Township, Isabella County

McClanahan Oil Co.

Sherman - Isa.

Feet from North Line of Farm

320 330 East
320 330 South
West
990 990 Feet from North Line 1/4 Section
320 330 East 1/4
South
West

LEGEND

- O LOCATION
DRY HOLE
RIG
DRY SHOWING OIL
DRILLING
DRY SHOWING GAS
GAS WELL
ABANDONED LOCATION
OIL WELL
ABANDONED GAS WELL
SMALL OIL WELL
ABANDONED OIL WELL

NOTE: Below make tracing from map, (when no map is obtainable make sketch) showing farm, center of section, this location with measurements and also wells, dry holes, or other locations in the vicinity of this location.

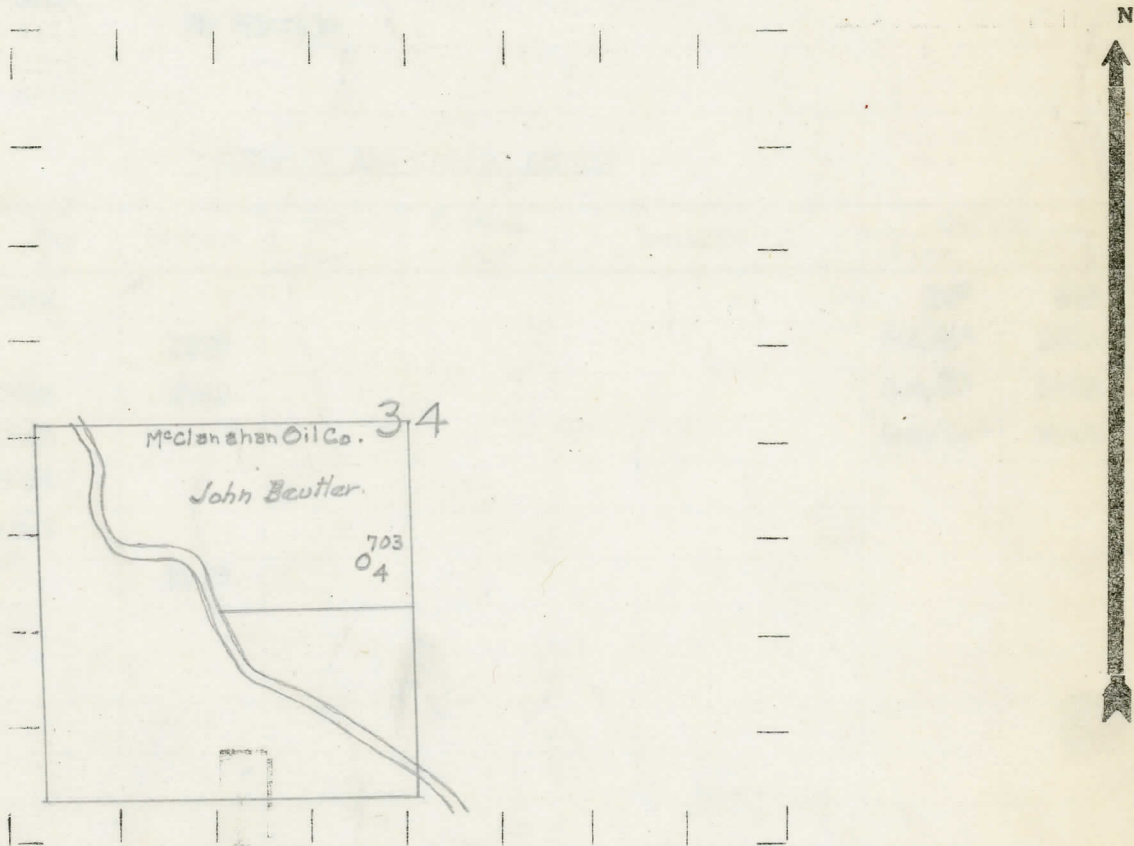

REMARKS:

SIGNED

Superintendent or Foreman.

THE PURE OIL COMPANY
COMPLETION RECORD OF WELLS DRILLED BY OTHER OPERATORS

Michigan Producing Division

Date September 23, 1937. No. 703
 State Mich. County Isabella Dist. Sherman Sec. 34 Twp. 15N Rge. 6W
 Well No. 4 (Serial No.) (County No.) 703 Farm John Beutler Acres _____
 Operator McClanshan Oil Co. Information secured from Scouting Department by _____
 Date well started 7-26-37 Date well completed 9-9-37 Elevation 938.4

PRODUCTION RECORD

Dry Hole

1st 24 hours natural _____
 2nd 24 hours natural _____
 Date of shot _____ No. of quarts _____ From _____ to _____ From _____ to _____
 Date of acid 9-17-37 No. of gallons 300
 1st 24 hours after acid shot **No Results**
 2nd 24 hours after acid shot _____

FORMATION AND CASING RECORD

Formation	Top	Bottom	Top Pay	Bottom Pay	Remarks	Casing	
						Size	Set At
Marshall	1355					10"	538
Red Rock		1670				8-1/4"	1021
Berea	2540	2548				6-5/8"	1675
Antrim	2548					5-3/16"	3645
Traverse Lime	3088						
Monroe	3645						
Total Depth		3657					

Remarks Salt water at 1400
Show of gas at 3655
Show of oil and salt water 3656-3657
The oil show was treated but with no results, the salt water increasing .

Signed Dean C. Shackelford