



Western Michigan University
ScholarWorks at WMU

Legacy Scout Tickets from Pure Oil Company

8-20-2021

MGRRE_PureOilScoutTickets_Smart and Arnold_1_21073047640000

MGRRE

Western Michigan University

Follow this and additional works at: <https://scholarworks.wmich.edu/pure>



Part of the Geology Commons

WMU ScholarWorks Citation

MGRRE, "MGRRE_PureOilScoutTickets_Smart and Arnold_1_21073047640000" (2021). *Legacy Scout Tickets from Pure Oil Company*. 3444.

<https://scholarworks.wmich.edu/pure/3444>

This Document is brought to you for free and open access via ScholarWorks at WMU. It has been accepted for inclusion in Legacy Scout Tickets from Pure Oil Company by an authorized administrator of ScholarWorks at WMU. See the National Digital Catalogue - Science Base Catalogue for more collections submitted by MGRRE.



MGRRE_PureOilScoutTickets_Smart and Arnold_1_21073047640000

API 21073047640000

Permit Number 4764

Lease Name Smart and Arnold

Well Number 1

County Isabella

Township 16N

Range 03W

Section 5

2021 DEQ or Pure co_name Peirce, J. A.

Pure Number 747

Latitude 43.80414

Longitude -84.7047

THE PURE OIL COMPANY
COMPLETION RECORD OF WELLS DRILLED BY OTHER OPERATORS

DATE May 26, 1938

LOCATION REPORT

No. 747

STATE Michigan COUNTY Isabella DIST. Wise Division 5 TOWN 16N RANGE 3W

WELL No. 1 (SERIAL No. 747) FARM F. I. Smart ACRES

NAME OF STREAM OR WATERS QUADRANGLE CW₂ - SW

OPERATOR James A. Pierce Map Wise Township, Isabella County

1320 Feet from North Line of Farm

" " East " " "

" " South " " "

660 Feet from North Line of Section

1320 Feet from North Line of Section 1/4

" " East " " "

" " South " " "

660 Feet from North Line of Section West " " "

LEGEND

- LOCATION
- ⊕ RIG
- ⊕ DRILLING
- ☀ GAS WELL
- OIL WELL
- ⊕ SMALL OIL WELL
- ⊕ DRY HOLE
- ⊕ DRY SHOWING OIL
- ⊕ DRY SHOWING GAS
- ⊕ ABANDONED LOCATION
- ☀ ABANDONED GAS WELL
- ⊕ ABANDONED OIL WELL

NOTE: Below make tracing from map, (when no map is obtainable make sketch) showing farm, center of section, this location with measurements and also wells, dry holes, or other locations in the vicinity of this location.

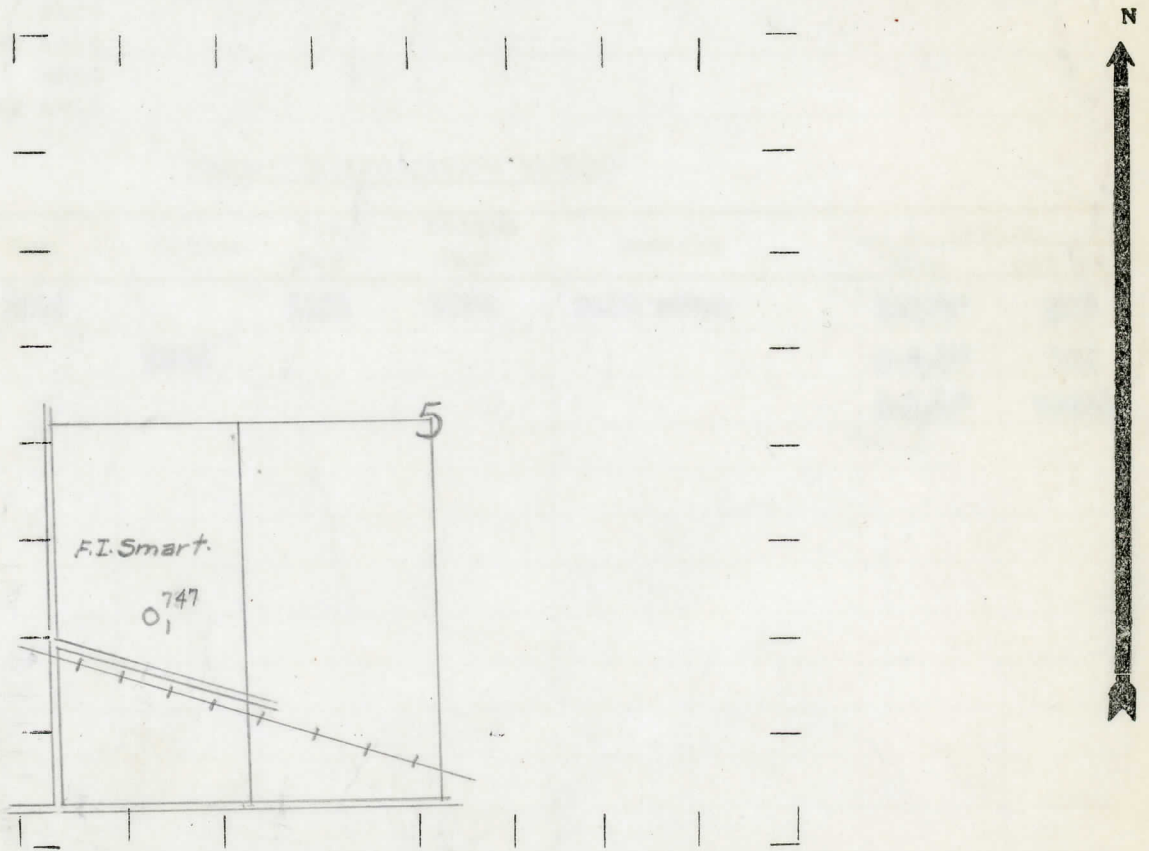

REMARKS:

SIGNED

R. L. Yeager
Superintendent or Foreman.

