



Western Michigan University
ScholarWorks at WMU

Legacy Scout Tickets from Pure Oil Company

8-20-2021

**MGRRE_PureOilScoutTickets_Arnold,
Calvin_A-1_21073072250000**

MGRRE
Western Michigan University

Follow this and additional works at: <https://scholarworks.wmich.edu/pure>



Part of the Geology Commons

WMU ScholarWorks Citation

MGRRE, "MGRRE_PureOilScoutTickets_Arnold, Calvin_A-1_21073072250000" (2021). *Legacy Scout Tickets from Pure Oil Company*. 3489.
<https://scholarworks.wmich.edu/pure/3489>

This Document is brought to you for free and open access via ScholarWorks at WMU. It has been accepted for inclusion in Legacy Scout Tickets from Pure Oil Company by an authorized administrator of ScholarWorks at WMU. See the National Digital Catalogue - Science Base Catalogue for more collections submitted by MGRRE.



MGRRE_PureOilScoutTickets_Arnold, Calvin_A-1_21073072250000

API 21073072250000

Permit Number 7225

Lease Name Arnold, Calvin

Well Number A-1

County Isabella

Township 16N

Range 03W

Section 8

2021 DEQ or Pure co_name Wicklund, J. V. Development Company

Pure Number 802

Latitude 43.7978

Longitude -84.70351

THE PURE OIL COMPANY

DATE January 10, 1940

LOCATION REPORT

No. 802

STATE Michigan COUNTY Isabella

DIST Wise
TWP Wise
PREC Calvin Arnold "A"

SEC. 8 TOWN 16 N RANGE 3 W

WELL No. 1 (SERIAL No. 802) FARM

ACRES

NAME OF STREAM OR WATERS _____ QUADRANGLE SE-NW-NW

OPERATOR J. V. Wicklund Development Company Map Wise Township, Isabella County
Wicklund Dev. Co. Wise - Isa.

Feet from North Line of Farm

33830

" " East " " "

330330

" " South " " "

" " West " " "

99090

Feet from North Line of Section

" " East " " "

" " South " " "

990990

" " West " " "

LEGEND

○ LOCATION

⊙ DRY HOLE

⊕ RIG

⊙ DRY SHOWING OIL

⊕ DRILLING

⊙ DRY SHOWING GAS

☀ GAS WELL

⊙ ABANDONED LOCATION

● OIL WELL

☀ ABANDONED GAS WELL

⊙ SMALL OIL WELL

⊙ ABANDONED OIL WELL

NOTE: Below make tracing from map, (when no map is obtainable make sketch) showing farm, center of section, this location with measurements and also wells, dry holes, or other locations in the vicinity of this location.

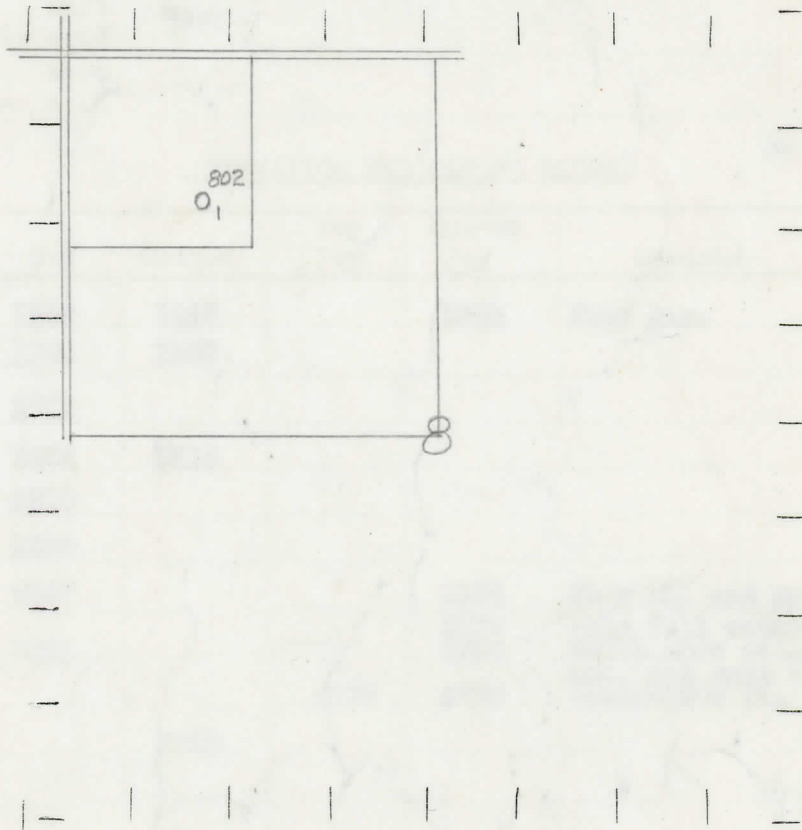

REMARKS:

SIGNED

Superintendent or Foreman.

COMPLETION RECORD OF WELLS DRILLED BY OTHER OPERATORS

Michigan Producing Division

Date April 24, 1940 No. 802
 State Mich. County Isabella Dist. ~~Isabella~~ Wise Twp. Wise Sec. 8 Twp. 16 N Rge. 3 W
 Well No. A-1 (Serial No.) ~~(County No.)~~ 802 Farm Calvin Arnold Acres _____
 Operator J. V. Wicklund Development Co. Information secured ~~from~~ Scouting Department
 Date well started 1-6-40 Dated well completed 4-20-40 Elevation 808.8

PRODUCTION RECORD

1st 24 hours natural Dry Hole
 2nd 24 hours natural _____
 Date of shot _____ No. of quarts _____ From _____ to _____ From _____ to _____
 Date of acid _____ No. of gallons _____
 1st 24 hours after acid shot _____
 2nd 24 hours after acid shot _____

FORMATION AND CASING RECORD

| Formation | Top | Bottom | Top Pay | Bottom Pay | Remarks | Casing | |
|---------------|------|--------|---------|--------------|---|---------|--------|
| | | | | | | Size | Set at |
| Stray | 1282 | 1297 | | 1289 | Show gas. | 10" | 437 |
| " | 1304 | 1307 | | | | 8-1/4" | 882 |
| Marshall | 1372 | | | | | 6-5/8" | 1550 |
| Red Rock | 1462 | 1515 | | | | 5-3/16" | 3705 |
| Sunbury | 2510 | | | | | | |
| Antrim | 2555 | | | | | | |
| Traverse Line | 3047 | | | 3055 | Show oil and gas. | | |
| Dundee | 3701 | | | 3075 3752 | Hole full water. Small show oil, gas, and salt water. | | |
| Total Depth | | 3780 | | 3779 3780 | Water-1200 ft. | | |

Remarks _____

Signed D. C. Shackelford