



Western Michigan University
ScholarWorks at WMU

Legacy Scout Tickets from Pure Oil Company

8-20-2021

MGRRE_PureOilScoutTickets_Allen_1_21073072820000

MGRRE

Western Michigan University

Follow this and additional works at: <https://scholarworks.wmich.edu/pure>



Part of the Geology Commons

WMU ScholarWorks Citation

MGRRE, "MGRRE_PureOilScoutTickets_Allen_1_21073072820000" (2021). *Legacy Scout Tickets from Pure Oil Company*. 3505.

<https://scholarworks.wmich.edu/pure/3505>

This Document is brought to you for free and open access via ScholarWorks at WMU. It has been accepted for inclusion in Legacy Scout Tickets from Pure Oil Company by an authorized administrator of ScholarWorks at WMU. See the National Digital Catalogue - Science Base Catalogue for more collections submitted by MGRRE.



MGRRE_PureOilScoutTickets_Allen_1_21073072820000

API 21073072820000

Permit Number 7282

Lease Name Allen

Well Number 1

County Isabella

Township 16N

Range 03W

Section 17

2021 DEQ or Pure co_name Summit Petroleum Corporation

Pure Number 819

Latitude 43.7797109

Longitude -84.6884036

THE PURE OIL COMPANY

DATE January 24, 1940

LOCATION REPORT

No. 819

STATE Michigan COUNTY Isabella DIST. Wise TWP. Wise SEC. 17 TOWN 16 N RANGE 3 W

WELL No. 1 (SERIAL No. 819) FARM Allen ACRES

NAME OF STREAM OR WATERS QUADRANGLE SE SE NE

OPERATOR Cities Service Oil Company Map Wise Township, Isabella County
Cities Ser Oil Co. Wise - Isa.

Feet from North Line of Farm
33330 " " East " " "
33330 " " South " " "
" " West " " "

Feet from North Line of Section
33330 " " East " " "
33330 " " South " 1/4 "
" " West " " "

LEGEND

- LOCATION
- ⊕ RIG
- ⊕ DRILLING
- ☀ GAS WELL
- OIL WELL
- SMALL OIL WELL
- ⊖ DRY HOLE
- ⊖ DRY SHOWING OIL
- ⊖ DRY SHOWING GAS
- ⊖ ABANDONED LOCATION
- ⊖ ABANDONED GAS WELL
- ⊖ ABANDONED OIL WELL

NOTE: Below make tracing from map, (when no map is obtainable make sketch) showing farm, center of section, this location with measurements and also wells, dry holes, or other locations in the vicinity of this location.

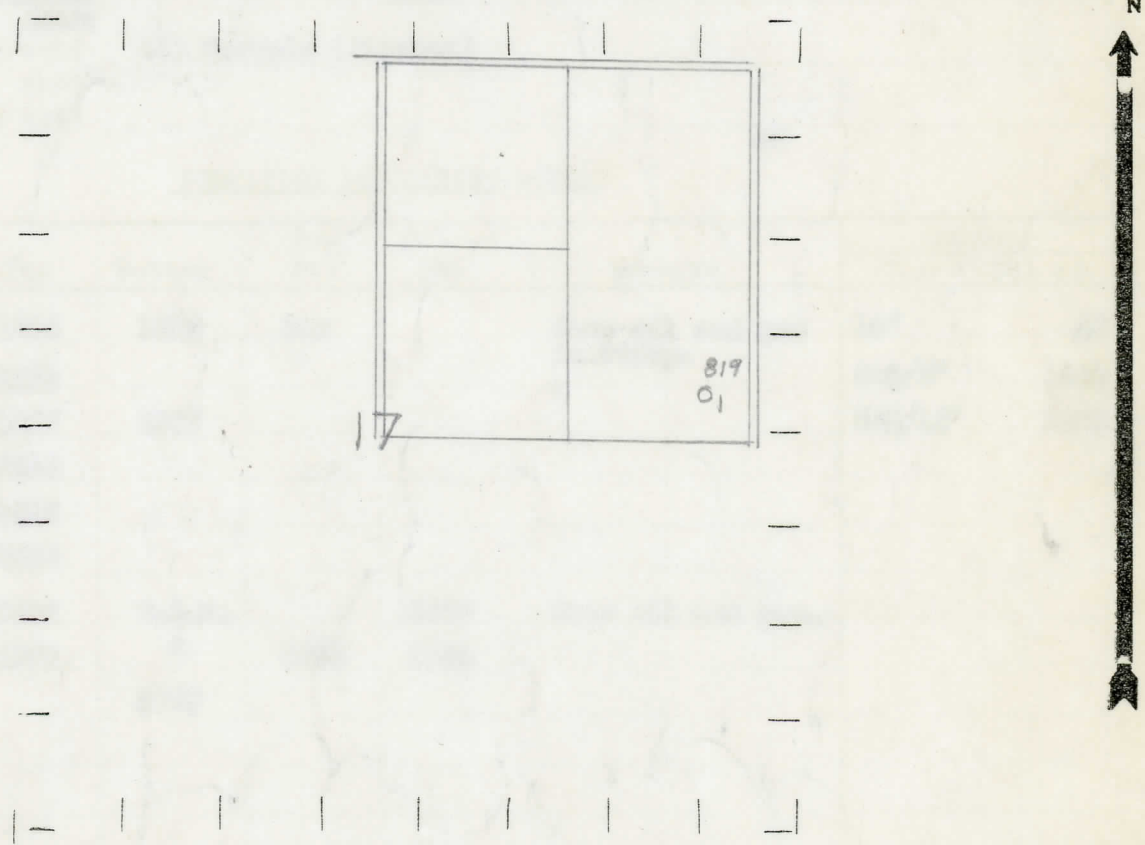

REMARKS:

SIGNED

Superintendent or Foreman.

THE PURE OIL COMPANY
The Pure Oil Company
COMPLETION RECORD OF WELLS DRILLED BY OTHER OPERATORS

Michigan Producing Division

Date **March 13, 1940** No. **819**
State **Mich.** County **Isabella** Dist. **Wise** Twp. **Wise** Sec. **17** Twp. **16 N** Rge. **3 W**
(Serial No.)
Well No. **1** (County No.) **819** Farm **Allen** Acres
Operator **Cities Service Oil Company** Information secured **From Scouting Department**
By
Date well started **2-5-40** Dated well completed **3-8-40** Elevation **774.5**

PRODUCTION RECORD

17
1st ~~24~~ hours natural **103 Barrels (Swabbed and flowed.)**
2nd 24 hours natural
Date of shot No. of quarts From to From to
Date of acid **3-10-40** No. of gallons **1000**
~~shot~~
1st 24 hours after acid **411 Barrels (Pinched)**
shot
2nd 24 hours after acid

FORMATION AND CASING RECORD

Formation	Top	Bottom	Top Pay	Bottom Pay	Remarks	Casing	
						Size	Set at
Stray	1250	1268	S.L.M.		Show oil and gas in Stray.	14"	46
Marshall	1325					6-5/8"	1520
Red Rock	1427	1507				5-3/16"	3666
Sunbury	2444						
Berea	2478						
Antrim	2496						
Traverse Lime	2996	S.L.M.		3080	Show oil and gas.		
Dundee	3650	"	3698	3704			
Total Depth		3705					

Remarks

Signed **D. C. Shackelford**