



Western Michigan University
ScholarWorks at WMU

Legacy Scout Tickets from Pure Oil Company

8-20-2021

MGRRE_PureOilScoutTickets_Burch, Minnie_3_21073074580000

MGRRE

Western Michigan University

Follow this and additional works at: <https://scholarworks.wmich.edu/pure>



Part of the Geology Commons

WMU ScholarWorks Citation

MGRRE, "MGRRE_PureOilScoutTickets_Burch, Minnie_3_21073074580000" (2021). *Legacy Scout Tickets from Pure Oil Company*. 3518.

<https://scholarworks.wmich.edu/pure/3518>

This Document is brought to you for free and open access via ScholarWorks at WMU. It has been accepted for inclusion in Legacy Scout Tickets from Pure Oil Company by an authorized administrator of ScholarWorks at WMU. See the National Digital Catalogue - Science Base Catalogue for more collections submitted by MGRRE.



MGRRE_PureOilScoutTickets_Burch, Minnie_3_21073074580000

API 21073074580000

Permit Number 7458

Lease Name Burch, Minnie

Well Number 3

County Isabella

Township 16N

Range 03W

Section 17

2021 DEQ or Pure co_name Summit Petroleum Corporation

Pure Number 832

Latitude 43.7779448

Longitude -84.6984903

THE PURE OIL COMPANY

DATE March 20, 1940

LOCATION REPORT

No. 832

STATE Michigan COUNTY Isabella DIST. Wise TWP. Wise SEC. 17 TOWN 16 N RANGE 3 W

WELL No. 3 (SERIAL No. 832) FARM Minnie Burch ACRES

NAME OF STREAM OR WATERS QUADRANGLE NE NE SW

OPERATOR Gulf Refining Company Map Wise Township, Isabella County

Feet from North Line of Farm

330 330 " " East " " "

990 990 " " South " " "

" " West " " "

Feet from North Line of Section

330 330 " " East " " "

" " South " " "

" " West " " "

LEGEND

○ LOCATION

⊙ DRY HOLE

⊕ RIG

● DRY SHOWING OIL

⊕ DRILLING

⊙ DRY SHOWING GAS

☀ GAS WELL

⊙ ABANDONED LOCATION

● OIL WELL

☀ ABANDONED GAS WELL

● SMALL OIL WELL

● ABANDONED OIL WELL

NOTE: Below make tracing from map. (when no map is obtainable make sketch) showing farm, center of section, this location with measurements and also wells, dry holes, or other locations in the vicinity of this location.

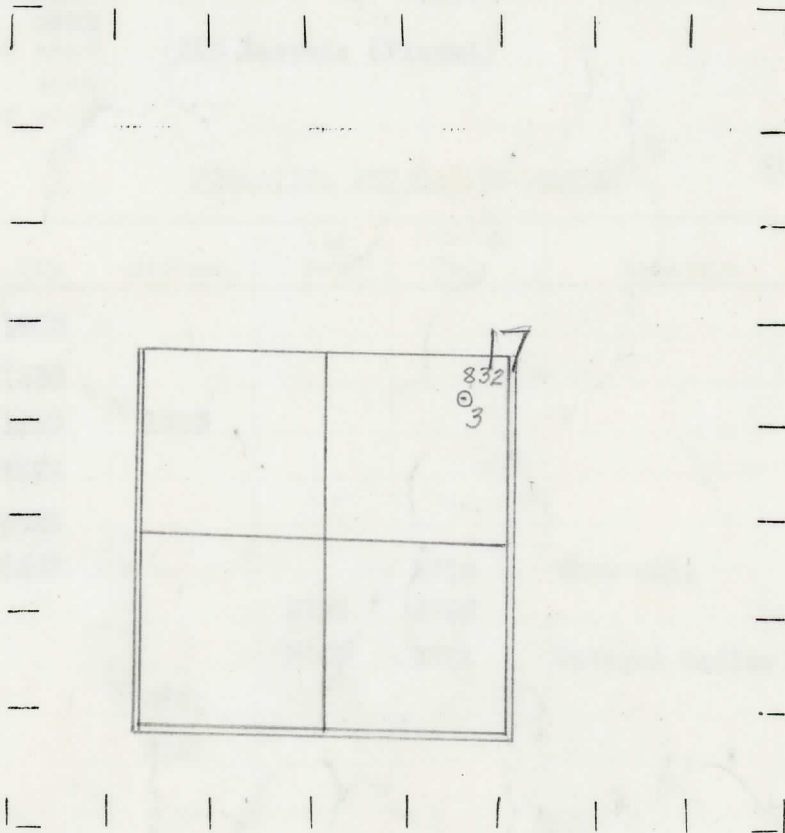

REMARKS:

SIGNED

W

Superintendent or Foreman.

COMPLETION RECORD OF WELLS DRILLED BY OTHER OPERATORS

Michigan Producing Division

Date **May 1, 1940** No. **832**
 State **Mich.** County **Isabella** Dist. ~~Isabella~~ **Wise** Twp. **17** Sec. **17** Twp. **16 N** Rge. **3 W**
 Well No. **3** (Serial No.) ~~(Sunbury No.)~~ **832** Farm **Minnie Burch** Acres _____
 Operator **Gulf Refining Company** Information secured ~~from~~ **Scouting Department** By _____
 Date well started **3-16-40** Dated well completed **4-22-40** Elevation **801.7**

PRODUCTION RECORD

1st 24 hours natural **131 Barrels**
 2nd 24 hours natural _____
 Date of shot _____ No. of quarts _____ From _____ to _____ From _____ to _____
 Date of acid **4-25-40** No. of gallons **2000**
 1st ~~24~~ **20** hours after ~~shot~~ **shot** **388 Barrels (Flowed)**
 2nd 24 hours after acid _____

FORMATION AND CASING RECORD

Formation	Top	Bottom	Top Pay	Bottom Pay	Remarks	Casing	
						Size	Set at
Stray	1308					6-5/8"	1535
Marshall	1350					5-3/16"	3669
Red Rock	1440	1520				14"	52
Sunbury	2464						
Traverse Line	3023						
Dundee	3669			3716	Show oil.		
			3723	3738			
			3747	3751	Water-1 bailer per hour.		
Total Depth		3751					
Plugged Back:		3747					

Remarks _____

Signed **D. C. Shackelford**