



Western Michigan University
ScholarWorks at WMU

Legacy Scout Tickets from Pure Oil Company

8-20-2021

MGRRE_PureOilScoutTickets_Parsell_2_21073075910000

MGRRE

Western Michigan University

Follow this and additional works at: <https://scholarworks.wmich.edu/pure>



Part of the Geology Commons

WMU ScholarWorks Citation

MGRRE, "MGRRE_PureOilScoutTickets_Parsell_2_21073075910000" (2021). *Legacy Scout Tickets from Pure Oil Company*. 3527.

<https://scholarworks.wmich.edu/pure/3527>

This Document is brought to you for free and open access via ScholarWorks at WMU. It has been accepted for inclusion in Legacy Scout Tickets from Pure Oil Company by an authorized administrator of ScholarWorks at WMU. See the National Digital Catalogue - Science Base Catalogue for more collections submitted by MGRRE.



MGRRE_PureOilScoutTickets_Parsell_2_21073075910000

API 21073075910000

Permit Number 7591

Lease Name Parsell

Well Number 2

County Isabella

Township 16N

Range 03W

Section 17

2021 DEQ or Pure co_name Summit Petroleum Corporation

Pure Number 842

Latitude 43.78329

Longitude -84.69349

THE PURE OIL COMPANY

DATE May 1, 1940

LOCATION REPORT

No. 842

STATE Michigan COUNTY Isabella DIST. Wise TWP. Wise SEC. 17 TOWN 16 N RANGE 3 W

WELL No. 2 (SERIAL No. 842) FARM Parsell ACRES

NAME OF STREAM OR WATERS _____ QUADRANGLE SE NW NE

OPERATOR Cities Service Oil Company Map Wise Township, Isabella County

Feet from North Line of Farm

330 330 " " East " " "

330 330 " " South " " "

" " West " " "

990 990 Feet from North Line of Section

" " East " " "

" " South " " "

990 990 " " West " " "

*42 - well
sp 4-29-40
13" cap 42*

LEGEND

- LOCATION
- ⊕ RIG
- ⊕ DRILLING
- ☀ GAS WELL
- OIL WELL
- SMALL OIL WELL
- ⊙ DRY HOLE
- ◆ DRY SHOWING OIL
- ⊙ DRY SHOWING GAS
- ⊙ ABANDONED LOCATION
- ☀ ABANDONED GAS WELL
- ABANDONED OIL WELL

NOTE: Below make tracing from map. (when no map is obtainable make sketch) showing farm, center of section, this location with measurements and also wells, dry holes, or other locations in the vicinity of this location.

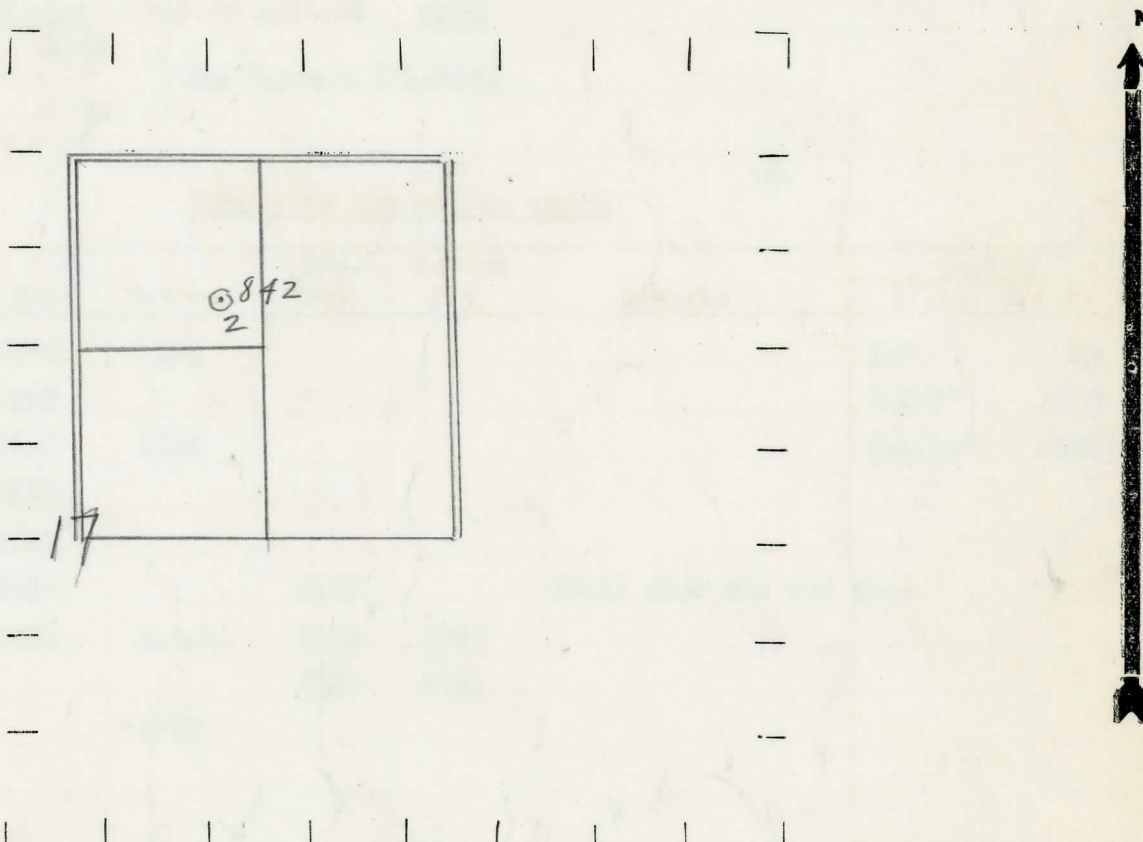

REMARKS:

SIGNED

W

Superintendent or Foreman.

the Pure Oil Company
COMPLETION RECORD OF WELLS DRILLED BY OTHER OPERATORS

Michigan Producing Division

Date June 5, 1940 No. 842
 State Mich. County Isabella Dist. Isabella Twp. Wise Sec. 17 Twp. 16 N Rge. 3 W
 (Serial No.)
 Well No. 2 (County No.) 842 Farm Parsell Acres _____
 Operator Cities Service Oil Company Information secured from Scouting Department By _____
 Date well started 4-29-40 Dated well completed 5-30-40 Elevation 808.0

PRODUCTION RECORD

1st ¹⁴~~24~~ hours natural 49 Barrels
 2nd 24 hours natural _____
 Date of shot _____ No. of quarts _____ From _____ to _____ From _____ to _____
 Date of acid 6-2-40 No. of gallons 2000
 1st 24 hours after acid 381 Barrels (Flowed)
 shot
 2nd 24 hours after acid _____

FORMATION AND CASING RECORD

Formation	Top	Bottom	Top Pay	Bottom Pay	Remarks	Casing	
						Size	Set at
Stray	1278	1295				14"	42
Marshall	1352					6-5/8"	1540
Red Rock	1440	1512				5-3/16"	3694
Sunbury	2485						
Antrim	2539						
Traverse Lime	3020		3150		Small show oil and gas.		
Dundee	3680	S.L.M.	3728	3737			
			3739	3751			
Total Depth		3753					

Remarks 3698' C.T.M. equals 3694' S.L.M.

Signed D. C. Shackelford