



Western Michigan University
ScholarWorks at WMU

Legacy Scout Tickets from Pure Oil Company

8-20-2021

MGRRE_PureOilScoutTickets_Miller_1_21073077580000

MGRRE

Western Michigan University

Follow this and additional works at: <https://scholarworks.wmich.edu/pure>



Part of the Geology Commons

WMU ScholarWorks Citation

MGRRE, "MGRRE_PureOilScoutTickets_Miller_1_21073077580000" (2021). *Legacy Scout Tickets from Pure Oil Company*. 3535.

<https://scholarworks.wmich.edu/pure/3535>

This Document is brought to you for free and open access via ScholarWorks at WMU. It has been accepted for inclusion in Legacy Scout Tickets from Pure Oil Company by an authorized administrator of ScholarWorks at WMU. See the National Digital Catalogue - Science Base Catalogue for more collections submitted by MGRRE.



MGRRE_PureOilScoutTickets_Miller_1_21073077580000

API 21073077580000

Permit Number 7758

Lease Name Miller

Well Number 1

County Isabella

Township 15N

Range 06W

Section 20

2021 DEQ or Pure co_name Cryden Petroleum Corporation

Pure Number 851

Latitude 43.67112

Longitude -85.06371

DATE June 19, 1940

LOCATION REPORT

No. 851

STATE Michigan COUNTY Isabella DIST. Sherman TWP. Sherman SEC. 20 TOWN 15 N RANGE 6 W
WELL No. 1 (SERIAL No. 851) FARM Miller ACRES

NAME OF STREAM OR WATERS _____ QUADRANGLE NE SW-SW-SW-SW

OPERATOR Cryden Petroleum Corporation Map Sherman Township, Isabella County

330 330 Feet from North Line of Farm

312 312 " " East " " "

" " South " " "

" " West " " "

Feet from North Line of Section

" " East " " "

990 990 " " South " " 1/4

1008 1008 " " West " " "

LEGEND

○ LOCATION

⊕ RIG

⊕ DRILLING

☀ GAS WELL

● OIL WELL

● SMALL OIL WELL

⊙ DRY HOLE

● DRY SHOWING OIL

☀ DRY SHOWING GAS

⊙ ABANDONED LOCATION

☀ ABANDONED GAS WELL

● ABANDONED OIL WELL

NOTE: Below make tracing from map. (when no map is obtainable make sketch) showing farm, center of section, this location with measurements and also wells, dry holes, or other locations in the vicinity of this location.

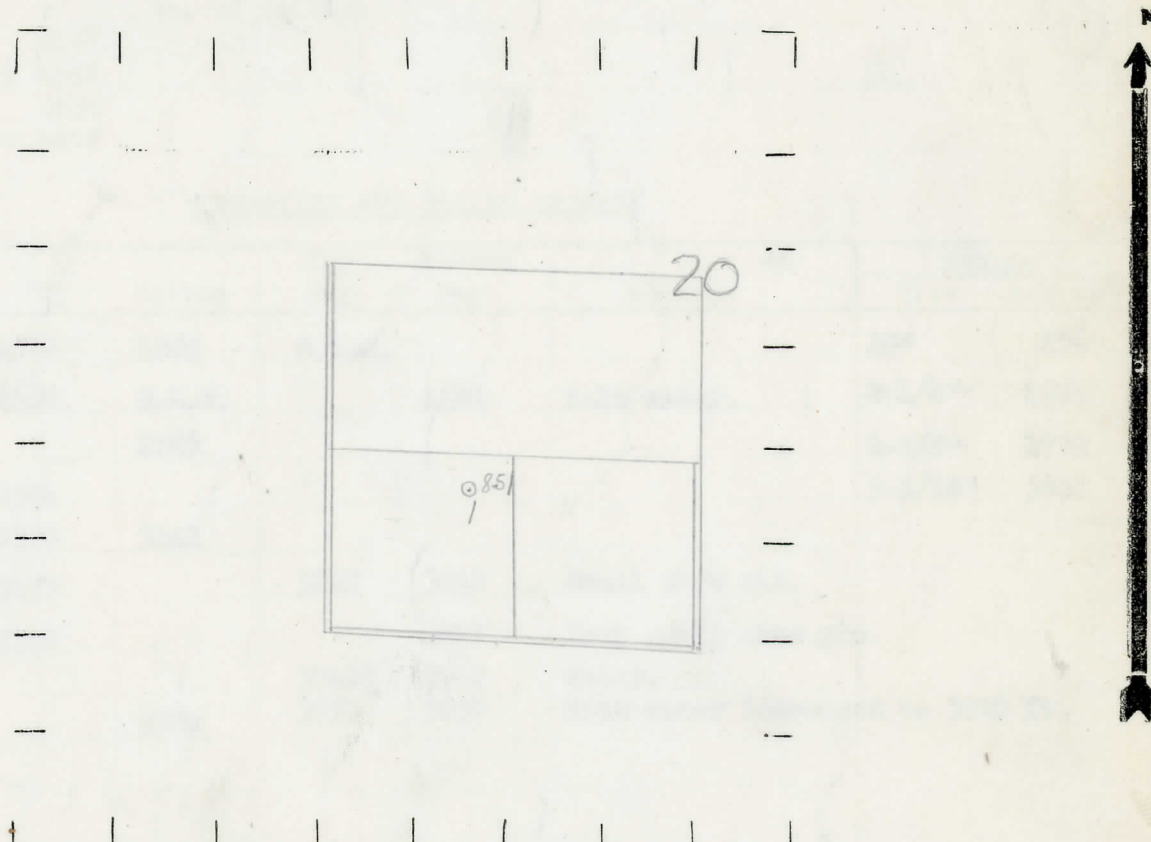

REMARKS:

SIGNED

Superintendent or Foreman.

DATE August 21, 1940 COMPLETION RECORD OF WELLS DRILLED BY OTHER OPERATORS

Michigan Producing Division

Date August 21, 1940 No. 851
 State Mich. County Isabella Dist. Sherman Twp. 20 Sec. 15 N Rge. 6 W
 Well No. 1 (Serial No.) 851 Farm Miller Acres _____
 Operator Cryden Petroleum Corporation Information secured ~~from~~ Scouting Department
 Date well started 6-17-40 Dated well completed 8-12-40 Elevation 1027.3

PRODUCTION RECORD

1st 24 hours natural Dry Hole
 2nd 24 hours natural _____
 Date of shot _____ No. of quarts _____ From _____ to _____ From _____ to _____
 Date of acid _____ No. of gallons _____
 1st 24 hours after acid shot _____
 2nd 24 hours after acid shot _____

FORMATION AND CASING RECORD

Formation	Top	Bottom	Top Pay	Bottom Pay	Remarks	Casing	
						Size	Set at
/Stray	1370	1385	S.L.M.			10"	636
Marshall	1458	S.L.M.		1481	Salt water.	8-1/4"	1089
Red Rock		1765				6-5/8"	1772
Sunbury	2594					5-3/16"	3500
Antrim	2660	3142					
Traverse Lime	3177		3227	3242	Small show oil.		
Monroe	3745			3747	Very small show gas.		
Total Depth		3780	3748 1/2 3750	3750 3757	Water. Salt water increased to 3000 ft.		

Remarks Show gas and oil from 1372' to 1385'. 1485' C.T.M. equals 1481' S.L.M.; 3700'

C.T.M. equals 3707' S.L.M.

Signed D. C. Shackelford