



Western Michigan University
ScholarWorks at WMU

Legacy Scout Tickets from Pure Oil Company

8-20-2021

MGRRE_PureOilScoutTickets_Parsell_4_21073078990000

MGRRE

Western Michigan University

Follow this and additional works at: <https://scholarworks.wmich.edu/pure>



Part of the Geology Commons

WMU ScholarWorks Citation

MGRRE, "MGRRE_PureOilScoutTickets_Parsell_4_21073078990000" (2021). *Legacy Scout Tickets from Pure Oil Company*. 3545.

<https://scholarworks.wmich.edu/pure/3545>

This Document is brought to you for free and open access via ScholarWorks at WMU. It has been accepted for inclusion in Legacy Scout Tickets from Pure Oil Company by an authorized administrator of ScholarWorks at WMU. See the National Digital Catalogue - Science Base Catalogue for more collections submitted by MGRRE.



MGRRE_PureOilScoutTickets_Parsell_4_21073078990000

API 21073078990000

Permit Number 7899

Lease Name Parsell

Well Number 4

County Isabella

Township 16N

Range 03W

Section 8

2021 DEQ or Pure co_name Summit Petroleum Corporation

Pure Number 863

Latitude 43.78873

Longitude -84.69596

THE PURE OIL COMPANY
The Pure Oil Company

863

DATE August 14, 1940

LOCATION REPORT

No.

STATE Michigan

COUNTY

Isabella

TWP

Wise

SEC

8

TOWN

16 N

RANGE

3 W

WELL No.

4

(SERIAL No.

863)

FARM

Parsell

ACRES

NAME OF STREAM OR WATERS

QUADRANGLE

NW SW SE

OPERATOR Cities Service Oil Company

Map

Wise Township, Isabella County

1650 1650 Feet from North Line of Farm

“ “ East “ “ “

“ “ South “ “ “

330 330 “ “ West “ “ “

Feet from North Line of Section

“ “ East “ “ “

990 990 “ “ South “ 1/4 “

330 330 “ “ West “ “ “

LEGEND

○ LOCATION

① RIG

⊕ DRILLING

☀ GAS WELL

● OIL WELL

⬮ SMALL OIL WELL

⊖ DRY HOLE

⬮ DRY SHOWING OIL

⊖ DRY SHOWING GAS

⊖ ABANDONED LOCATION

☀ ABANDONED GAS WELL

⬮ ABANDONED OIL WELL

NOTE: Below make tracing from map, (when no map is obtainable make sketch) showing farm, center of section, this location with measurements and also wells, dry holes, or other locations in the vicinity of this location.

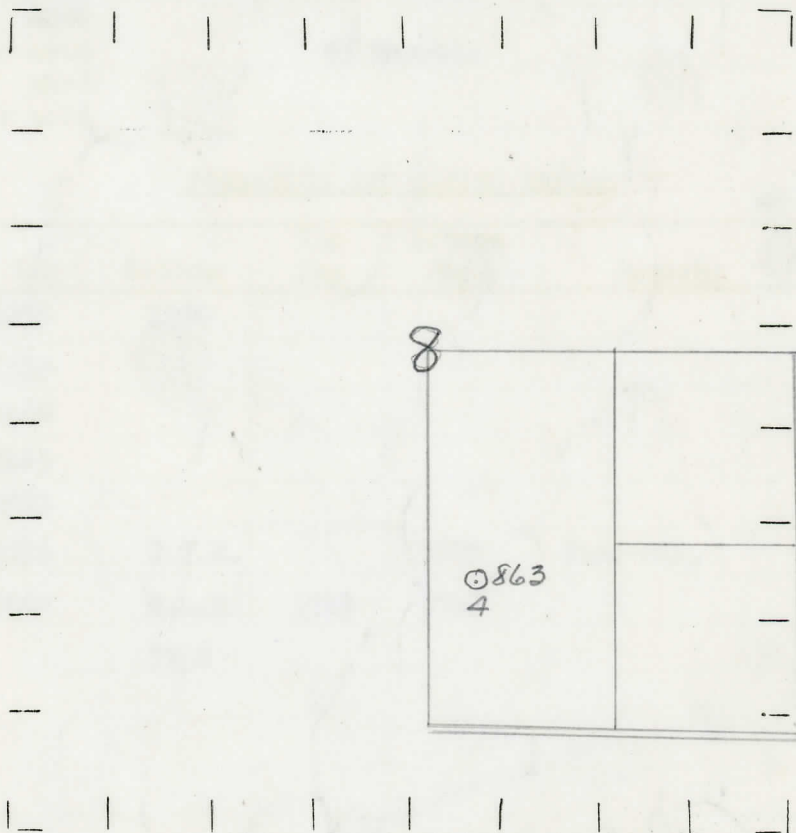

REMARKS:

SIGNED

Superintendent or Foreman

Michigan Producing Division

Date **October 30, 1940** No. **863**
 State **Mich.** County **Isabella** Dist. **Wise**
 (Serial No.) Twp. **Wise** Sec. **8** Twp. **16 N** Rge. **3 W**
 Well No. **4** (County No.) **863** Farm **Parsell** Acres _____
 Operator **Cities Service Oil Company** Information secured ~~from~~ **Scouting Department**
 Date well started **9-9-40** Dated well completed **10-17-40** Elevation **785.5**

PRODUCTION RECORD

1st 24 hours natural **2 Barrels**
 2nd 24 hours natural _____
 Date of shot _____ No. of quarts _____ From _____ to _____ From _____ to _____
 Date of acid **10-21-40 and 10-25-40** No. of gallons **2500**
~~shot~~
 1st 24 hours after acid **95 Barrels**
 shot
 2nd 24 hours after acid _____

FORMATION AND CASING RECORD

Formation	Top	Bottom	Top Pay	Bottom Pay	Remarks	Casing	
						Size	Set at
Stray	1275	1290				14"	42
Marshall	1333					6-5/8"	1500
Sunbury	2460					5-3/16"	3681
Berea	2485						
Antrim	2510						
Traverse Lime	3016	C.T.M.		3075	Show oil.		
Dundee	3668	S.L.M.	3713	3740			
Total Depth		3742					

Remarks _____

Signed **D. C. Shackelford**