



Western Michigan University
ScholarWorks at WMU

Legacy Scout Tickets from Pure Oil Company

8-20-2021

MGRRE_PureOilScoutTickets_Gas Well Unit_E_21073081520000

MGRRE

Western Michigan University

Follow this and additional works at: <https://scholarworks.wmich.edu/pure>



Part of the Geology Commons

WMU ScholarWorks Citation

MGRRE, "MGRRE_PureOilScoutTickets_Gas Well Unit_E_21073081520000" (2021). *Legacy Scout Tickets from Pure Oil Company*. 3553.

<https://scholarworks.wmich.edu/pure/3553>

This Document is brought to you for free and open access via ScholarWorks at WMU. It has been accepted for inclusion in Legacy Scout Tickets from Pure Oil Company by an authorized administrator of ScholarWorks at WMU. See the National Digital Catalogue - Science Base Catalogue for more collections submitted by MGRRE.



MGRRE_PureOilScoutTickets_Gas Well Unit_E_21073081520000

API 21073081520000

Permit Number 8152

Lease Name Gas Well Unit

Well Number E

County Isabella

Township 16N

Range 03W

Section 8

2021 DEQ or Pure co_name Summit Petroleum Corporation

Pure Number 872

Latitude 43.7895698

Longitude -84.6920554

THE PURE OIL COMPANY

DATE October 23, 1940

LOCATION REPORT

No. 872

STATE Mich. COUNTY Isabella DIST. Wise TWP. Wise SEC. 8 TOWN 16 N RANGE 3 W
WELL No. 1 (SERIAL No. 872) FARM Gas Well Unit "E" ACRES

NAME OF STREAM OR WATERS _____ QUADRANGLE NW SE SE - SE

OPERATOR Cities Service Oil Company Map Wise Township, Isabella County

Cities Service Oil Co.

Wise - Isabella

Feet from North Line of Farm

1305 1305 " " East " " "

1275 1275 " " South " " "

" " West " " "

Feet from North Line of Section

1305 1305 " " East " " 1/4

1275 1275 " " South " " "

" " West " " "

LEGEND

- LOCATION
- ⊕ RIG
- ⊕ DRILLING
- ☀ GAS WELL
- OIL WELL
- SMALL OIL WELL
- ⊙ DRY HOLE
- DRY SHOWING OIL
- ⊙ DRY SHOWING GAS
- ⊙ ABANDONED LOCATION
- ☀ ABANDONED GAS WELL
- ABANDONED OIL WELL

NOTE: Below make tracing from map, (when no map is obtainable make sketch) showing farm, center of section, this location with measurements and also wells, dry holes, or other locations in the vicinity of this location.

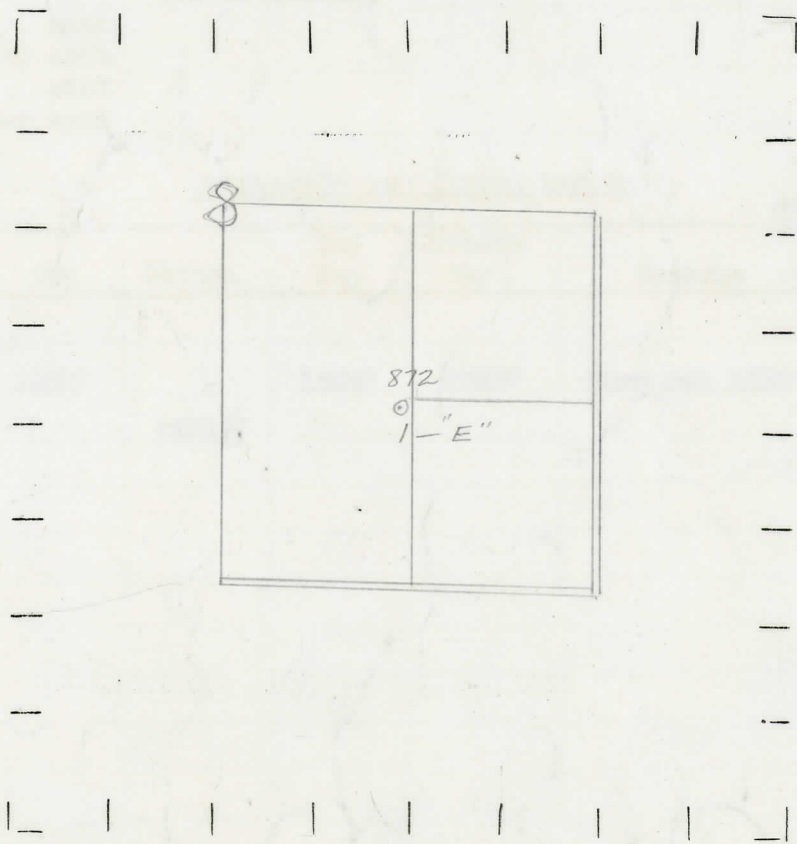

REMARKS:

SIGNED

W
Superintendent or Foreman.

