



Western Michigan University
ScholarWorks at WMU

Legacy Scout Tickets from Pure Oil Company

8-20-2021

MGRRE_PureOilScoutTickets_Gas Well Unit_F_21073081680000

MGRRE

Western Michigan University

Follow this and additional works at: <https://scholarworks.wmich.edu/pure>



Part of the Geology Commons

WMU ScholarWorks Citation

MGRRE, "MGRRE_PureOilScoutTickets_Gas Well Unit_F_21073081680000" (2021). *Legacy Scout Tickets from Pure Oil Company*. 3554.

<https://scholarworks.wmich.edu/pure/3554>

This Document is brought to you for free and open access via ScholarWorks at WMU. It has been accepted for inclusion in Legacy Scout Tickets from Pure Oil Company by an authorized administrator of ScholarWorks at WMU. See the National Digital Catalogue - Science Base Catalogue for more collections submitted by MGRRE.



MGRRE_PureOilScoutTickets_Gas Well Unit_F_21073081680000

API 21073081680000

Permit Number 8168

Lease Name Gas Well Unit

Well Number F

County Isabella

Township 16N

Range 03W

Section 28

2021 DEQ or Pure co_name Oxy USA, Incorporated

Pure Number 873

Latitude 43.74621

Longitude -84.68217

THE PURE OIL COMPANY

DATE November 6, 1940

LOCATION REPORT

No. 873 73

STATE Michigan COUNTY Isabella DIST. Wise TWP. Wise SEC. 28 TOWN 16N RANGE 3W
 WELL No. 1 (SERIAL No. 873) FARM Gas Well Unit #1 "F" ACRES _____
 NAME OF STREAM OR WATERS _____ QUADRANGLE NW-SE-SW
 OPERATOR Cities Service Oil Co. Map Wise - Isabella
Cities Service Oil Co Wise - Isabella

Feet from North Line of Farm
1285 " " East " " "
1285 " " South " " "
 " " West " " "
 Feet from North Line of Section
1285 " " East " " "
1285 " " South " " "
 " " West " " "

- LEGEND**
- LOCATION
 - ⊕ RIG
 - ⊕ DRILLING
 - ☀ GAS WELL
 - OIL WELL
 - ⬇ SMALL OIL WELL
 - ⊖ DRY HOLE
 - ⬆ DRY SHOWING OIL
 - ☀ DRY SHOWING GAS
 - ⊖ ABANDONED LOCATION
 - ☀ ABANDONED GAS WELL
 - ⬆ ABANDONED OIL WELL

NOTE: Below make tracing from map. (when no map is obtainable make sketch) showing farm, center of section, this location with measurements and also wells, dry holes, or other locations in the vicinity of this location.

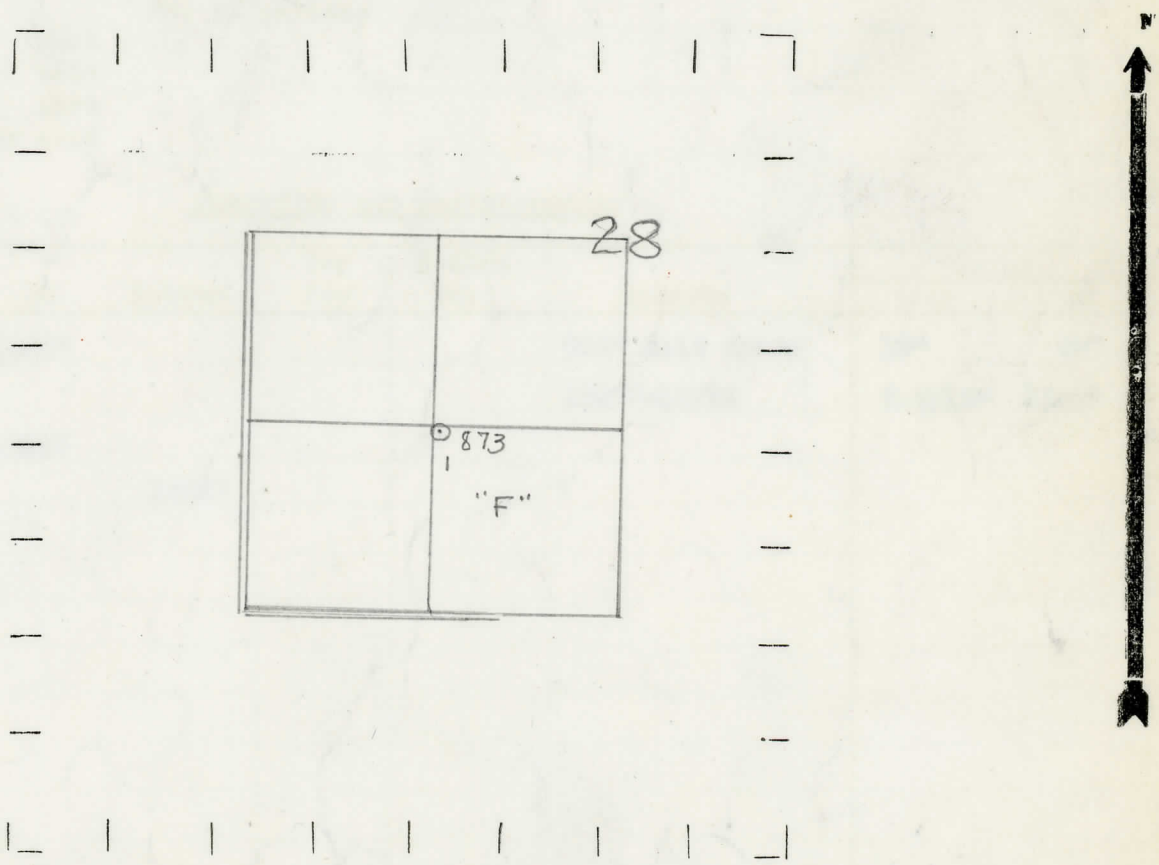

REMARKS:

SIGNED

W

Superintendent or Foreman.

Michigan Producing Division

Date November 13, 1940

No. 873

State Mich. County Isabella
(Serial No.)

Distr

Twp. Wise

Sec. 28 Twp. 16 N Rge. 3 W

Well No. F-1 (County No.) 873

Farm Gas Well Unit

Acres

Operator Cities Service Oil Co.

Information secured from

By

Scouting Dept.

Date well started 10-28-40

Dated well completed 11-2-40

Elevation 762.5

PRODUCTION RECORD

1st 24 hours natural Dry Hole

2nd 24 hours natural

Date of shot No. of quarts From to From to

Date of acid No. of gallons

1st 24 hours after acid shot

2nd 24 hours after acid shot

FORMATION AND CASING RECORD

Formation	Top	Bottom	Top Pay	Bottom Pay	Remarks	Casing	
						Size	Set at
Michigan Stray	1265'				900' salt water 1267'-1272'	10"	43'
Marshall	1316'					5-3/16"	1265'
Total Depth		1322'					

Remarks

Signed Dean C. Shackelford