



Western Michigan University
ScholarWorks at WMU

Legacy Scout Tickets from Pure Oil Company

8-20-2021

MGRRE_PureOilScoutTickets_Worden, P. B._1_21073079760000

MGRRE

Western Michigan University

Follow this and additional works at: <https://scholarworks.wmich.edu/pure>



Part of the Geology Commons

WMU ScholarWorks Citation

MGRRE, "MGRRE_PureOilScoutTickets_Worden, P. B._1_21073079760000" (2021). *Legacy Scout Tickets from Pure Oil Company*. 3557.

<https://scholarworks.wmich.edu/pure/3557>

This Document is brought to you for free and open access via ScholarWorks at WMU. It has been accepted for inclusion in Legacy Scout Tickets from Pure Oil Company by an authorized administrator of ScholarWorks at WMU. See the National Digital Catalogue - Science Base Catalogue for more collections submitted by MGRRE.



MGRRE_PureOilScoutTickets_Worden, P. B._1_21073079760000

API 21073079760000

Permit Number 7976

Lease Name Worden, P. B.

Well Number 1

County Isabella

Township 16N

Range 03W

Section 8

2021 DEQ or Pure co_name Ross, W. E.

Pure Number 877

Latitude 43.79658

Longitude -84.69167

877

DATE November 20, 1940

LOCATION REPORT

No.

STATE Michigan COUNTY Isabella DIST Wise TWP Wise SEC 88 TOWN 16 N RANGE 3 W
WELL No. 1 (SERIAL No. 877) FARM P. B. Worden ACRES

NAME OF STREAM OR WATERS _____ QUADRANGLE NW 1/4 SE 1/4 NE

OPERATOR W. E. Ross Map Wise Township, Isabella County

Feet from North Line of Farm

W. E. Ross

Sp 11-19-40

Wise - Isabella

1220 1220 " " East " " "

1220 1220 " " South " " "

" " West " " "

Feet from North Line of Section

1220 1220 " " East " 1/4

1220 1220 " " South " " "

" " West " " "

LEGEND

○ LOCATION

⊕ RIG

⊕ DRILLING

☀ GAS WELL

● OIL WELL

● SMALL OIL WELL

⊖ DRY HOLE

● DRY SHOWING OIL

☀ DRY SHOWING GAS

⊖ ABANDONED LOCATION

☀ ABANDONED GAS WELL

● ABANDONED OIL WELL

NOTE: Below make tracing from map, (when no map is obtainable make sketch) showing farm, center of section, this location with measurements and also wells, dry holes, or other locations in the vicinity of this location.

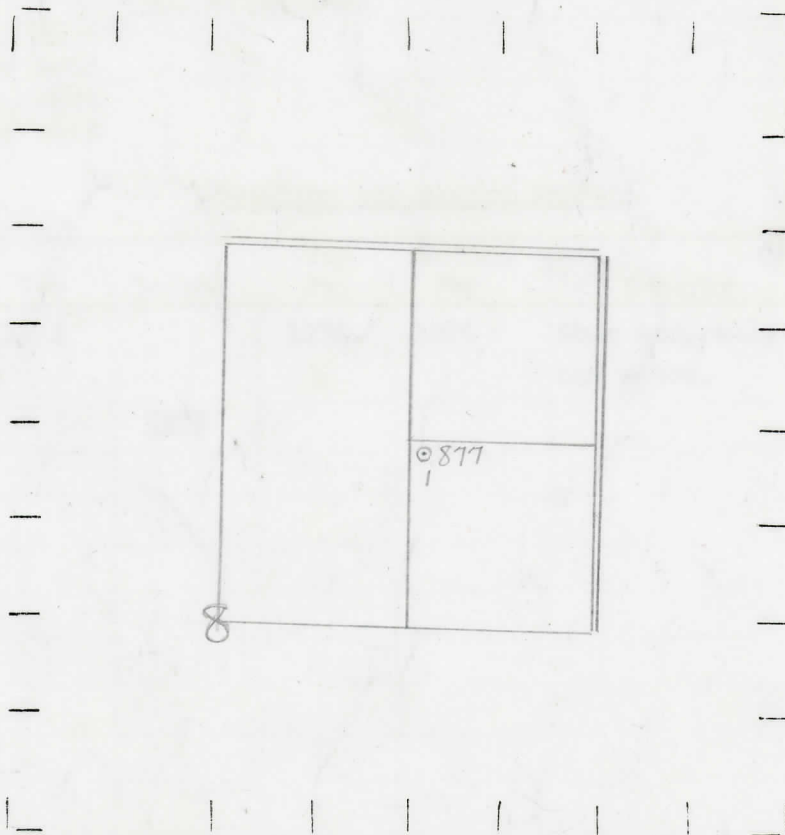

REMARKS:

SIGNED

W

Superintendent or Foreman.

