



Western Michigan University
ScholarWorks at WMU

Legacy Scout Tickets from Pure Oil Company

8-20-2021

MGRRE_PureOilScoutTickets_Ball, Clarence_1_21073083370000

MGRRE

Western Michigan University

Follow this and additional works at: <https://scholarworks.wmich.edu/pure>



Part of the Geology Commons

WMU ScholarWorks Citation

MGRRE, "MGRRE_PureOilScoutTickets_Ball, Clarence_1_21073083370000" (2021). *Legacy Scout Tickets from Pure Oil Company*. 3564.

<https://scholarworks.wmich.edu/pure/3564>

This Document is brought to you for free and open access via ScholarWorks at WMU. It has been accepted for inclusion in Legacy Scout Tickets from Pure Oil Company by an authorized administrator of ScholarWorks at WMU. See the National Digital Catalogue - Science Base Catalogue for more collections submitted by MGRRE.



MGRRE_PureOilScoutTickets_Ball, Clarence_1_21073083370000

API 21073083370000

Permit Number 8337

Lease Name Ball, Clarence

Well Number 1

County Isabella

Township 14N

Range 04W

Section 29

2021 DEQ or Pure co_name White, Burks

Pure Number 884

Latitude 43.57331

Longitude -84.8111

8.84

DATE January 8, 1941

LOCATION REPORT

No.

STATE Michigan

COUNTY Isabella

DIST Union

SEC 29

TOWN 14 N

14 N

4 W

WELL No. 1 (SERIAL No. 884) FARM

PREM Clarence Ball

29

14 N

RANGE 4 W

ACRES

NAME OF STREAM OR WATERS

QUADRANGLE

C W 1/2 NE SE

OPERATOR Burks White

Map Union Township, Isabella County

660 660 Feet from North Line of Farm

990 990 " " East " " "

660 660 " " South " " "

" " West " " "

660 660 Feet from North Line of Section 1/4 NE

990 990 " " East " " "

" " South " " "

" " West " " "

LEGEND

○ LOCATION

⊙ DRY HOLE

⊕ RIG

● DRY SHOWING OIL

⊕ DRILLING

⊙ DRY SHOWING GAS

☀ GAS WELL

⊙ ABANDONED LOCATION

● OIL WELL

☀ ABANDONED GAS WELL

● SMALL OIL WELL

● ABANDONED OIL WELL

NOTE: Below make tracing from map. (when no map is obtainable make sketch) showing farm, center of section, this location with measurements and also wells, dry holes, or other locations in the vicinity of this location.

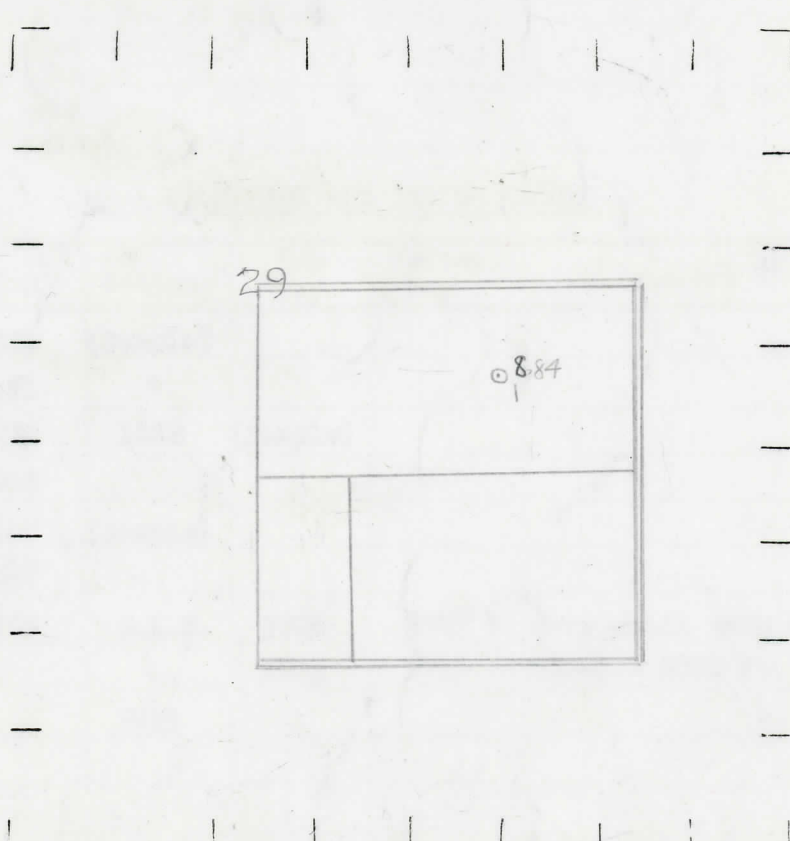

REMARKS:

SIGNED

W

Superintendent or Foreman.

Date **March 5, 1941** No. **884**
 State **Mich.** County **Isabella** ~~Dixie~~ Twp. **Union** Sec. **29** Twp. **14 N** Rge. **4 W**
 Well No. **1** (~~XXXXXXXXXX~~) **884** Farm **Clarence Ball** Acres _____
 Operator **Burks White** By **Scouting Department**
 Information secured ~~XXXX~~ **Scouting Department**
 Date well started **1-16-41** Date well completed **3-3-41** Elevation **833.6**

PRODUCTION RECORD

1st 24 hours natural **Dry Hole**
 2nd 24 hours natural _____
 Date of shot _____ No. of quarts _____ From _____ to _____ From _____ to _____
 Date of acid _____ No. of gallons _____
 1st 24 hours after acid shot _____
 2nd 24 hours after acid shot _____

FORMATION AND CASING RECORD

Formation	Top	Bottom	Top Pay	Bottom Pay	Remarks	Casing	
						Size	Set at
Stray	1381	(Sample)				10"	487
Marshall	1451	"				8-1/4"	1012
Red Rock	1470	1622	(Sample)			6-5/8"	1584
Sunbury	2609						
Antrim	2647	(Sample)					
Traverse Lime	3117						
Dundee	3703	S.L.M.	3706	3707 ?	Very small show oil.		
			3709	3713	Water - 2700 ft.		
Total Depth		3713					

Remarks **2705' C.T.M. equals 2707' S.L.M.**

Signed **D. C. Shackelford**