



Western Michigan University
ScholarWorks at WMU

Legacy Scout Tickets from Pure Oil Company

8-20-2021

MGRRE_PureOilScoutTickets_Reakes, Ed._2_21073084480000

MGRRE

Western Michigan University

Follow this and additional works at: <https://scholarworks.wmich.edu/pure>



Part of the Geology Commons

WMU ScholarWorks Citation

MGRRE, "MGRRE_PureOilScoutTickets_Reakes, Ed._2_21073084480000" (2021). *Legacy Scout Tickets from Pure Oil Company*. 3568.

<https://scholarworks.wmich.edu/pure/3568>

This Document is brought to you for free and open access via ScholarWorks at WMU. It has been accepted for inclusion in Legacy Scout Tickets from Pure Oil Company by an authorized administrator of ScholarWorks at WMU. See the National Digital Catalogue - Science Base Catalogue for more collections submitted by MGRRE.



MGRRE_PureOilScoutTickets_Reakes, Ed._2_21073084480000

API 21073084480000

Permit Number 8448

Lease Name Reakes, Ed.

Well Number 2

County Isabella

Township 16N

Range 04W

Section 15

2021 DEQ or Pure co_name McIntosh, J .W.

Pure Number 888

Latitude 43.77917

Longitude -84.78706

THE PURE OIL COMPANY

DATE February 28, 1941

LOCATION REPORT

No. 888

STATE Michigan COUNTY Isabella DIST. Vernon TWP. Vernon SEC. 15 TOWN 16 N RANGE 4 W
 WELL No. 2 (SERIAL No. 888) FARM Ed. Reakes ACRES

NAME OF STREAM OR WATERS QUADRANGLE SW SW NW
 OPERATOR J. W. McIntosh Map Vernon Township, Isabella County

Feet from North Line of Farm
 990 990 " " East " " "
 330 330 " " South " " "
 " " West " " "
 Feet from North Line of Section
 " " East " " "
 330 330 " " South " 1/4 "
 330 330 " " West " 1/4 "

LEGEND

- LOCATION
- ⊕ RIG
- ⊕ DRILLING
- ☀ GAS WELL
- OIL WELL
- ⊕ SMALL OIL WELL
- ⊕ DRY HOLE
- ⊕ DRY SHOWING OIL
- ⊕ DRY SHOWING GAS
- ⊕ ABANDONED LOCATION
- ☀ ABANDONED GAS WELL
- ⊕ ABANDONED OIL WELL

NOTE: Below make tracing from map. (when no map is obtainable make sketch) showing farm, center of section, this location with measurements and also wells, dry holes, or other locations in the vicinity of this location.

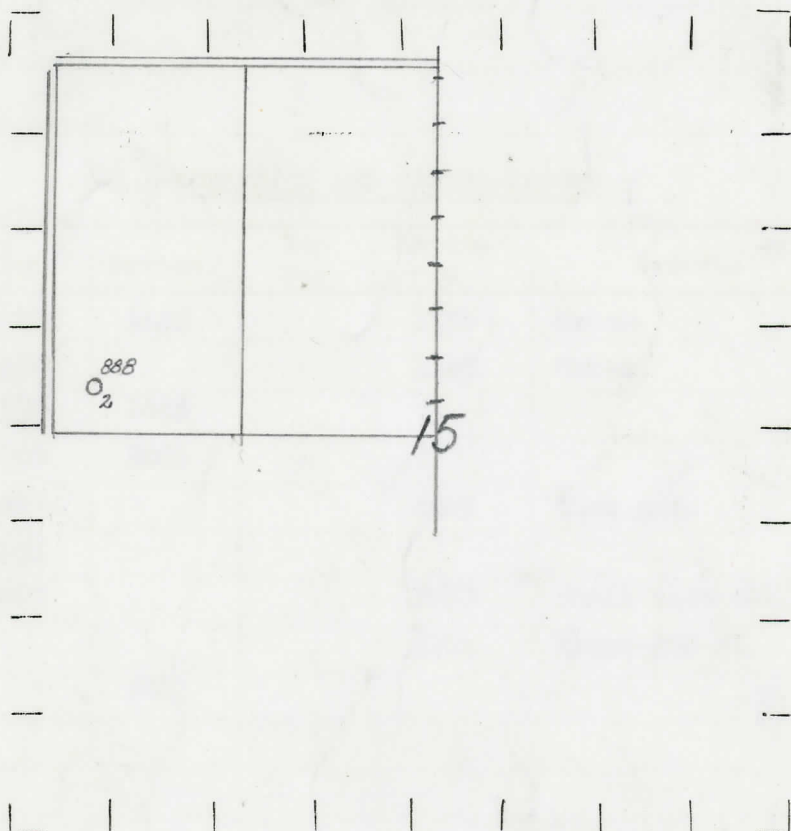

REMARKS:

SIGNED

Subintendent or Foreman.

Michigan Producing Division

Date **April 23, 1941** No. **888**
 State **Mich.** County **Isabella** District **Vernon** Sec. **15** Twp. **16 N** Rge. **4 W**
 Well No. **2** (Serial No.) **888** Farm **Ed. Reakes** Acres
 Operator **J. W. McIntosh** Information secured from **Scouting Department**
 Date well started **3-1-41** Date well completed **4-15-41** Elevation **855.1**

PRODUCTION RECORD

1st 24 hours natural **Dry Hole**
 2nd 24 hours natural
 Date of shot No. of quarts From to From to
 Date of acid No. of gallons
 shot
 1st 24 hours after acid
 shot
 2nd 24 hours after acid

FORMATION AND CASING RECORD

Formation	Top	Bottom	Top Pay	Bottom Pay	Remarks	Casing	
						Size	Set at
Stray	1420	1455		1430	Water.	10"	468
Marshall	1478			1480	Water.	8-1/4"	1060
Red Rock	1578	1665				6-5/8"	1690
Berea	2600	2605				5-3/16"	3772
Antrim	2605			2625	Show gas.		
Traverse Lime	3155						
Dundee	3805			3812	Small show oil.		
				3814	Water-500 ft.		
Total Depth		3817					

Remarks **1978' C.T.M. equals 1968' S.O.M.**

Signed **D. C. Shackelford**