



Western Michigan University
ScholarWorks at WMU

Legacy Scout Tickets from Pure Oil Company

8-20-2021

MGRRE_PureOilScoutTickets_Morey_1_21073089800000

MGRRE

Western Michigan University

Follow this and additional works at: <https://scholarworks.wmich.edu/pure>



Part of the Geology Commons

WMU ScholarWorks Citation

MGRRE, "MGRRE_PureOilScoutTickets_Morey_1_21073089800000" (2021). *Legacy Scout Tickets from Pure Oil Company*. 3595.

<https://scholarworks.wmich.edu/pure/3595>

This Document is brought to you for free and open access via ScholarWorks at WMU. It has been accepted for inclusion in Legacy Scout Tickets from Pure Oil Company by an authorized administrator of ScholarWorks at WMU. See the National Digital Catalogue - Science Base Catalogue for more collections submitted by MGRRE.



MGRRE_PureOilScoutTickets_Morey_1_21073089800000

API 21073089800000

Permit Number 8980

Lease Name Morey

Well Number 1

County Isabella

Township 13N

Range 05W

Section 28

2021 DEQ or Pure co_name Belvidere Oil Company

Pure Number 915

Latitude 43.4922

Longitude -84.92553

THE PURE OIL COMPANY

DATE September 24, 1941

LOCATION REPORT

No. 915

STATE Michigan

COUNTY Isabella

DIST. Fremont

TWP. Fremont

SEC. 288

TOWN 13 N

RANGE 5 W

WELL No. 1 (SERIAL No. 915) FARM

ACRES

NAME OF STREAM OR WATERS

QUADRANGLE SW NW NW NW-NW

OPERATOR The Belvidere Oil Company

Map Fremont Township, Isabella County

1270 1270 Feet from North Line of Farm

1270 1270 " " East " " "

" " South " " "

" " West " " "

1270 1270 Feet from North Line of Section 1/4 1/4

" " East " " "

" " South " " "

50 50 " " West " " "

Fremont - Isabella

Sp 9-22-41

LEGEND

- LOCATION
- ⊕ RIG
- ⊕ DRILLING
- ☀ GAS WELL
- OIL WELL
- SMALL OIL WELL
- ⊖ DRY HOLE
- ◆ DRY SHOWING OIL
- ☀ DRY SHOWING GAS
- ⊖ ABANDONED LOCATION
- ☀ ABANDONED GAS WELL
- ABANDONED OIL WELL

NOTE: Below make tracing from map, (when no map is obtainable make sketch) showing farm, center of section, this location with measurements and also wells, dry holes, or other locations in the vicinity of this location.

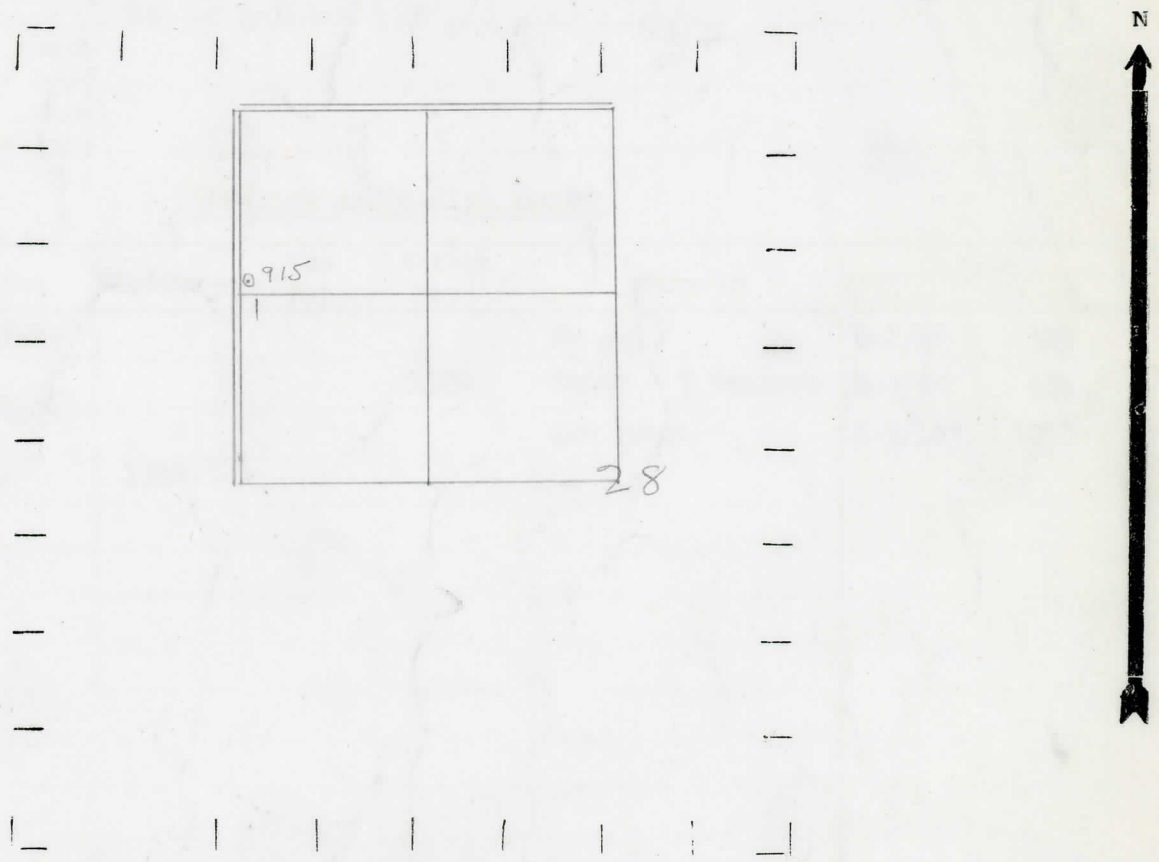

REMARKS:

.....
.....
.....

SIGNED

W

Superintendent or Foreman.

g

