



Western Michigan University
ScholarWorks at WMU

Legacy Scout Tickets from Pure Oil Company

8-20-2021

**MGRRE_PureOilScoutTickets_Rhode-Kruger
Comm._1_21073090710000**

MGRRE
Western Michigan University

Follow this and additional works at: <https://scholarworks.wmich.edu/pure>



Part of the Geology Commons

WMU ScholarWorks Citation

MGRRE, "MGRRE_PureOilScoutTickets_Rhode-Kruger Comm._1_21073090710000" (2021). *Legacy Scout Tickets from Pure Oil Company*. 3598.
<https://scholarworks.wmich.edu/pure/3598>

This Document is brought to you for free and open access via ScholarWorks at WMU. It has been accepted for inclusion in Legacy Scout Tickets from Pure Oil Company by an authorized administrator of ScholarWorks at WMU. See the National Digital Catalogue - Science Base Catalogue for more collections submitted by MGRRE.



MGRRE_PureOilScoutTickets_Rhode-Kruger Comm._1_21073090710000

API 21073090710000

Permit Number 9071

Lease Name Rhode-Kruger Comm.

Well Number 1

County Isabella

Township 14N

Range 05W

Section 7

2021 DEQ or Pure co_name Twin Drilling Company

Pure Number 918

Latitude 43.61421

Longitude -84.96723

THE PURE OIL COMPANY

DATE 10-15-41

COMPLETION RECORD OF WELLS DRILLED BY OTHER OPERATORS

LOCATION REPORT

No. 918

STATE Michigan COUNTY Isabella TWP Deerfield SEC. 7 TOWN 14 N RANGE 5 W

WELL No. 1 (SERIAL No. 918) FARM Rhode-Kruger (Comm.) ACRES

NAME OF STREAM OR WATERS QUADRANGLE NW SW SW

OPERATOR Twin Drilling Company Map Deerfield Township, Isabella County

Feet from North Line of Farm

1270 " " East " " "

1270 " " South " " "

Feet from North Line of Section

" " East " " "

1270 " " South " 1/4 "

50 " " West " " "

LEGEND

- LOCATION
- ⊕ RIG
- ⊕ DRILLING
- ☀ GAS WELL
- OIL WELL
- ⊕ SMALL OIL WELL
- ⊕ DRY HOLE
- ⊕ DRY SHOWING OIL
- ⊕ DRY SHOWING GAS
- ⊕ ABANDONED LOCATION
- ☀ ABANDONED GAS WELL
- ⊕ ABANDONED OIL WELL

NOTE: Below make tracing from map, (when no map is obtainable make sketch) showing farm, center of section, this location with measurements and also wells, dry holes, or other locations in the vicinity of this location.

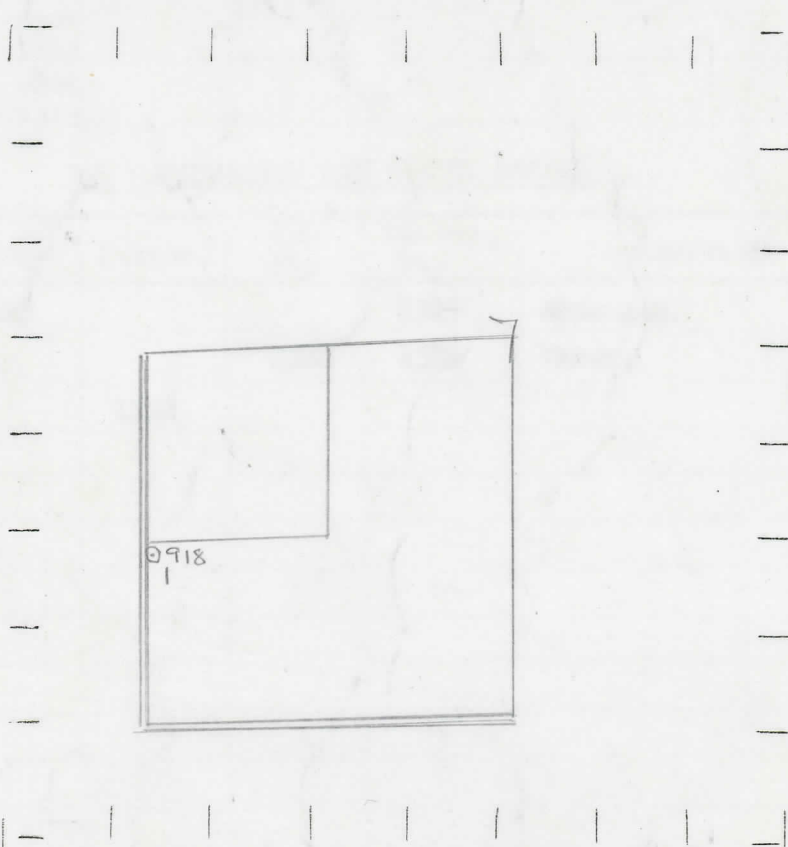

REMARKS:

.....
.....
.....

SIGNED

W

Superintendent or Foreman.

[Handwritten signature]

