



Western Michigan University
ScholarWorks at WMU

Legacy Scout Tickets from Pure Oil Company

8-20-2021

**MGRRE_PureOilScoutTickets_Cummings,
John_6_21073110940000**

MGRRE
Western Michigan University

Follow this and additional works at: <https://scholarworks.wmich.edu/pure>



Part of the Geology Commons

WMU ScholarWorks Citation

MGRRE, "MGRRE_PureOilScoutTickets_Cummings, John_6_21073110940000" (2021). *Legacy Scout Tickets from Pure Oil Company*. 3650.
<https://scholarworks.wmich.edu/pure/3650>

This Document is brought to you for free and open access via ScholarWorks at WMU. It has been accepted for inclusion in Legacy Scout Tickets from Pure Oil Company by an authorized administrator of ScholarWorks at WMU. See the National Digital Catalogue - Science Base Catalogue for more collections submitted by MGRRE.



MGRRE_PureOilScoutTickets_Cummings, John_6_21073110940000

API 21073110940000

Permit Number 11094

Lease Name Cummings, John

Well Number 6

County Isabella

Township 16N

Range 06W

Section 32

2021 DEQ or Pure co_name Mar A Lee Ltd Donald Izatt

Pure Number 970

Latitude 43.73638

Longitude -85.0504

THE PURE OIL COMPANY

LOCATION REPORT

Date October 4, 1944 A.F.E. No. _____
 Division Mich. Producing District _____ Lease John Cummings
John Cummings
 Acres _____ Lease No. _____ Elevation _____ Well No. 6 (Serial No. 970)
 Quadrangle C N 1/2 SE NE Sec. 32 Twp. 16 N Rge. 6 W Twp. Coldwater
Coldwater
 Survey _____ County Isabella State Michigan
 Operator Sohio Petroleum Company Map Coldwater Twp. Isabella Co.

		Feet from North Line of Lease	
		" " East " " "	
<u>990</u>	<u>990</u>	" " South " " "	
<u>660</u>	<u>660</u>	" " West " " "	
		Feet from North Line of Section	
		" " East " <u>1/4</u>	
<u>660</u>	<u>660</u>	" " South " " "	
<u>990</u>	<u>990</u>	" " West " " "	

LEGEND

- Location
- ☀ Gas Well
- Oil Well
- ☀ Gas - Distillate Well
- ∅ or ○ Dry Hole
- Dry Showing Oil
- ☀ Dry Showing Gas
- ⊗ Abandoned Location
- ☀ or ☀ Abandoned Gas Well
- or ● Abandoned Oil Well
- or ○ Input Well

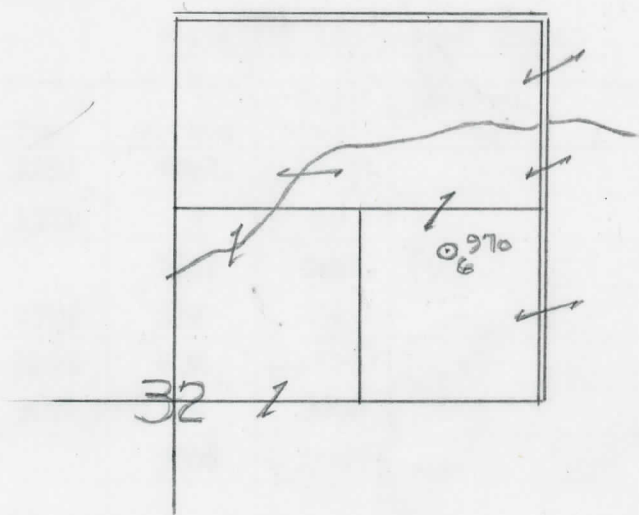

Scale _____

Remarks: _____

Submitted by RN Civil Engineer Approved by _____ Division Manager
 Approved by _____ Vice-President - General Manager

COMPLETION RECORD OF WELLS DRILLED BY OTHER OPERATORS

Michigan Producing Division

Date November 22, 1944 No. 970
State Mich. County Isabella Twp. Coldwater Sec. 32 Twp. 16 N Rge. 6 W
Well No. 6 (Serial No.) 970 Farm John Cummings Acres
Operator Sohio Petroleum Company Information secured By Scouting Department
Date well started 10-7-44 Date well completed 11-18-44 Elevation 971.2

PRODUCTION BOARD

12
1st 24 hours natural 430 Barrels (Pinched thru casing)
2nd 24 hours natural
Date of shot No. of quarts From To From to
Date of acid No. of gallons
1st 24 hours after acid shot
2nd 24 hours after acid shot

FORMATION AND CASING RECORD

Formation	Top	Bottom	Top Pay	Bottom Pay	Remarks	Casing	
						Size	Set at
Brown Dolomite	1257	Schl.	(-286)			10"	490
Mich. Stray	1371	"	(-401)			6-5/8"	1677
Marshall B.		1667	Schl.	(-696)		5-3/16"	3689
Sunbury	2513	CTM	(-1542)				
Traverse Lime	3102	SOM	(-2131)				
Dundee	3696	SIM	3698	(-2727)			
Total Depth		3706	(-2735)				

Remarks 3139' equals 3141' SOM; 3158' equals 3161' SIM

Signed D. C. Shackelford