



Western Michigan University  
ScholarWorks at WMU

---

Legacy Scout Tickets from Pure Oil Company

---

8-20-2021

## MGRRE\_PureOilScoutTickets\_Fitzpatrick, James Estate\_3\_21073111460000

MGRRE

*Western Michigan University*

Follow this and additional works at: <https://scholarworks.wmich.edu/pure>



Part of the Geology Commons

---

### WMU ScholarWorks Citation

MGRRE, "MGRRE\_PureOilScoutTickets\_Fitzpatrick, James Estate\_3\_21073111460000" (2021). *Legacy Scout Tickets from Pure Oil Company*. 3655.  
<https://scholarworks.wmich.edu/pure/3655>

This Document is brought to you for free and open access via ScholarWorks at WMU. It has been accepted for inclusion in Legacy Scout Tickets from Pure Oil Company by an authorized administrator of ScholarWorks at WMU. See the National Digital Catalogue - Science Base Catalogue for more collections submitted by MGRRE.



---

**MGRRE\_PureOilScoutTickets\_Fitzpatrick, James Estate\_3\_21073111460000**

API 21073111460000

Permit Number 11146

Lease Name Fitzpatrick, James Estate

Well Number 3

County Isabella

Township 15N

Range 04W

Section 12

2021 DEQ or Pure co\_name Summit Petroleum Corporation

Pure Number 975

Latitude 43.7076398

Longitude -84.7453897

# THE PURE OIL COMPANY LOCATION REPORT

Date October 25, 1944

A.F.E. No. James Fitzpatrick Est.  
James Fitzpatrick Est.

Division Michigan Producing District \_\_\_\_\_ Lease \_\_\_\_\_

Acres \_\_\_\_\_ Lease No. \_\_\_\_\_ Elevation \_\_\_\_\_ Well No. 3 (Serial No. 975)

Quadrangle C SW NW Sec. 12 Twp. 15 N Rge. 4 W **Disc** Isabella

Survey \_\_\_\_\_ County Isabella State Michigan

Operator The Chartiers Oil Co. Map Isabella Twp. - Isabella Co.  
Isabella Township, Isabella County

_____	Feet from North Line of Lease
_____	" " East " " "
<u>660 660</u>	" " South " " "
<u>660 660</u>	" " West " " "
_____	Feet from North Line of Section
_____	" " East " " "
<u>660 660</u>	" " South " " "
<u>660 660</u>	" " West " " "

### LEGEND

- Location
- ☀ Gas Well
- Oil Well
- ☀ Gas - Distillate Well
- ∅ or ○ Dry Hole
- Dry Showing Oil
- ☀ Dry Showing Gas
- ⊗ Abandoned Location
- ☀ or ⊗ Abandoned Gas Well
- or ⊗ Abandoned Oil Well
- or ○ Input Well

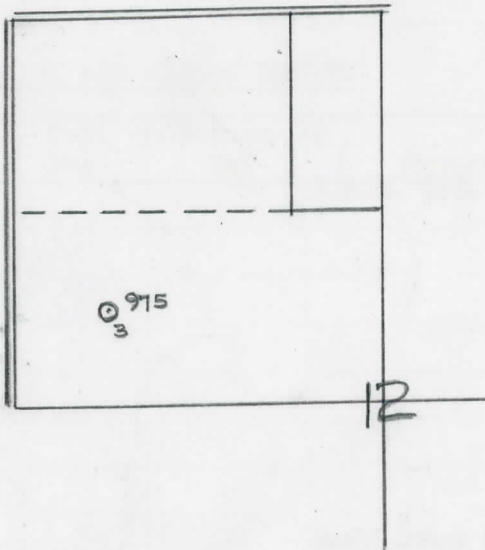

Scale \_\_\_\_\_

Remarks: \_\_\_\_\_  
\_\_\_\_\_  
\_\_\_\_\_

Submitted by RN \_\_\_\_\_  
Civil Engineer

Approved by \_\_\_\_\_  
Division Manager

Approved by \_\_\_\_\_  
Vice-President - General Manager

THE PURE OIL COMPANY

The Pure Oil Company

COMPLETION RECORD OF WELLS DRILLED BY OTHER OPERATORS

Michigan Producing Division

Date January 17, 1945 No. 975  
 State Mich. County Isabella ~~xxxxxx~~ Twp. Isabella Sec. 12 Twp. 15 N Rge. 4 W  
 Well No. 3 (Serial No.) ~~xxxxxxx~~ (County No.) 975 Farm James Fitzpatrick Acres \_\_\_\_\_  
 Operator The Chartiers Oil Company Information secured ~~from~~ <sup>By</sup> Scouting Department  
 Date well started 11-7-45 Date well completed 1-8-45 Elevation 769.9

PRODUCTION BOARD

12  
 1st ~~24~~ hours natural Filled up 1000 ft.  
 2nd 24 hours natural \_\_\_\_\_  
 Date of shot \_\_\_\_\_ No. of quarts \_\_\_\_\_ From \_\_\_\_\_ to \_\_\_\_\_ From \_\_\_\_\_ to \_\_\_\_\_  
 Date of acid 1-10-45 No. of gallons 1000  
 1st 24 hours after acid 125 Barrels (Flowed)  
 shot \_\_\_\_\_  
 2nd 24 hours after acid \_\_\_\_\_

FORMATION AND CASING RECORD

Formation	Top	Bottom	Top Pay	Bottom Pay	Remarks	Casing	
						Size	Set at
Brown Dolomite	1175	(-405)			H.F.W. 835. (-65)	10"	612
Mich. Stray	1292	(-522)				8-1/4"	800
Red Rock	1459	1555	(-689)			6-5/8"	1571
Sunbury	2505	(-1735)				5-3/16"	3665
Berea	2525	(-1755)					
Antrim	2533	(-1763)					
Traverse Lime	3012	(-2242)					
Dundee	3655	SLM	(-2885)		Small show oil and gas 3670-3674. (-2900)		
			3693 (-2923)	3704			
Total Depth		3709	(-2939)				

Remarks 3555' equals 3571' SLM; 3688' equals 3688' SLM.

Signed D. C. Shackelford