



Western Michigan University
ScholarWorks at WMU

Legacy Scout Tickets from Pure Oil Company

8-20-2021

MGRRE_PureOilScoutTickets_Spencer, A_1_21073112340000

MGRRE

Western Michigan University

Follow this and additional works at: <https://scholarworks.wmich.edu/pure>



Part of the Geology Commons

WMU ScholarWorks Citation

MGRRE, "MGRRE_PureOilScoutTickets_Spencer, A_1_21073112340000" (2021). *Legacy Scout Tickets from Pure Oil Company*. 3667.

<https://scholarworks.wmich.edu/pure/3667>

This Document is brought to you for free and open access via ScholarWorks at WMU. It has been accepted for inclusion in Legacy Scout Tickets from Pure Oil Company by an authorized administrator of ScholarWorks at WMU. See the National Digital Catalogue - Science Base Catalogue for more collections submitted by MGRRE.



MGRRE_PureOilScoutTickets_Spencer, A_1_21073112340000

API 21073112340000

Permit Number 11234

Lease Name Spencer, A

Well Number 1

County Isabella

Township 16N

Range 06W

Section 28

2021 DEQ or Pure co_name A N R Pipeline Company

Pure Number 987

Latitude 43.74723

Longitude -85.04562

THE PURE OIL COMPANY LOCATION REPORT

Date November 22, 1944 A.F.E. No. _____
 Division Mich. Producing District _____ Lease A. Spencer
 Acres _____ Lease No. _____ Elevation _____ Well No. 1 (Serial No. 987)
 Quadrangle C N $\frac{1}{2}$ NW SW Sec. 28 Twp. 16 N Rge. 6 W Dist. Coldwater
 Survey _____ County Isabella State Michigan
 Operator The Sohio Petroleum Co. Map Coldwater Twp - Isabella Co.

Feet from North Line of Lease	
990	990 " " East " " "
660	660 " " South " " "
330	330 " " West " " " <u>1/4</u>
Feet from North Line of Section	
660	660 " " East " " "
660	660 " " South " " "
660	660 " " West " " "

- LEGEND**
- Location
 - ☀ Gas Well
 - Oil Well
 - ☀ Gas - Distillate Well
 - ∅ or ○ Dry Hole
 - Dry Showing Oil
 - ☀ Dry Showing Gas
 - ⊗ Abandoned Location
 - ☀ or ⊗ Abandoned Gas Well
 - or ● Abandoned Oil Well
 - ⊗ or ⊗ Input Well

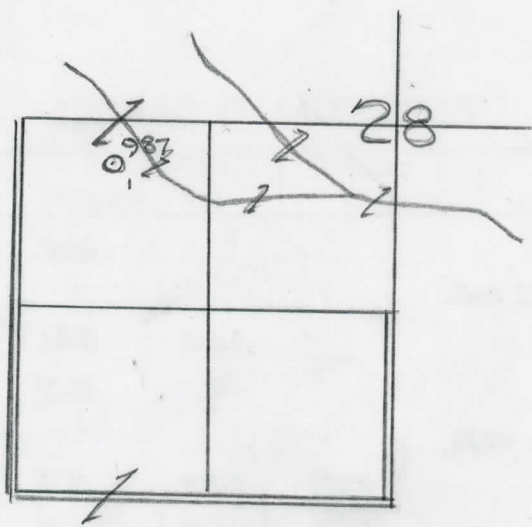

Remarks: _____ Scale _____

Submitted by RW Civil Engineer Approved by _____ Division Manager

Approved by _____ Vice-President - General Manager

THE PURE OIL COMPANY

The Pure Oil Company

COMPLETION RECORD OF WELLS DRILLED BY OTHER OPERATORS

Michigan Producing Division

Date **January 24, 1945** No. **987**
 State **Mich.** County **Isabella** Twp. **Coldwater** Sec. **28** Twp. **16 N** Rge. **6 W**
 (Serial No.)
 Well No. **1** (~~00000000~~) **987** Farm **A. Spencer** Acres
 Operator **Sohio Petroleum Company** Information secured ~~By~~ **Scouting Department**
 Date well started **11-27-44** Date well completed **1-13-45** Elevation **976.4**

PRODUCTION BOARD

1st 24 hours natural **240 Barrels (Pinched)**
 2nd 24 hours natural
 Date of shot No. of quarts From to From to
 Date of acid No. of gallons shot
 1st 24 hours after acid shot
 2nd 24 hours after acid shot

FORMATION AND CASING RECORD

Formation	Top	Bottom	Top Pay	Bottom Pay	Remarks	Casing	
						Size	Set at
Brown Dolomite	1265	Schl.	(-289)		(-403)	10"	250
Mich. Stray	1369	"	(-313)		Gas 1379-1402 Schl.	6-5/8"	1690
Marshall	1468 (-412)	1661	Schl.			5-3/16"	3692
Antrim	2515	3104	(-153)				
Traverse Line	3122	(-2146)		(-226)	Show gas 3195. (-219)		
Dundee	3699 (-273)	SLM.	3702	3709			
Traverse fm.	3104	(-2128)	3711 (-273)	3719			
Total Depth		3719	(-2743)				

Remarks

Signed **D. C. Shackelford**