



Western Michigan University
ScholarWorks at WMU

Legacy Scout Tickets from Pure Oil Company

8-20-2021

MGRRE_PureOilScoutTickets_Sisco, Walter_1_21073113210000

MGRRE

Western Michigan University

Follow this and additional works at: <https://scholarworks.wmich.edu/pure>



Part of the Geology Commons

WMU ScholarWorks Citation

MGRRE, "MGRRE_PureOilScoutTickets_Sisco, Walter_1_21073113210000" (2021). *Legacy Scout Tickets from Pure Oil Company*. 3675.

<https://scholarworks.wmich.edu/pure/3675>

This Document is brought to you for free and open access via ScholarWorks at WMU. It has been accepted for inclusion in Legacy Scout Tickets from Pure Oil Company by an authorized administrator of ScholarWorks at WMU. See the National Digital Catalogue - Science Base Catalogue for more collections submitted by MGRRE.



MGRRE_PureOilScoutTickets_Sisco, Walter_1_21073113210000

API 21073113210000

Permit Number 11321

Lease Name Sisco, Walter

Well Number 1

County Isabella

Township 16N

Range 06W

Section 33

2021 DEQ or Pure co_name Summit Petroleum Corporation

Pure Number 995

Latitude 43.7399595

Longitude -85.0357176

THE PURE OIL COMPANY

LOCATION REPORT

Date January 10, 1945 A.F.E. No. _____
 Division Mich. Producing District _____ Lease Walter Sisco Sisco
 Acres _____ Lease No. _____ Elevation _____ Well No. 1 (Serial No. 995)
 Quadrangle C N $\frac{1}{2}$ NW NE Sec. 33 Twp. 16 N Rge. 6 W ~~Disc~~ Coldwater Twp. Coldwater
 Survey _____ County Isabella State Michigan
 Operator Sohio Petroleum Company Map Coldwater Twp - Isabella Co

660	660	Feet from North Line of Lease
970	970	" " East " " "
660	660	" " South " " "
350	350	" " West " " "
		Feet from North Line of Section
		" " East " " "
		" " South " " "
660	660	" " West " " "

LEGEND

- Location
- ☀ Gas Well
- Oil Well
- ☀ Gas - Distillate Well
- ⊘ or ○ Dry Hole
- Dry Showing Oil
- ☀ Dry Showing Gas
- ⊘ Abandoned Location
- ☀ or ☀ Abandoned Gas Well
- or ● Abandoned Oil Well
- or ○ Input Well

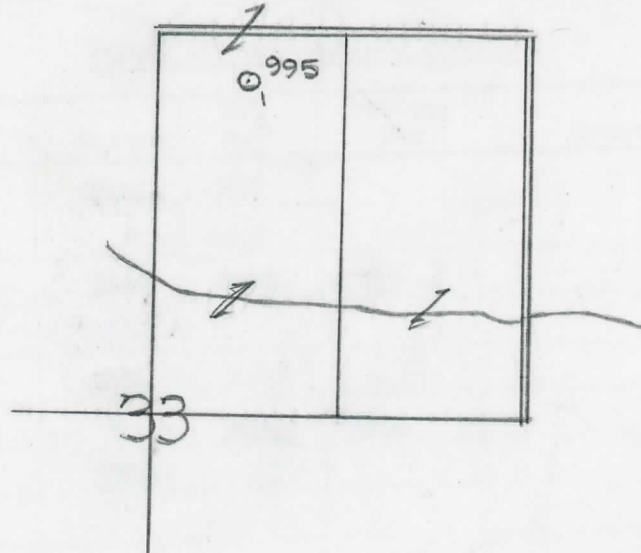

Remarks: _____

Scale _____

Submitted by ZN Civil Engineer Approved by _____ Division Manager
 Approved by _____ Vice-President - General Manager

The Pure Oil Company
COMPLETION RECORD OF WELLS DRILLED BY OTHER OPERATORS

Michigan Producing Division

Date **March 14, 1945** No. **995**
 State **Mich.** County **Isabella** ~~XXXXXX~~ Twp. **Coldwater** Sec. **33** Twp. **16 N** Rge. **6 W**
 Well No. **1** (Serial No.) ~~XXXXXX~~ Farm **Walter Sisco** Acres
 Operator **Sohio Petroleum Company** Information secured ~~XXXX~~ By **Scouting Department**
 Date well started **1-16-45** Date well completed **3-6-45** Elevation **967.6**

PRODUCTION BOARD

1st 24 hours natural **Est. 275 Barrels (Flowed)**
 2nd 24 hours natural
 Date of shot No. of quarts From to From to
 Date of acid No. of gallons
 1st 24 hours after acid shot
 2nd 24 hours after acid shot

FORMATION AND CASING RECORD

Formation	Top	Bottom	Top Pay	Bottom Pay	Remarks	Casing	
						Size	Set at
Brown Dolomite	1269	Schl.	(-301)			10"	480
Mich. Stray	1382	"	(-414)			6-5/8"	1681
Marshall	1463	1668	Schl.	(-495)		5-3/16"	3690
Sunbury	2520	(-1552)					
Traverse Lime	3118	SLM.	(-2150)	(-2725 1/2)			
Dundee (-2724)	3692	"	3693 1/2	3706			
Total Depth		3706	(-2738)				

Remarks **3169' eq. 3183' SLM; 3689' eq. 3690' SLM.**

Signed **D. C. Shackelford**