



Western Michigan University
ScholarWorks at WMU

Legacy Scout Tickets from Pure Oil Company

8-20-2021

**MGRRE_PureOilScoutTickets_Hoffman, Roy
C_1_21073113760000**

MGRRE
Western Michigan University

Follow this and additional works at: <https://scholarworks.wmich.edu/pure>



Part of the Geology Commons

WMU ScholarWorks Citation

MGRRE, "MGRRE_PureOilScoutTickets_Hoffman, Roy C_1_21073113760000" (2021). *Legacy Scout Tickets from Pure Oil Company*. 3681.
<https://scholarworks.wmich.edu/pure/3681>

This Document is brought to you for free and open access via ScholarWorks at WMU. It has been accepted for inclusion in Legacy Scout Tickets from Pure Oil Company by an authorized administrator of ScholarWorks at WMU. See the National Digital Catalogue - Science Base Catalogue for more collections submitted by MGRRE.



MGRRE_PureOilScoutTickets_Hoffman, Roy C_1_21073113760000

API 21073113760000

Permit Number 11376

Lease Name Hoffman, Roy C

Well Number 1

County Isabella

Township 16N

Range 06W

Section 29

2021 DEQ or Pure co_name A N R Pipeline Company

Pure Number 1001

Latitude 43.75432

Longitude -85.05078

THE PURE OIL COMPANY
LOCATION REPORT

Date February 21, 1945 A.F.E. No. _____
 Division Mich. Producing District _____ Lease Roy C. Hoffman
Roy C. Hoffman
 Acres _____ Lease No. _____ Elevation _____ Well No. 1 (Serial No. 1001)
 Quadrangle C N 1/2 NE NE Sec. 29 Twp. 16 N Rge. 6 W ~~Dist.~~ Coldwater
C N 1/2 NE NE ~~Dist.~~ Coldwater
 Survey _____ County Isabella State Michigan
 Operator Sohio Petroleum Co. Map Coldwater Twp - Isabella Co
Sohio Pet. Co. Coldwater Township, Isabella County

380 380 Feet from North Line of Lease
660 660 " " East " " "
 " " South " " "
 " " West " 1/4 "
380 380 Feet from North Line of Section
660 660 " " East " " "
 " " South " " "
 " " West " " "

LEGEND

- Location
- ☀ Gas Well
- Oil Well
- ☀ Gas - Distillate Well
- ∅ or ○ Dry Hole
- Dry Showing Oil
- ☀ Dry Showing Gas.
- ⊗ Abandoned Location
- ☀ or ☀ Abandoned Gas Well
- or ● Abandoned Oil Well
- or ○ Input Well

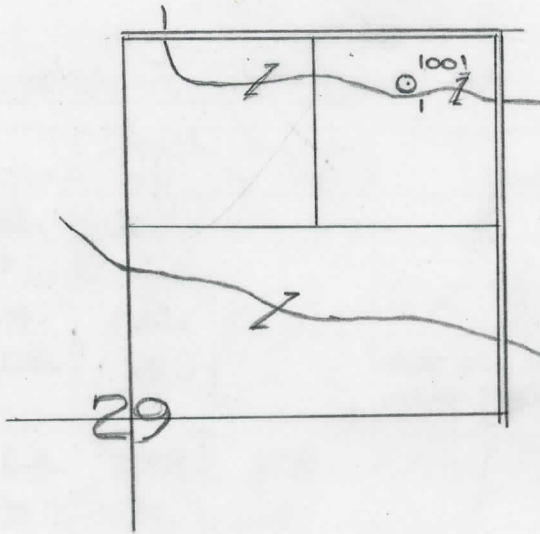

Scale _____

Remarks: _____

Submitted by RW _____ Approved by _____
 Civil Engineer Division Manager
 Approved by _____
 Vice-President - General Manager

The Pure Oil Company
 COMPLETION RECORD OF WELLS DRILLED BY OTHER OPERATORS

Michigan Producing Division

Date May 16, 1945 No. 1001
 State Mich. County Isabella ~~Block~~ Twp. Coldwater Sec. 29 Twp. 16 N Rge. 6 W
 Well No. 1 (~~County No.~~) 1001 Farm Roy C. Hoffman Acres
 Operator Sohio Petroleum Co. Information secured ~~Block~~ By Scouting Department
 Date well started 3-23-45 Date well completed 5-14-45 Elevation 981.1

PRODUCTION BOARD

1st 24 hours natural Est. Potential - 720 Barrels
 2nd 24 hours natural
 Date of shot No. of quarts From To From to
 Date of acid No. of gallons
 1st 24 hours after acid shot
 2nd 24 hours after acid shot

FORMATION AND CASING RECORD

Formation	Top	Bottom	Top Pay	Bottom Pay	Remarks	Casing	
						Size	Set at
Brown Dolomite	1286	Schl.	(-305)			10"	300
Mich. Stray	1396	"	(-45)			6-5/8"	1722
Marshall	(698)	1679	Schl.			5-3/16"	3723
Traverse Line	3133	S.L.M.	(-2152)		Show oil and salt water 3290-3295.	(-2309)	
Dundee	3723 (-2742)	S.L.M.	3725 1/2	3735	(-2744 1/2)		
Total Depth		3735	(-2754)				

Remarks At 3727 - 100 ft. oil in 2 hrs.; at 3730 - 2500 ft. oil in hole in 5 hrs.; at 3730 - flowed 111 bbls. in 12 hrs. - while drilling 3730-3733 1/2 flowed 92 bbls. in 4 hrs.; at 3735 - flowing 30 bbls. per hour
 3143' equals 3146' S.L.M.

Signed D. C. Shackelford