



Western Michigan University
ScholarWorks at WMU

Legacy Scout Tickets from Pure Oil Company

8-20-2021

MGRRE_PureOilScoutTickets_Bick, John_1_21073115700000

MGRRE

Western Michigan University

Follow this and additional works at: <https://scholarworks.wmich.edu/pure>



Part of the Geology Commons

WMU ScholarWorks Citation

MGRRE, "MGRRE_PureOilScoutTickets_Bick, John_1_21073115700000" (2021). *Legacy Scout Tickets from Pure Oil Company*. 3702.

<https://scholarworks.wmich.edu/pure/3702>

This Document is brought to you for free and open access via ScholarWorks at WMU. It has been accepted for inclusion in Legacy Scout Tickets from Pure Oil Company by an authorized administrator of ScholarWorks at WMU. See the National Digital Catalogue - Science Base Catalogue for more collections submitted by MGRRE.



MGRRE_PureOilScoutTickets_Bick, John_1_21073115700000

API 21073115700000

Permit Number 11570

Lease Name Bick, John

Well Number 1

County Isabella

Township 16N

Range 06W

Section 28

2021 DEQ or Pure co_name A N R Pipeline Company

Pure Number 1022

Latitude 43.75447

Longitude -85.04579

THE PURE OIL COMPANY

LOCATION REPORT

Date May 23, 1945

A.F.E. No. _____

Division Mich. Producing District _____

Lease John Bick Bick

Acres _____ Lease No. _____ Elevation _____ Well No. 1 (Serial No. 1022)

Quadrangle C N 1/2 NW NW Sec. 28 Twp. 16 N Rge. 6 W ~~XDist.~~ Coldwater ~~XDist.~~ Coldwater

Survey _____ County Isabella State Michigan

Operator Sohio Petroleum Co. Map Coldwater Twp - Isabella Co

330	330	Feet from North Line of Lease
_____	_____	" " East " " "
_____	_____	" " South " " "
660	660	" " West " <u>1/4</u> "
330	330	Feet from North Line of Section
_____	_____	" " East " " "
_____	_____	" " South " " "
660	660	" " West " " "

LEGEND

- Location
- ☉ Gas Well
- Oil Well
- ☉ Gas - Distillate Well
- ∅ or ○ Dry Hole
- or ○ Dry Showing Oil
- ☉ Dry Showing Gas
- ⊖ Abandoned Location
- ☉ or ☉ Abandoned Gas Well
- or ● Abandoned Oil Well
- or ○ Input Well

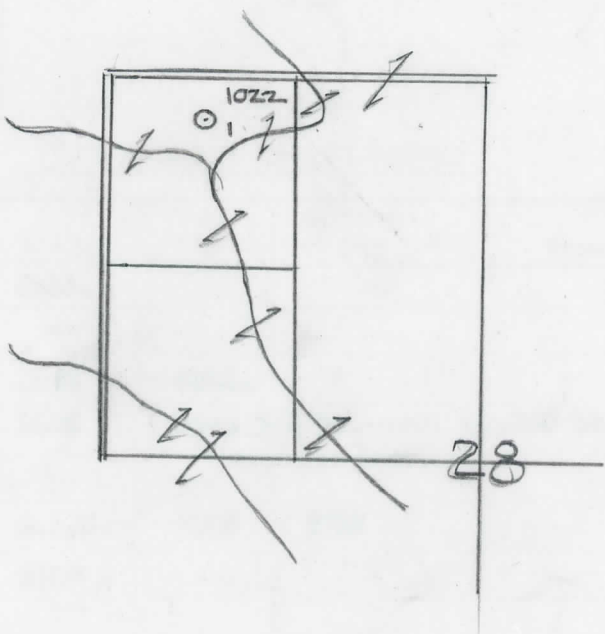

Scale _____

Remarks: _____

Submitted by RW Civil Engineer

Approved by _____ Division Manager

Approved by _____ Vice-President-General Manager

COMPLETION RECORD OF WELLS DRILLED BY OTHER OPERATORS

Michigan Producing Division

Date August 1, 1945 No. 1022
 State Mich. County Isabella ~~Dist.~~ Twp. Coldwater Sec. 28 Twp. 16 N Rge. 6 W
 Well No. 1 (Serial No.) 1022 Farm John Bick Acres _____
 Operator Sohio Petroleum Company Information secured ~~from~~ By Scouting Department
 Date well started 6-8-45 Date well completed 7-23-45 Elevation 975.9

PRODUCTION BOARD

1st 24 hours natural Flowed an est. 528 Bbls. pinched.
 2nd 24 hours natural _____
 Date of shot _____ No. of quarts _____ From _____ To _____ From _____ to _____
 Date of acid _____ No. of gallons _____
 1st 24 hours after acid shot _____
 2nd 24 hours after acid shot _____

FORMATION AND CASING RECORD

Formation	Top	Bottom	Top Pay	Bottom Pay	Remarks	Casing	
						Size	Set at
Brown Dolomite	1276	Schl.	(-300)			10"	464
Mich. Stray	1371	"	(-395)			6-5/8"	1718
Marshall	(-692)	1668	Schl.			5-3/16"	3707
D.S.T.	1375	1408	Open 3/4 hr.-rec. 44,000 cu. ft. gas			and 150 ft. mud.	
Traverse Lime	3131	(-2155)	(-1730)				
Dundee	3706	S.L.M.	3708	3720	(-2732)		
Total Depth		3720	(-2744)				

Remarks At 3718 - well flowed 181 bbls. in 9 hrs. thru casing.

Signed D. C. Shackelford