



Western Michigan University
ScholarWorks at WMU

Legacy Scout Tickets from Pure Oil Company

8-20-2021

**MGRRE_PureOilScoutTickets_McReavy, John
J_2_21073117210000**

MGRRE
Western Michigan University

Follow this and additional works at: <https://scholarworks.wmich.edu/pure>



Part of the Geology Commons

WMU ScholarWorks Citation

MGRRE, "MGRRE_PureOilScoutTickets_McReavy, John J_2_21073117210000" (2021). *Legacy Scout Tickets from Pure Oil Company*. 3717.
<https://scholarworks.wmich.edu/pure/3717>

This Document is brought to you for free and open access via ScholarWorks at WMU. It has been accepted for inclusion in Legacy Scout Tickets from Pure Oil Company by an authorized administrator of ScholarWorks at WMU. See the National Digital Catalogue - Science Base Catalogue for more collections submitted by MGRRE.



MGRRE_PureOilScoutTickets_McReavy, John J_2_21073117210000

API 21073117210000

Permit Number 11721

Lease Name McReavy, John J

Well Number 2

County Isabella

Township 15N

Range 04W

Section 12

2021 DEQ or Pure co_name Summit Petroleum Corporation

Pure Number 1037

Latitude 43.7041603

Longitude -84.7403936

THE PURE OIL COMPANY LOCATION REPORT

Date August 8, 1945 A.F.E. No. _____

Division Mich. Producing District _____ Lease John J. McReavy

Acres _____ Lease No. _____ Elevation _____ Well No. 2 (Serial No. 1037)

Quadrangle E¹/₂ NE SW Sec. 12 Twp. 15 N Rge. 4 W ^{BING}_{DISEX} Twp. Isabella

Survey _____ County Isabella State Michigan

Operator Wittmer Oil & Gas Corp. Map Isabella Township, Isabella County

<u>648</u>	Feet from North Line of Lease
<u>644</u>	" " East " " "
	" " South " " "
	" " West " " "
<u>648</u>	Feet from North Line of Section ^{1/4}
<u>644</u>	" " East " " "
	" " South " " "
	" " West " " "

LEGEND

- Location
- ☀ Gas Well
- Oil Well
- ☀ Gas -- Distillate Well
- ∅ or ○ Dry Hole
- Dry Showing Oil
- ☀ Dry Showing Gas
- ⊗ Abandoned Location
- ☀ or ⊗ Abandoned Gas Well
- or ● Abandoned Oil Well
- or ○ Input Well

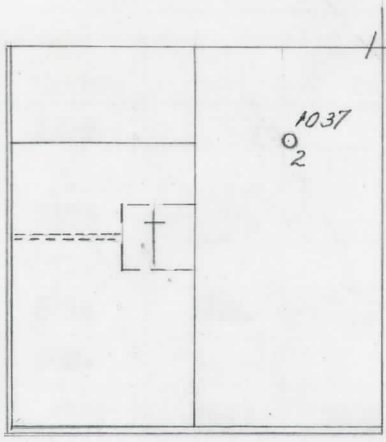

Scale _____

Remarks: _____

Submitted by _____ Civil Engineer Approved by _____ Division Manager

Approved by _____ Vice-President - General Manager

COMPLETION RECORD OF WELLS DRILLED BY OTHER OPERATORS

Michigan Producing Division

Date September 19, 1945 No. 1037
 State Michigan Co. Isabella Twp. Isabella Sec. 12 Twp. 15 N Rge. 4 W
 Well No. 2 Serial No. 1037 Farm John J. McKeavy Acres _____
 Operator Wittmer Oil & Gas Corp.
 Date started 7-27-45 Date completed 9-7-45 Elevation 766.1

PRODUCTION RECORD

1st 24 hours natural Flowed 16 Bbls.
 Date of shot _____ No. of quarts _____ From _____ To _____ From _____ to _____
 Date of acid 9-13-45 No. of gallons 1000
 1st 24 hours after acid Flowed 57 Bbls.
 Completed as: Oil Well Gas Well _____ Dry Hole _____

FORMATION AND CASING RECORD

Formation	Top	Bottom	Top Pay	Bottom Pay	Remarks	Casing	
						Size	Set at
<u>Mich. Stray</u>	<u>1295</u>	<u>1308</u>	<u>(-529)</u>		<u>Salt water 1295-1305. (-529)</u>	<u>10"</u>	<u>589</u>
<u>Marshall</u>	<u>1356</u>	<u>1535</u>	<u>(-590)</u>			<u>8-1/4"</u>	<u>951</u>
<u>Sunbury</u>	<u>2495</u>	<u>(-1929)</u>				<u>6-5/8"</u>	<u>1546</u>
<u>Antrim</u>	<u>?</u>	<u>3014</u>	<u>SLM. (-2248)</u>			<u>5-3/16"</u>	<u>3667</u>
<u>Traverse Lime</u>	<u>3032</u>	<u>SLM. (-2266)</u>					
<u>Dundee</u>	<u>3654</u>	<u>(-2888)</u>	<u>3693</u>	<u>3699</u>	<u>(-2927)</u>		
<u>Total Depth</u>		<u>3701 1/2</u>	<u>(-2935 1/2)</u>				

Remarks Production declined to 32 barrels on the fourth day after acid.
3080' equals 3104' SLM; 3673' equals 3672' SLM.

Signed D. C. Shackelford