



Western Michigan University
ScholarWorks at WMU

Legacy Scout Tickets from Pure Oil Company

8-20-2021

**MGRRE_PureOilScoutTickets_Vodicka, Joe et
al_1_21073118530000**

MGRRE

Western Michigan University

Follow this and additional works at: <https://scholarworks.wmich.edu/pure>



Part of the Geology Commons

WMU ScholarWorks Citation

MGRRE, "MGRRE_PureOilScoutTickets_Vodicka, Joe et al_1_21073118530000" (2021). *Legacy Scout Tickets from Pure Oil Company*. 3732.

<https://scholarworks.wmich.edu/pure/3732>

This Document is brought to you for free and open access via ScholarWorks at WMU. It has been accepted for inclusion in Legacy Scout Tickets from Pure Oil Company by an authorized administrator of ScholarWorks at WMU. See the National Digital Catalogue - Science Base Catalogue for more collections submitted by MGRRE.



MGRRE_PureOilScoutTickets_Vodicka, Joe et al_1_21073118530000

API 21073118530000

Permit Number 11853

Lease Name Vodicka, Joe et al

Well Number 1

County Isabella

Township 14N

Range 03W

Section 17

2021 DEQ or Pure co_name Sohio Petroleum Company

Pure Number 1052

Latitude 43.59817

Longitude -84.68911

THE PURE OIL COMPANY

LOCATION REPORT

Date October 3, 1945

A.F.E. No. _____

Division Mich. Producing District _____

Lease JOE VODICKA ET AL
Joe Vodicka, et al

Acres _____ Lease No. 17 Elevation _____ Well No. 1 (Serial No. 1052)

Quadrangle SE-SE-SE Sec. 17 Twp. 14 N Rge. 3 W Twp. CHIPPEWA

Survey _____ County Isabella State Michigan

Operator Sohio Petroleum Company Map Chippewa Township, Isabella County

Feet from North Line of Lease					
<u>330</u>	<u>330</u>	"	"	East	" " "
<u>330</u>	<u>330</u>	"	"	South	" " "
		"	"	West	" " "
Feet from North Line of Section					
<u>330</u>	<u>330</u>	"	"	East	" <u>1/4</u> "
<u>330</u>	<u>330</u>	"	"	South	" " "
		"	"	West	" " "

LEGEND

- Location
- ☀ Gas Well
- Oil Well
- ☀ Gas - Distillate Well
- or ○ Dry Hole
- Dry Showing Oil
- ☀ Dry Showing Gas
- ⊖ Abandoned Location
- ☀ or ☀ Abandoned Gas Well
- or ● Abandoned Oil Well
- or ○ Input Well

Handwritten notes:
 8 1725 waco
 7" sp. 9-24-45
 10" sp. 250
 7" sp. 1260
 7" sp. 1345
 7" sp. 1395
 7" sp. 1636

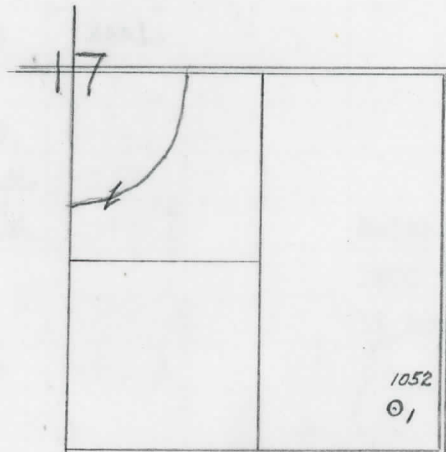

Scale _____

Remarks: _____

Submitted by _____
Civil Engineer

Approved by _____
Division Manager

Approved by _____
Vice-President - General Manager

Date October 3, 1942

LOCATION BELOW

SEE NO.

THE PURE OIL COMPANY

The Pure Oil Company

COMPLETION RECORD OF WELLS DRILLED BY OTHER OPERATORS

Michigan Producing Division

Date November 14, 1945 No. 1052

State Michigan Co. Isabella Twp. Chippewa Sec. 17 Twp. 14 N Rge. 3 W

Well No. 1 Serial No. 1052 Farm Joe Vodicka, et al Acres

Operator Sohio Petroleum Company

Date started 9-24-45 Date completed 11-11-45 Elevation 752.6

PRODUCTION RECORD

1st 24 hours natural

Date of shot No. of quarts From To From to

Date of acid shot No. of gallons

1st 24 hours after acid

Completed as: Oil Well Gas Well Dry Hole **X**

FORMATION AND CASING RECORD

Formation	Top	Bottom	Top Pay	Bottom Pay	Remarks	Casing	
						Size	Set at
Brown Dolomite	1265	Schl.	(-752)			10"	250
Mich. Stray	1395	"	(-642)			6-5/8"	1725
Marshall 1454	(-701)?	1636	Schl.			5-3/16"	3745
Coldw. Red Rock	2591	(-1838)					
Antrim	2680	3119	(-1927)				
Traverse Lime	3125	C.D.M.	(-2392)				
Dundee	3748	S.L.M.	(-2995)		Rainbow oil 3750-3756. (-2997)		
					1800 ft. S.W. in		
					12 hrs. 3800-3805. (-3042)		
Total Depth		3805	(-3052)				

Remarks 3039' equals 3056' C.D.M. (Cable Depthometer); 3734' eq. 3741' C.D.M.; 3741' C.D.M. eq./SLM. 3745'

Signed D. C. Shackelford