



Western Michigan University  
ScholarWorks at WMU

---

Legacy Scout Tickets from Pure Oil Company

---

8-20-2021

**MGRRE\_PureOilScoutTickets\_Lueder, Wm.\_1\_21073118640000**

MGRRE

*Western Michigan University*

Follow this and additional works at: <https://scholarworks.wmich.edu/pure>



Part of the Geology Commons

---

#### **WMU ScholarWorks Citation**

MGRRE, "MGRRE\_PureOilScoutTickets\_Lueder, Wm.\_1\_21073118640000" (2021). *Legacy Scout Tickets from Pure Oil Company*. 3736.

<https://scholarworks.wmich.edu/pure/3736>

This Document is brought to you for free and open access via ScholarWorks at WMU. It has been accepted for inclusion in Legacy Scout Tickets from Pure Oil Company by an authorized administrator of ScholarWorks at WMU. See the National Digital Catalogue - Science Base Catalogue for more collections submitted by MGRRE.



---

**MGRRE\_PureOilScoutTickets\_Lueder, Wm.\_1\_21073118640000**

API 21073118640000

Permit Number 11864

Lease Name Lueder, Wm.

Well Number 1

County Isabella

Township 14N

Range 06W

Section 13

2021 DEQ or Pure co\_name Wicklund, J. V. Development Company

Pure Number 1056

Latitude 43.60442

Longitude -84.98352

# THE PURE OIL COMPANY

## LOCATION REPORT

Date October 3, 1945

A.F.E. No. \_\_\_\_\_

Division Mich. Producing

District \_\_\_\_\_

Lease \_\_\_\_\_

WILLIAM LUEDER  
William Lueder

Acres \_\_\_\_\_ Lease No. \_\_\_\_\_

Elevation \_\_\_\_\_

Well No. 1

(Serial No. 1056)

Quadrangle SE-SW-NW

SE SW NW

Sec. 13

Twp. 14 N

Rge. 6 W

~~XBRX~~  
~~XBRX~~  
Twp. \_\_\_\_\_

BROOMFIELD  
Broomfield

Survey J. V. Wicklund Dev. Co.

County \_\_\_\_\_

ISABELLA  
Isabella

State Michigan

Operator J. V. Wicklund Development Co.

Map Broomfield Township, Isabella County

_____	_____	Feet from North Line of Lease
<u>330</u>	<u>330</u>	" " East " " "
<u>330</u>	<u>330</u>	" " South " " "
_____	_____	" " West " " "

_____	_____	Feet from North Line of Section
<u>330</u>	<u>330</u>	" " East " " "
<u>990</u>	<u>990</u>	" " South " <u>2/4</u> "
_____	_____	" " West " " "

### LEGEND

- Location
- ☀ Gas Well
- Oil Well
- ☀ Gas - Distillate Well
- ⊖ or ○ Dry Hole
- Dry Showing Oil
- ☀ Dry Showing Gas
- ⊖ Abandoned Location
- ☀ or ☀ Abandoned Gas Well
- or ● Abandoned Oil Well
- or ○ Input Well

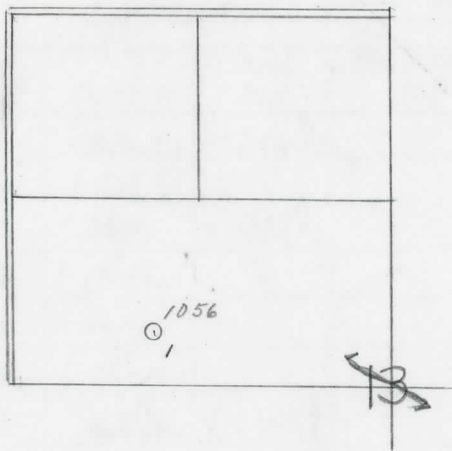

Scale \_\_\_\_\_

Remarks: \_\_\_\_\_  
\_\_\_\_\_  
\_\_\_\_\_

Submitted by \_\_\_\_\_  
Civil Engineer

Approved by \_\_\_\_\_  
Division Manager

Approved by \_\_\_\_\_  
Vice-President - General Manager

THE LOKE OIL COMPANY

COMPLETION RECORD OF WELLS DRILLED BY OTHER OPERATORS

W<sup>c</sup>

Michigan Producing Division

Date December 12, 1945 No. 1056

State Michigan Co. Isabella District Broomfield Twp. 13 Sec. 13 Twp. 14 N Rge. 6 W

Well No. 1 Serial No. 1056 Farm Wm. Lueder Acres

Operator J. V. Wicklund Development Company

Date started 10-10-45 Date completed 12-7-45 Elevation 1015.4

PRODUCTION RECORD

1st 24 hours natural

Date of shot No. of quarts From To From to

Date of acid shot No. of gallons

1st 24 hours after acid

Completed as: Oil Well Gas Well Dry Hole **X**

FORMATION AND CASING RECORD

Formation	Top	Bottom	Top Pay	Bottom Pay	Remarks	Casing	
						Size	Set at
Brown Dolomite	1321	S.L.M.	(-306)			10"	617
Mich. Stray	1400	(-385)				8-1/4"	835
Marshall	1423	1690	(-408)			6-5/8"	1706
Sunbury	2603	(-1588)				5-3/16"	3835
Berea	2616	(-1601)					
Antrim	2620	(-1605)					
Traverse Lime	3158	S.L.M.	(-2143)		Small show oil 3187-3203. (-2172)		
					Very small show oil and gas 3241. (-2226)		
Dundee	3733	S.L.M.	(-2718)		600 ft. salt water at 3824. (-2809)		
					Salt water 3848-3849. (-2833)		
Total Depth		3849	(-2834)				

Remarks 1470' CTM eq. 1466' SLM; 2629' CTM equals 2632' SLM; 3200' CTM equals 3203' SLM; 3741' CTM equals 3743' SLM.

2.29  
 3  
 6.87  
 20  
 1.85  
 9.35  
 5.22  
 4.13  
 1.69  
 5.07  
 1.3  
 5.22

Signed D. C. Shackelford